

Cadenas de Rodillos Giro Lateral / SERIE A - B

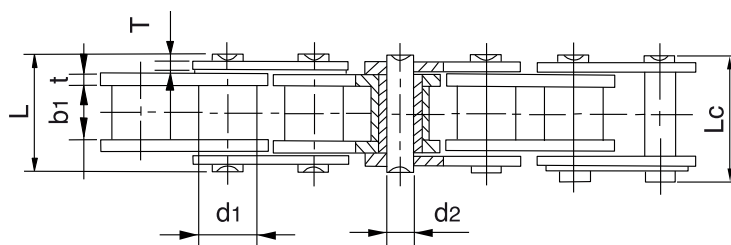
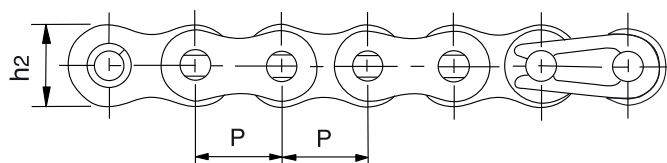
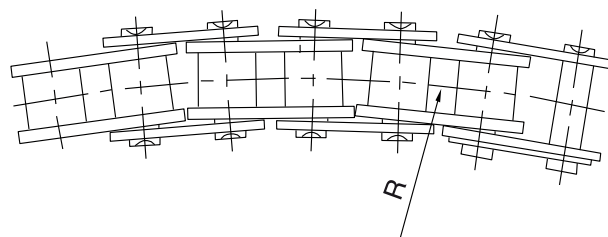

REFERENCIA	PASO	DIAMETRO DE RODILLO	ANCHO INTERIOR	DIAMETRO EJE	LONGITUD DEL EJE		ANCHO MALLAS	GROSOR DE MALLAS	RADIO DE CURVA LATERAL	FUERZA DE TENSION TOTAL	FUERZA DE TENSION MEDIA	PESO POR METRO
DIN/ISO	P mm.	d1 máx mm.	b1 mín mm.	d2 máx mm.	L máx mm.	Lc mín mm.	h2 max mm.	t/T máx mm.	R mín. mm.	Q mín. kN	Qo kN	q kg./m.
40SB	12.70	7.95	7.85	3.96	16.9	18.1	11.7	1.5	350	13.8	15.2	0.80
43SB	12.70	7.95	7.85	3.45	18.3	19.5	11.7	1.5	305	12.0	13.2	0.64
50SB	15.875	10.16	9.40	4.37	20.7	22.7	15.09	2.03	400	20.6	22.7	1.09
60SB	19.05	11.91	12.57	5.34	26.6	28.4	18.0	2.42	500	15.7	17.3	1.42
63SB	19.05	11.91	12.68	5.08	28.8	30.6	17.2	2.42/2.03	350	12.5	13.8	1.40
08BSB	12.70	8.51	7.75	3.97	17.4	18.7	11.8	1.6	400	14.0	15.4	0.70
08BSBF-1	12.70	8.51	7.75	3.97	16.3	17.6	11.8	1.6/1.2	400	12.8	14.1	0.65
10BSB	15.875	10.16	9.65	4.50	20.1	21.5	14.7	1.7	400	15.6	17.2	0.93
12BSB	19.05	12.07	11.68	5.12	23.1	24.8	16.0	1.85	500	20.5	22.6	1.16
C2050SB	31.75	10.16	9.40	5.08	21.3	22.6	15.0	2.03	800	21.8	24.1	1.09