

## Miniatur-Schräggugellager / Miniature Angular Contact Bearings

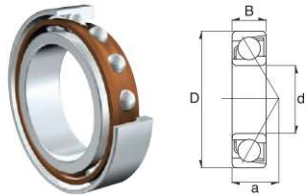

232

Dimension (mm)			Designation/Type	*Limiting Speed rpm (approx.)	Mass (g) approx.
d	D	B			
3.0	10.0	4.0	723 AC	-	1 g
4.0	13.0	7.0	724 AC	-	3 g
5.0	13.0	5.0	795 AC	-	3 g
6.0	17.0	6.0	706 AC	104000	6 g
7.0	22.0	7.0	727 AC	56000	13 g
7.0	17.0	5.0	797 AC	-	5 g
8.0	22.0	7.0	708 AC	76000	12 g
8.0	22.0	7.0	708 AC 2RS	76000	12 g
10.0	26.0	8.0	7000 AC	28800	18 g
10.0	22.0	6.0	7900 AC	19200	10 g
12.0	28.0	8.0	7001 AC	25600	22 g
15.0	32.0	9.0	7002 AC	53600	31 g

## Axial-Schräggugellager / Angular Contact Bearings

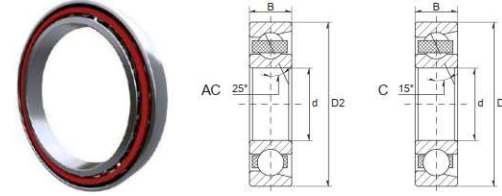

233

Dimension (mm)			Designation/Type	*Load Rating		*Limiting Speed rpm Grease	*Limiting Speed rpm Oil	Weight (kg) approx.
d	D2	B		C, dyn. N	C, stat. N			
10.0	19.0	5.0	71800 AC	1800	1100	75000	120000	0.005 kg
10.0	19.0	5.0	71800 C	1800	1100	75000	120000	0.005 kg
10.0	22.0	6.0	71900 AC	2900	1800	70000	110000	0.010 kg
10.0	22.0	6.0	71900 C	2900	1800	70000	110000	0.010 kg
12.0	21.0	5.0	71801 AC	2000	1400	70000	110000	0.006 kg
12.0	21.0	5.0	71801 C	2000	1400	70000	110000	0.006 kg
12.0	24.0	6.0	71901 AC	3200	2200	63000	95000	0.010 kg
12.0	24.0	6.0	71901 C	3200	2200	63000	95000	0.010 kg
15.0	24.0	5.0	71802 AC	2200	1800	60000	90000	0.007 kg
15.0	24.0	5.0	71802 C	2200	1800	60000	90000	0.007 kg
15.0	28.0	7.0	71902 AC	4800	3400	53000	80000	0.020 kg
15.0	28.0	7.0	71902 C	4800	3400	53000	80000	0.020 kg
17.0	26.0	5.0	71803 AC	2300	1900	53000	80000	0.008 kg
17.0	26.0	5.0	71803 C	2300	1900	53000	80000	0.008 kg
17.0	30.0	7.0	71903 AC	5100	3800	50000	75000	0.020 kg
17.0	30.0	7.0	71903 C	5100	3800	50000	75000	0.020 kg
20.0	32.0	7.0	71804 AC	3900	3400	45000	67000	0.018 kg
20.0	32.0	7.0	71804 C	3900	3400	45000	67000	0.018 kg
20.0	37.0	9.0	71904 AC	7400	5800	40000	60000	0.040 kg
20.0	37.0	9.0	71904 C	7400	5800	40000	60000	0.040 kg
25.0	37.0	7.0	71805 AC	4200	4100	38000	56000	0.022 kg
25.0	37.0	7.0	71805 C	4200	4100	38000	56000	0.022 kg
25.0	42.0	9.0	71905 AC	7600	6500	34000	50000	0.040 kg
25.0	42.0	9.0	71905 C	7600	6500	34000	50000	0.040 kg
30.0	42.0	7.0	71806 AC	4400	4800	32000	48000	0.025 kg
30.0	42.0	7.0	71806 C	4400	4800	32000	48000	0.025 kg
30.0	47.0	9.0	71906 AC	8000	7600	30000	45000	0.050 kg
30.0	47.0	9.0	71906 C	8000	7600	30000	45000	0.050 kg

# Axial-Schrägkugellager / Angular Contact Bearings

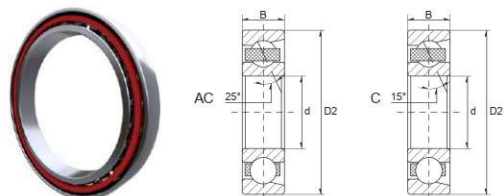

234

Dimension (mm)			Designation/Type	*Load Rating		*Limiting Speed rpm Grease	*Limiting Speed rpm Oil	Weight (kg) approx.
d	D2	B		C, dyn. N	C, stat. N			
35.0	47.0	7.0	71807 AC	4600	5500	26000	40000	0.029 kg
35.0	47.0	7.0	71807 C	4600	5500	26000	40000	0.029 kg
35.0	55.0	10.0	71907 AC	11000	10900	26000	40000	0.070 kg
35.0	55.0	10.0	71907 C	11000	10900	26000	40000	0.070 kg
40.0	52.0	7.0	71808 AC	4800	6200	24000	38000	0.032 kg
40.0	52.0	7.0	71808 C	4800	6200	24000	38000	0.032 kg
40.0	62.0	12.0	71908 AC	14000	14200	20000	34000	0.110 kg
40.0	62.0	12.0	71908 C	14000	14200	20000	34000	0.110 kg
45.0	58.0	7.0	71809 AC	4900	6700	20000	34000	0.040 kg
45.0	58.0	7.0	71809 C	4900	6700	20000	34000	0.040 kg
45.0	68.0	12.0	71909 AC	14700	16100	18000	30000	0.130 kg
45.0	68.0	12.0	71909 C	14700	16100	18000	30000	0.130 kg
50.0	65.0	7.0	71810 AC	7400	10000	18000	30000	0.052 kg
50.0	65.0	7.0	71810 C	7400	10000	18000	30000	0.052 kg
50.0	72.0	12.0	71910 AC	19000	21200	17000	28000	0.130 kg
50.0	72.0	12.0	71910 C	19000	21200	17000	28000	0.130 kg
55.0	72.0	9.0	71811 AC	10200	13800	16000	26000	0.081 kg
55.0	72.0	9.0	71811 C	10200	13800	16000	26000	0.081 kg
55.0	80.0	13.0	71911 AC	23700	27400	15000	24000	0.180 kg
55.0	80.0	13.0	71911 C	23700	27400	15000	24000	0.180 kg
60.0	78.0	10.0	71812 AC	13400	18000	15000	24000	0.100 kg
60.0	78.0	10.0	71812 C	13400	18000	15000	24000	0.100 kg
60.0	85.0	13.0	71912 AC	24800	30300	14000	22000	0.190 kg
60.0	85.0	13.0	71912 C	24800	30300	14000	22000	0.190 kg
65.0	85.0	10.0	71813 AC	13400	18800	14000	22000	0.125 kg
65.0	85.0	10.0	71813 C	13400	18800	14000	22000	0.125 kg
65.0	90.0	13.0	71913 AC	25100	31900	13000	20000	0.200 kg
65.0	90.0	13.0	71913 C	25100	31900	13000	20000	0.200 kg

# Axial-Schrägkugellager / Angular Contact Bearings

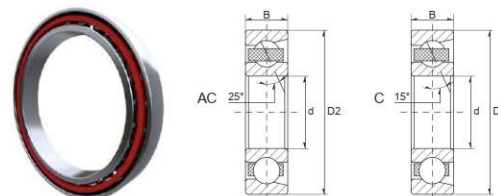

235

Dimension (mm)			Designation/Type	*Load Rating		*Limiting Speed rpm Grease	*Limiting Speed rpm Oil	Weight (kg) approx.
d	D2	B		C, dyn. N	C, stat. N			
70.0	90.0	10.0	71814 AC	13800	20300	13000	20000	0.133 kg
70.0	90.0	10.0	71814 C	13800	20300	13000	20000	0.133 kg
70.0	100.0	16.0	71914 AC	34500	43400	12000	19000	0.330 kg
70.0	100.0	16.0	71914 C	34500	43400	12000	19000	0.330 kg
75.0	95.0	10.0	71815 AC	14200	21700	12000	19000	0.142 kg
75.0	95.0	10.0	71815 C	14200	21700	12000	19000	0.142 kg
75.0	105.0	16.0	71915 AC	25000	45600	11000	18000	0.350 kg
75.0	105.0	16.0	71915 C	25000	45600	11000	18000	0.350 kg
80.0	100.0	10.0	71816 AC	14500	23100	10000	18000	0.150 kg
80.0	100.0	10.0	71816 C	14500	23100	10000	18000	0.150 kg
80.0	110.0	16.0	71916 AC	35500	47800	10000	17000	0.370 kg
80.0	110.0	16.0	71916 C	35500	47800	10000	17000	0.370 kg
85.0	110.0	13.0	71817 AC	21500	32200	10000	17000	0.262 kg
85.0	110.0	13.0	71817 C	21500	32200	10000	17000	0.262 kg
85.0	120.0	18.0	71917 AC	46500	61900	9500	16000	0.530 kg
85.0	120.0	18.0	71917 C	46500	61900	9500	16000	0.530 kg
90.0	115.0	13.0	71818 AC	21700	33500	9500	16000	0.274 kg
90.0	115.0	13.0	71818 C	21700	33500	9500	16000	0.274 kg
90.0	125.0	18.0	71918 AC	47200	64800	9000	15000	0.560 kg
90.0	125.0	18.0	71918 C	47200	64800	9000	15000	0.560 kg
95.0	120.0	13.0	71819 AC	21900	34700	9000	15000	0.287 kg
95.0	120.0	13.0	71819 C	21900	34700	9000	15000	0.287 kg
95.0	130.0	18.0	71919 AC	47900	67800	9000	15000	0.580 kg
95.0	130.0	18.0	71919 C	47900	67800	9000	15000	0.580 kg
100.0	125.0	13.0	71820 AC	22500	37000	8500	14000	0.301 kg
100.0	125.0	13.0	71820 C	22500	37000	8500	14000	0.301 kg
100.0	140.0	20.0	71920 AC	60400	84400	8500	14000	0.790 kg
100.0	140.0	20.0	71920 C	60400	84400	8500	14000	0.790 kg



# Einreihige Schrägkugellager / Single Row Angular Contact Bearings

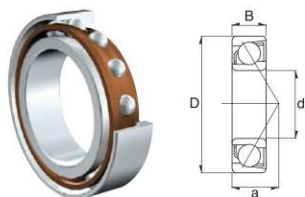

236

Dimension (mm)			Designation/Type				*Load Rating (only 100 Cr6)		*Limiting Speed x1000rpm (open)		Weight (g) approx.
d	D	B	Open		2RS		C, dyn. N	C, stat. N	Grease	Oil	
			Chrome Steel	Stainless	Chrome Steel	Stainless					
10.0	30.0	9.0	7200B	S7200B	7200B-2RS	avail. / lieferbar.	6350	2720	11.9	23.5	30 g
12.0	32.0	10.0	7201B	S7201B	7201B-2RS	avail. / lieferbar.	8050	3740	17.5	23.5	30 g
15.0	35.0	11.0	7202B	S7202B	7202B-2RS	avail. / lieferbar.	8700	4360	16.0	21.5	40 g
17.0	40.0	12.0	7203B	S7203B	7203B-2RS	avail. / lieferbar.	10700	5550	14.2	19.0	60 g
20.0	47.0	14.0	7204B	S7204B	7204B-2RS	avail. / lieferbar.	15400	8200	12.4	17.0	100 g
25.0	52.0	15.0	7205B	S7205B	7205B-2RS	avail. / lieferbar.	16400	9350	11.0	14.9	120 g
30.0	62.0	16.0	7206B	S7206B	7206B-2RS	avail. / lieferbar.	23400	14300	9.4	12.7	190 g
35.0	72.0	17.0	7207B	S7207B	7207B-2RS	avail. / lieferbar.	30300	19100	8.2	11.0	260 g
40.0	80.0	18.0	7208B	S7208B	7208B-2RS	avail. / lieferbar.	35500	23000	7.3	9.9	350 g
45.0	85.0	19.0	7209B	S7209B	7209B-2RS	avail. / lieferbar.	37200	25400	6.8	9.1	400 g
50.0	90.0	20.0	7210B	S7210B	7210B-2RS	avail. / lieferbar.	38800	27800	6.3	8.5	440 g
10.0	35.0	11.0	7300B	S7300B	7300B-2RS	avail. / lieferbar.	9150	3840	10.8	21.5	60 g
12.0	37.0	12.0	7301B	S7301B	7301B-2RS	avail. / lieferbar.	10900	4960	16.0	22.0	60 g
15.0	42.0	13.0	7302B	S7302B	7302B-2RS	avail. / lieferbar.	13100	6100	14.2	19.0	80 g
17.0	47.0	14.0	7303B	S7303B	7303B-2RS	avail. / lieferbar.	16600	8300	12.9	17.5	110 g
20.0	52.0	15.0	7304B	S7304B	7304B-2RS	avail. / lieferbar.	19300	9900	11.7	16.0	150 g
25.0	62.0	17.0	7305B	S7305B	7305B-2RS	avail. / lieferbar.	25000	13400	9.9	13.3	220 g
30.0	72.0	19.0	7306B	S7306B	7306B-2RS	avail. / lieferbar.	33700	19400	8.5	11.5	330 g
35.0	80.0	21.0	7307B	S7307B	7307B-2RS	avail. / lieferbar.	37400	22200	7.6	10.3	430 g
40.0	90.0	23.0	7308B	S7308B	7308B-2RS	avail. / lieferbar.	49300	29900	6.8	9.1	600 g
45.0	100.0	25.0	7309B	S7309B	7309B-2RS	avail. / lieferbar.	60500	38800	6.1	8.2	810 g
50.0	110.0	27.0	7310B	S7310B	7310B-2RS	avail. / lieferbar.	72000	47100	5.5	7.4	1050 g

# Doppelreihige Pendelkugellager / Double Row Self Aligning Bearings

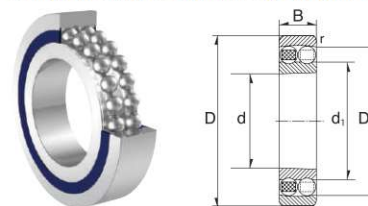

237

Dimension (mm)			Designation/Type				*Load Rating (only 100 Cr6)		*Limiting Speed x1000rpm (open)		Weight (g) approx.
d	D	B	Open		2RS		C, dyn. N	C, stat. N	Grease	Oil	
			Chrome Steel	Stainless	Chrome Steel	Stainless					
10.0	30.0	9.0	1200	S1200	1200-2RS	S1200-2RS	4050	1290	22.0	-	34 g
12.0	32.0	10.0	1201	S1201	1201-2RS	S1201-2RS	4600	1400	21.0	-	40 g
15.0	35.0	11.0	1202	S1202	1202-2RS	S1202-2RS	5600	1960	18.5	-	49 g
17.0	40.0	12.0	1203	S1203	1203-2RS	S1203-2RS	5900	2300	17.5	-	73 g
20.0	47.0	14.0	1204	S1204	1204-2RS	S1204-2RS	7500	2950	14.5	-	120 g
25.0	52.0	15.0	1205	S1205	1205-2RS	S1205-2RS	9150	3900	12.0	-	140 g
30.0	62.0	16.0	1206	S1206	1206-2RS	S1206-2RS	11000	5500	10.0	-	220 g
10.0	30.0	14.0	2200	S2200	2200-2RS	S2200-2RS	5300	1530	22.0	28.0	47 g
12.0	32.0	14.0	2201	S2201	2201-2RS	S2201-2RS	6000	1960	20.0	25.0	53 g
15.0	35.0	14.0	2202	S2202	2202-2RS	S2202-2RS	6000	2190	18.0	22.0	60 g
17.0	40.0	16.0	2203	S2203	2203-2RS	S2203-2RS	7900	2800	16.0	19.0	88 g
20.0	47.0	18.0	2204	S2204	2204-2RS	S2204-2RS	9800	3950	13.0	16.0	140 g
25.0	52.0	18.0	2205	S2205	2205-2RS	S2205-2RS	9800	4350	12.0	14.0	165 g
30.0	62.0	20.0	2206	S2206	2206-2RS	S2206-2RS	12200	6800	10.0	12.0	260 g
35.0	72.0	23.0	2207	S2207	2207-2RS	S2207-2RS	17100	8400	8.5	10.0	405 g
40.0	80.0	23.0	2208	S2208	2208-2RS	S2208-2RS	17700	9650	7.5	9.0	505 g
45.0	85.0	23.0	2209	S2209	2209-2RS	S2209-2RS	18400	10900	7.1	8.5	545 g
50.0	90.0	23.0	2210	S2210	2210-2RS	S2210-2RS	18400	11500	6.3	8.0	590 g

## Doppelreihige Schrägkugellager / Double Row Angular Contact Ball Bearings

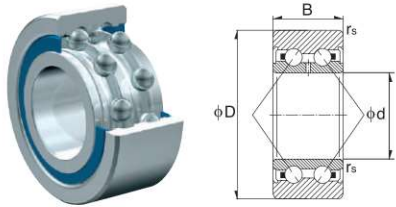

238

Dimension (mm)			Designation/Type				*Load Rating (only 100 Cr6)		*Limiting Speed x1000rpm (open)		Weight (g) approx.
d	D	B	Open		2RS		C, dyn. N	C, stat. N	Grease	Oil	
			Chrome Steel	Stainless	Chrome Steel	Stainless					
10.0	30.0	14.0	3200	S3200	3200-2RS	S3200-2RS	7600	5850	16.0	20.0	50 g
12.0	32.0	15.9	3201	S3201	3201-2RS	S3201-2RS	8750	6500	15.0	19.0	60 g
15.0	35.0	15.9	3202	S3202	3202-2RS	S3202-2RS	11100	9100	13.0	17.0	70 g
17.0	40.0	17.5	3203	S3203	3203-2RS	S3203-2RS	14400	8650	10.0	15.0	103 g
20.0	47.0	20.6	3204	S3204	3204-2RS	S3204-2RS	19300	12000	9.0	13.0	168 g
25.0	52.0	20.6	3205	S3205	3205-2RS	S3205-2RS	20900	14100	8.0	11.0	194 g
30.0	62.0	23.8	3206	S3206	3206-2RS	S3206-2RS	29100	20100	7.1	9.0	316 g
35.0	72.0	27.0	3207	S3207	3207-2RS	S3207-2RS	38400	27400	5.6	7.1	484 g
40.0	80.0	30.2	3208	S3208	3208-2RS	S3208-2RS	47400	34600	5.0	6.3	654 g
45.0	85.0	30.2	3209	S3209	3209-2RS	S3209-2RS	47500	35400	4.5	5.4	709 g
50.0	90.0	30.2	3210	S3210	3210-2RS	S3210-2RS	50700	40200	4.0	4.6	764 g
17.0	47.0	22.2	3303	S3303	3303-2RS	S3303-2RS	20900	11900	9.5	14.0	190 g
20.0	52.0	22.2	3304	S3304	3304-2RS	S3304-2RS	23100	14500	8.5	12.0	230 g
25.0	62.0	25.4	3305	S3305	3305-2RS	S3305-2RS	29500	19100	7.5	10.0	369 g
30.0	72.0	30.2	3306	S3306	3306-2RS	S3306-2RS	41000	27400	6.2	7.9	585 g
35.0	80.0	34.9	3307	S3307	3307-2RS	S3307-2RS	51200	33200	5.1	6.5	816 g
40.0	90.0	36.5	3308	S3308	3308-2RS	S3308-2RS	61900	43400	4.7	5.8	1070 g
45.0	100.0	38.7	3309	S3309	3309-2RS	S3309-2RS	89000	79300	4.5	6.0	1420 g
50.0	110.0	44.4	3310	S3310	3310-2RS	S3310-2RS	107000	96300	4.0	5.3	1930 g
17.0	40.0	17.5	5203	S5203	5203-2RS	S5203-2RS	14600	9050	11.0	16.0	96 g
20.0	47.0	20.0	5204	S5204	5204-2RS	S5204-2RS	19600	12400	10.0	15.0	160 g
25.0	52.0	20.6	5205	S5205	5205-2RS	S5205-2RS	21300	14700	8.5	11.0	180 g
30.0	62.0	23.8	5206	S5206	5206-2RS	S5206-2RS	25600	21100	7.1	9.5	290 g

## Doppelreihige Schrägkugellager / Double Row Angular Contact Ball Bearings

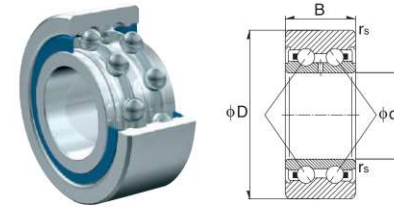

239

Dimension (mm)			Designation/Type				*Load Rating (only 100 Cr6)		*Limiting Speed x1000rpm (open)		Weight (g) approx.
d	D	B	Open		2RS		C, dyn. N	C, stat. N	Grease	Oil	
			Chrome Steel	Stainless	Chrome Steel	Stainless					
35.0	72.0	27.0	5207	S5207	5207-2RS	S5207-2RS	39000	28700	6.3	8.0	440 g
40.0	80.0	30.2	5208	S5208	5208-2RS	S5208-2RS	44000	33500	5.6	7.5	580 g
45.0	85.0	30.2	5209	S5209	5209-2RS	S5209-2RS	49500	38000	5.0	6.7	630 g
50.0	90.0	30.2	5210	S5210	5210-2RS	S5210-2RS	53000	43500	4.8	6.3	660 g
17.0	47.0	22.2	5303	S5303	5303-2RS	S5303-2RS	21000	12600	10.0	14.0	180 g
20.0	52.0	22.2	5304	S5304	5304-2RS	S5304-2RS	24600	16000	9.0	12.0	220 g
25.0	62.0	25.4	5305	S5305	5305-2RS	S5305-2RS	32500	20700	7.5	10.0	350 g
30.0	72.0	30.2	5306	S5306	5306-2RS	S5306-2RS	40500	28100	6.3	8.5	530 g
35.0	80.0	34.9	5307	S5307	5307-2RS	S5307-2RS	51000	36000	5.6	7.5	730 g
40.0	90.0	36.5	5308	S5308	5308-2RS	S5308-2RS	56500	41000	5.3	6.7	950 g
45.0	100.0	38.7	5309	S5309	5309-2RS	S5309-2RS	68500	51000	4.5	6.0	1400 g
50.0	110.0	44.4	5310	S5310	5310-2RS	S5310-2RS	81800	62200	3.6	5.3	1950 g



Doppelreihige Kugellager / Double Row Angular Contact Bearings

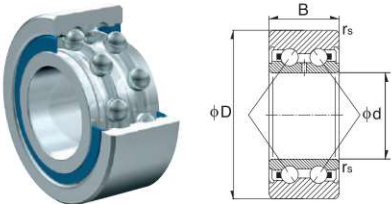

240

Dimension (mm)			Designation/Type			*Load Rating		*Limiting Speed x1000rpm	Weight (g) approx.
d	D	B	Open	2Z	2RS	C, dyn. N	C, stat. N		
10.0	19.0	7.0	3800	3800-2Z	3800-2RS	2120	1400	18.0	8 g
12.0	21.0	7.0	3801	3801-2Z	3801-2RS	2190	1550	16.0	8 g
15.0	24.0	7.0	3802	3802-2Z	3802-2RS	2430	1960	16.0	9 g
17.0	26.0	7.0	3803	3803-2Z	3803-2RS	2480	2080	14.0	15 g
20.0	32.0	10.0	3804	3804-2Z	3804-2RS	5800	4850	10.0	20 g
25.0	37.0	10.0	3805	3805-2Z	3805-2RS	6000	5600	8.5	25 g
30.0	42.0	10.0	3806	3806-2Z	3806-2RS	6300	6100	7.0	30 g
35.0	47.0	10.0	3807	3807-2Z	3807-2RS	6700	7000	6.0	37 g
40.0	52.0	10.0	3808	3808-2Z	3808-2RS	7000	7800	5.3	40 g

Company focus

Technische Zeichnungen in AutoCAD  
Autocad Technical Drawings

ZEN bietet für alle seine Produkte AutoCAD-Zeichnungen an. Diese beinhalten u. a.:

ZEN have an AUTOCAD department that can supply AUTOCAD drawings for all our products. Each technical drawing includes:

- ✓ Allgemeine Informationen  
Working Information
- ✓ Radialspiel  
Radial Play
- ✓ Tragzahlen  
Load Ratings
- ✓ Drehzahlgrenzen  
Limiting Speeds
- ✓ Abmessungen  
Dimensions
- ✓ Gewicht  
Weight
- ✓ Verwendete Materialien  
Parts Material

Alle unsere technischen Zeichnungen sind unter [www.zen.biz](http://www.zen.biz) einseh- und downloadbar.

All our technical drawings are available online at [www.zen.biz](http://www.zen.biz).