

Pulegge per cinghie dentate
Timing belt pulleys
Zahnriemenscheiben
Poulies pour courroies dentées
Poleas para correas dentadas

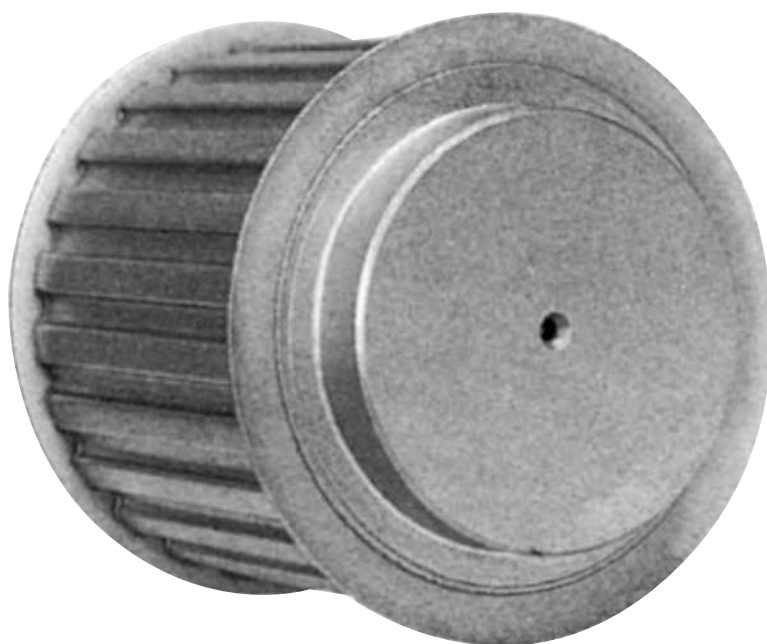

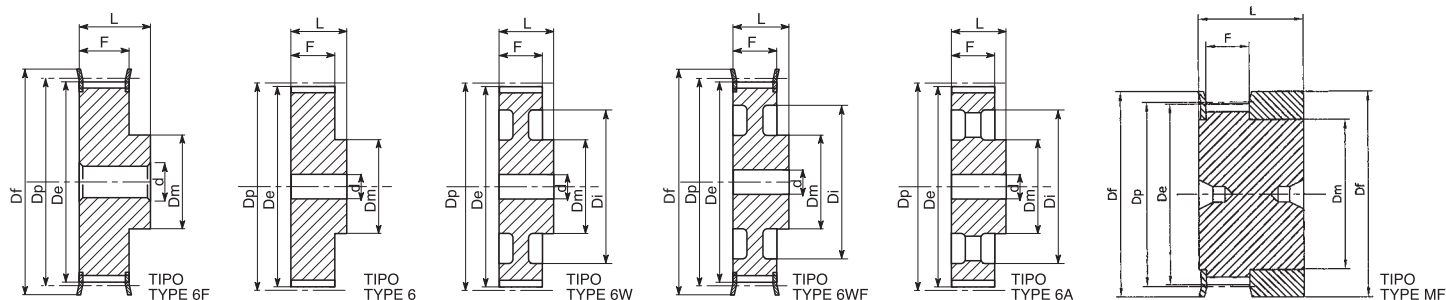

MXL 025 - 0,080" (2,032 mm)

| Caratteristiche Features Merkmale Características | Codice Code symbol Fabriknummer Code symbole Numero de fabrica | Nostro codice Our code Unser kode Notre code Nuestro codigo | Tipo Type Typ Type Tipo | Tipo flangia Flanges type Bordscheiben Typ Type flasques Tipo tapetas | N. denti N. of teeth Zahnezahl N. bre de dents Cantidad de dientes | Dp | De | Df | Dm | Di | F | L | Foro stock Stock bore Vor bohrung Alesage en stock Agujero de stock | Peso Weight Gewicht Poids Peso Kg |
|--|--|---|-------------------------------------|---|--|-------|-------|------|------|----|------|----|---|--|
| Alluminio / Aluminium / Aluminum / Aluminium | 16 MXL 025 | MXL 2516 | MF | F02 | 16 | 10,35 | 9,84 | 15,0 | 8,0 | - | 8,5 | 16 | - | - |
| | 18 MXL 025 | MXL 2518 | MF | F03 | 18 | 11,64 | 11,12 | 16,0 | 9,5 | - | 8,5 | 16 | - | - |
| | 20 MXL 025 | MXL 2520 | MF | F03 | 20 | 12,94 | 12,43 | 16,0 | 9,5 | - | 8,5 | 16 | - | - |
| | 22 MXL 025 | MXL 2522 | 6F | F04 | 22 | 14,23 | 13,72 | 17,5 | 10,0 | - | 11,0 | 16 | 3 | 3 |
| | 24 MXL 025 | MXL 2524 | 6F | F06 | 24 | 15,52 | 15,01 | 20,0 | 10,0 | - | 11,0 | 16 | 3 | 3 |
| | 28 MXL 025 | MXL 2528 | 6F | F08 | 28 | 18,11 | 17,60 | 25,0 | 11,0 | - | 11,0 | 16 | 3 | 3 |
| | 30 MXL 025 | MXL 2530 | 6F | F08 | 30 | 19,40 | 18,90 | 25,0 | 12,0 | - | 11,0 | 16 | 4 | 4 |
| | 32 MXL 025 | MXL 2532 | 6F | F08 | 32 | 20,70 | 20,19 | 25,0 | 14,0 | - | 11,0 | 16 | 4 | 4 |
| | 36 MXL 025 | MXL 2536 | 6F | F09 | 36 | 23,29 | 22,78 | 28,0 | 16,0 | - | 11,0 | 16 | 4 | 4 |
| | 40 MXL 025 | MXL 2540 | 6F | F10 | 40 | 25,87 | 25,37 | 32,0 | 18,0 | - | 11,0 | 16 | 4 | 4 |
| | 42 MXL 025 | MXL 2542 | 6F | F10 | 42 | 27,17 | 26,67 | 32,0 | 18,0 | - | 11,0 | 16 | 5 | 5 |
| | 44 MXL 025 | MXL 2544 | 6F | F13 | 44 | 28,46 | 27,95 | 37,0 | 18,0 | - | 11,0 | 16 | 5 | 5 |
| | 48 MXL 025 | MXL 2548 | 6 | - | 48 | 31,05 | 30,54 | - | 20,0 | - | 11,0 | 16 | 5 | 5 |
| | 60 MXL 025 | MXL 2560 | 6 | - | 60 | 38,81 | 38,30 | - | 24,0 | - | 11,0 | 16 | 5 | 5 |
| | 72 MXL 025 | MXL 2572 | 6 | - | 72 | 46,57 | 46,06 | - | 25,0 | - | 11,0 | 16 | 6 | 6 |

XL 037 - 1/5" (5,08 mm)

| Caratteristiche Features Merkmale Características | | Codice Code symbol Fabriknummer Code symbole Numero de fabrica | Nostro codice Our code Unser kode Notre code Nuestro codigo | Tipo Type Typ Type Tipo | Tipo flangia Flanges type Bordscheiben Typ Type flasques Tipo tapetas | N. denti N. of teeth Zahnezahl N. bre de dents Cantidad de dientes | Dp | De | Df | Dm | Di | F | L | Foro stock Stock bore Vor bohrung Alesage en stock Agujero de stock | Peso Weight Gewicht Poids Peso Kg | |
|--|---|--|---|-------------------------------------|---|--|----|--------|--------|----|------|-----|------|---|--|------|
| Alluminio / Aluminium / Aluminum Aluminium / Aluminio | con flangia / with flanges mit Flanges / avec flasques / con tapetas | 10 XL 037 | XA37010 | XC37010 | 6F | F07 | 10 | 16,17 | 15,66 | 23 | 9,5 | - | 14,3 | 20 | 4 | 0,02 |
| | | 11 XL 037 | XA37011 | XC37011 | 6F | F07 | 11 | 17,79 | 17,28 | 23 | 9,5 | - | 14,3 | 20 | 4 | 0,02 |
| | | 12 XL 037 | XA37012 | XC37012 | 6F | F08 | 12 | 19,40 | 18,90 | 25 | 10 | - | 14,3 | 20 | 4 | 0,03 |
| | | 13 XL 037 | XA37013 | XC37013 | 6F | F08 | 13 | 21,02 | 20,51 | 25 | 10 | - | 14,3 | 20 | 4 | 0,04 |
| | | 14 XL 037 | XA37014 | XC37014 | 6F | F09 | 14 | 22,64 | 22,13 | 28 | 15 | - | 14,3 | 20 | 4 | 0,05 |
| | | 15 XL 037 | XA37015 | XC37015 | 6F | F09 | 15 | 24,26 | 23,75 | 28 | 15 | - | 14,3 | 20 | 6 | 0,05 |
| | | 16 XL 037 | XA37016 | XC37016 | 6F | F10 | 16 | 25,87 | 25,36 | 32 | 16 | - | 14,3 | 20 | 6 | 0,06 |
| | | 17 XL 037 | XA37017 | XC37017 | 6F | F10 | 17 | 27,49 | 26,98 | 32 | 20 | - | 14,3 | 20 | 6 | 0,07 |
| | | 18 XL 037 | XA37018 | XC37018 | 6F | F11 | 18 | 29,11 | 28,60 | 35 | 20 | - | 14,3 | 20 | 6 | 0,08 |
| | | 19 XL 037 | XA37019 | XC37019 | 6F | F11 | 19 | 30,72 | 30,22 | 35 | 20 | - | 14,3 | 22 | 6 | 0,09 |
| | | 20 XL 037 | XA37020 | XC37020 | 6F | F14 | 20 | 32,34 | 31,83 | 38 | 23,5 | - | 14,3 | 22 | 6 | 0,11 |
| | | 21 XL 037 | XA37021 | XC37021 | 6F | F14 | 21 | 33,96 | 33,45 | 38 | 23,5 | - | 14,3 | 22 | 6 | 0,12 |
| | | 22 XL 037 | XA37022 | XC37022 | 6F | F15 | 22 | 35,57 | 35,07 | 42 | 25 | - | 14,3 | 22 | 6 | 0,13 |
| | | 24 XL 037 | XA37024 | XC37024 | 6F | F17 | 24 | 38,81 | 38,30 | 44 | 30 | - | 14,3 | 22 | 6 | 0,15 |
| | | 26 XL 037 | XA37026 | XC37026 | 6F | F18 | 26 | 42,04 | 41,53 | 48 | 30 | - | 14,3 | 22 | 8 | 0,19 |
| | | 27 XL 037 | XA37027 | XC37027 | 6F | F18 | 27 | 43,66 | 43,15 | 48 | 34 | - | 14,3 | 22 | 8 | 0,20 |
| | | 28 XL 037 | XA37028 | XC37028 | 6F | F19 | 28 | 45,28 | 44,77 | 51 | 34 | - | 14,3 | 22 | 8 | 0,22 |
| | | 29 XL 037 | XA37029 | XC37029 | 6F | F19 | 29 | 46,89 | 46,39 | 51 | 34 | - | 14,3 | 22 | 8 | 0,22 |
| | | 30 XL 037 | XA37030 | XC37030 | 6F | F20 | 30 | 48,51 | 48,00 | 54 | 38 | - | 14,3 | 22 | 8 | 0,11 |
| | | 32 XL 037 | XA37032 | XC37032 | 6F | F21 | 32 | 51,74 | 51,24 | 57 | 38 | - | 14,3 | 25 | 8 | 0,12 |
| Altern. / Altern. Altern. / Altern. | senza flangia / without flanges sans flasques / sin tapetas | 34 XL 037 | XA37034 | XC37034 | 6 | | 34 | 54,98 | 54,47 | - | 45 | - | 14,3 | 25 | 8 | 0,12 |
| | | 35 XL 037 | XA37035 | XC37035 | 6 | | 35 | 56,60 | 56,09 | - | 45 | - | 14,3 | 25 | 8 | 0,13 |
| | | 36 XL 037 | XA37036 | XC37036 | 6 | | 36 | 58,21 | 57,70 | - | 45 | - | 14,3 | 25 | 8 | 0,14 |
| | | 38 XL 037 | XA37038 | XC37038 | 6 | | 38 | 61,45 | 60,94 | - | 45 | - | 14,3 | 25 | 8 | 0,16 |
| | | 39 XL 037 | XA37039 | XC37039 | 6 | | 39 | 63,06 | 62,56 | - | 45 | - | 14,3 | 25 | 8 | 0,17 |
| | | 40 XL 037 | XA37040 | XC37040 | 6 | | 40 | 64,68 | 64,17 | - | 45 | - | 14,3 | 25 | 8 | 0,17 |
| | | 41 XL 037 | XA37041 | XC37041 | 6 | | 41 | 66,30 | 65,79 | - | 45 | - | 14,3 | 25 | 8 | 0,18 |
| | | 42 XL 037 | XA37042 | XC37042 | 6 | | 42 | 67,91 | 67,41 | - | 45 | - | 14,3 | 25 | 8 | 0,18 |
| | | 43 XL 037 | XA37043 | XC37043 | 6 | | 43 | 69,53 | 69,02 | - | 45 | - | 14,3 | 25 | 8 | 0,19 |
| | | 44 XL 037 | XA37044 | XC37044 | 6 | | 44 | 71,15 | 70,64 | - | 45 | - | 14,3 | 25 | 8 | 0,19 |
| Acciaio / Steel / Stahl Acier / Acero | | 45 XL 037 | XA37045 | XC37045 | 6W | | 45 | 72,77 | 72,26 | - | 45 | 61 | 14,3 | 25 | 10 | 0,19 |
| | | 46 XL 037 | XA37046 | XC37046 | 6W | | 46 | 74,38 | 73,87 | - | 45 | 61 | 14,3 | 25 | 10 | 0,19 |
| | | 47 XL 037 | XA37047 | XC37047 | 6W | | 47 | 76,00 | 75,49 | - | 45 | 61 | 14,3 | 25 | 10 | 0,19 |
| | | 48 XL 037 | XA37048 | XC37048 | 6W | | 48 | 77,62 | 77,11 | - | 45 | 61 | 14,3 | 25 | 10 | 0,19 |
| | | 49 XL 037 | XA37049 | XC37049 | 6W | | 49 | 79,23 | 78,73 | - | 45 | 61 | 14,3 | 25 | 10 | 0,22 |
| | | 52 XL 037 | XA37052 | XC37052 | 6W | | 52 | 84,08 | 83,58 | - | 45 | 67 | 14,3 | 25 | 10 | 0,22 |
| | | 56 XL 037 | XA37056 | XC37056 | 6W | | 56 | 90,55 | 90,04 | - | 45 | 80 | 14,3 | 25 | 10 | 0,25 |
| | | 57 XL 037 | XA37057 | XC37057 | 6W | | 57 | 92,17 | 91,66 | - | 45 | 80 | 14,3 | 25 | 10 | 0,25 |
| | | 58 XL 037 | XA37058 | XC37058 | 6W | | 58 | 93,79 | 93,28 | - | 45 | 80 | 14,3 | 25 | 10 | 0,25 |
| | | 59 XL 037 | XA37059 | XC37059 | 6W | | 59 | 95,40 | 94,90 | - | 45 | 80 | 14,3 | 25 | 10 | 0,25 |
| | | 60 XL 037 | XA37060 | XC37060 | 6W | | 60 | 97,02 | 96,51 | - | 45 | 80 | 14,3 | 25 | 10 | 0,25 |
| | | 68 XL 037 | XA37068 | XC37068 | 6W | | 68 | 109,96 | 109,45 | - | 45 | 100 | 14,3 | 25 | 10 | 0,30 |
| | | 69 XL 037 | XA37069 | XC37069 | 6W | | 69 | 111,57 | 111,07 | - | 45 | 100 | 14,3 | 25 | 10 | 0,30 |
| | | 70 XL 037 | XA37070 | XC37070 | 6W | | 70 | 113,19 | 112,68 | - | 45 | 100 | 14,3 | 25 | 10 | 0,30 |
| | | 71 XL 037 | XA37071 | XC37071 | 6W | | 71 | 114,81 | 114,30 | - | 45 | 100 | 14,3 | 25 | 10 | 0,30 |
| | | 72 XL 037 | XA37072 | XC37072 | 6W | | 72 | 116,42 | 115,92 | - | 45 | 100 | 14,3 | 25 | 10 | 0,30 |

Pulegge per cinghie dentate / Timing belt pulleys

Zahnriemenscheiben / Poulies pour courroies dentées / Poleas para correas dentadas



L 050 - 3/8" (9,525 mm)

| Caratteristiche Features Merkmale Características | | Codice Code symbol Fabriknummer Code symbole Numero de fabrica | Nostro codice Our code Unser code Notre code Nuestro codigo | Tipo Type Typ Type Tipo | Tipo flangia Flanges type Bordscheiben Typ Type flasques Tipo tapetas | N. denti N. of teeth Zahnezahl N. bre de dents Cantidad de dientes | Dp | De | Df | Dm | Di | F | L | Foro stock Stock bore Vor bohrung Alesage en stock Agujero de stock | Peso Weight / Gewicht Poids / Peso Kg |
|--|--|--|---|-------------------------------------|---|--|--------|--------|-----|----|-----|------|----|---|--|
| Acciaio / Steel / Stahl Acier / Acero | con flangia / with flanges mit Flanges / avec flasques / con tapetas | 10L050 | L050010 | 6F | F13 | 10 | 30,32 | 29,56 | 37 | 20 | — | 19,0 | 28 | 8 | 0,11 |
| | | 11L050 | L050011 | 6F | F13 | 11 | 33,35 | 32,59 | 37 | 22 | — | 19,0 | 30 | 8 | 0,14 |
| | | 12L050 | L050012 | 6F | F16 | 12 | 36,38 | 35,62 | 43 | 24 | — | 19,0 | 30 | 8 | 0,17 |
| | | 13L050 | L050013 | 6F | F17 | 13 | 39,41 | 38,65 | 44 | 28 | — | 19,0 | 30 | 8 | 0,18 |
| | | 14L050 | L050014 | 6F | F18 | 14 | 42,45 | 41,68 | 48 | 28 | — | 19,0 | 30 | 8 | 0,22 |
| | | 15L050 | L050015 | 6F | F19 | 15 | 45,48 | 44,72 | 51 | 34 | — | 19,0 | 30 | 8 | 0,28 |
| | | 16L050 | L050016 | 6F | F20 | 16 | 48,51 | 47,75 | 54 | 36 | — | 19,0 | 32 | 8 | 0,35 |
| | | 17L050 | L050017 | 6F | F21 | 17 | 51,54 | 50,78 | 57 | 36 | — | 19,0 | 32 | 10 | 0,36 |
| | | 18L050 | L050018 | 6F | F22 | 18 | 54,57 | 53,81 | 60 | 40 | — | 19,0 | 32 | 10 | 0,42 |
| | | 19L050 | L050019 | 6F | F24 | 19 | 57,61 | 56,84 | 64 | 40 | — | 19,0 | 32 | 10 | 0,45 |
| | | 20L050 | L050020 | 6F | F25 | 20 | 60,64 | 59,88 | 66 | 40 | — | 19,0 | 32 | 10 | 0,48 |
| | | 21L050 | L050021 | 6F | F26 | 21 | 63,67 | 62,91 | 70 | 45 | — | 19,0 | 32 | 10 | 0,57 |
| | | 22L050 | L050022 | 6F | F27 | 22 | 66,70 | 65,94 | 75 | 45 | — | 19,0 | 32 | 10 | 0,59 |
| | | 23L050 | L050023 | 6F | F28 | 23 | 69,73 | 68,97 | 79 | 55 | — | 19,0 | 32 | 10 | 0,61 |
| | | 24L050 | L050024 | 6F | F28 | 24 | 72,77 | 72,00 | 79 | 55 | — | 19,0 | 32 | 10 | 0,80 |
| | | 25L050 | L050025 | 6F | F29 | 25 | 75,80 | 75,04 | 83 | 58 | — | 19,0 | 32 | 10 | 0,85 |
| | | 26L050 | L050026 | 6F | F30 | 26 | 78,83 | 78,07 | 87 | 58 | — | 19,0 | 32 | 11 | 0,90 |
| | | 27L050 | L050027 | 6F | F30 | 27 | 81,86 | 81,10 | 87 | 58 | — | 19,0 | 32 | 11 | 0,91 |
| | | 28L050 | L050028 | 6F | F31 | 28 | 84,89 | 84,13 | 91 | 58 | — | 19,0 | 32 | 11 | 0,95 |
| | | 29L050 | L050029 | 6F | F32 | 29 | 87,93 | 87,16 | 93 | 58 | — | 19,0 | 32 | 11 | 1,00 |
| | | 30L050 | L050030 | 6F | F33 | 30 | 90,96 | 90,20 | 97 | 70 | — | 19,0 | 32 | 11 | 1,07 |
| | | 32L050 | L050032 | 6F | F34 | 32 | 97,02 | 96,26 | 102 | 70 | — | 19,0 | 32 | 11 | 1,23 |
| | | 33L050 | L050033 | 6F | F35 | 33 | 100,05 | 99,29 | 106 | 70 | — | 19,0 | 32 | 11 | 1,30 |
| | | 34L050 | L050034 | 6F | F36 | 34 | 103,08 | 102,32 | 112 | 70 | — | 19,0 | 32 | 11 | 1,37 |
| | | 35L050 | L050035 | 6F | F36 | 35 | 106,12 | 105,35 | 112 | 70 | — | 19,0 | 32 | 11 | 1,44 |
| | | 36L050 | L050036 | 6F | F37 | 36 | 109,15 | 108,39 | 115 | 70 | — | 19,0 | 32 | 11 | 1,50 |
| | | 40L050 | L050040 | 6WF | F40 | 40 | 121,28 | 120,51 | 128 | 70 | 100 | 19,0 | 32 | 11 | 1,77 |
| | | 41L050 | L050041 | 6WF | F41 | 41 | 124,31 | 123,55 | 131 | 70 | 103 | 19,0 | 32 | 11 | 1,84 |
| | | 42L050 | L050042 | 6WF | F42 | 42 | 127,34 | 126,58 | 135 | 70 | 106 | 19,0 | 32 | 11 | 1,97 |
| | | 44L050 | L050044 | 6WF | F45 | 44 | 133,40 | 132,64 | 142 | 70 | 112 | 19,0 | 32 | 11 | 2,20 |
| | | 45L050 | L050045 | 6WF | F45 | 45 | 136,44 | 135,67 | 142 | 70 | 115 | 19,0 | 32 | 11 | 2,27 |
| | | 47L050 | L050047 | 6WF | F48 | 47 | 142,50 | 141,74 | 150 | 70 | 121 | 19,0 | 32 | 11 | 2,45 |
| | | 48L050 | L050048 | 6WF | F48 | 48 | 145,53 | 144,77 | 150 | 70 | 124 | 19,0 | 32 | 11 | 2,67 |
| Ghisa / Cast iron / Grauguss Fonte / Hierro fundido | senza flangia / without flanges ohne Flanschen / sans flasques sin tapetas | 49L050 | L050049 | 6W | | 49 | 148,56 | 147,80 | - | 70 | 127 | 19,0 | 32 | 14 | 1,80 |
| | | 50L050 | L050050 | 6W | | 50 | 151,60 | 150,83 | - | 70 | 130 | 19,0 | 32 | 14 | 1,90 |
| | | 52L050 | L050052 | 6W | | 52 | 157,66 | 156,90 | - | 70 | 136 | 19,0 | 32 | 14 | 2,10 |
| | | 56L050 | L050056 | 6W | | 56 | 169,79 | 169,02 | - | 70 | 149 | 19,0 | 32 | 14 | 2,18 |
| | | 57L050 | L050057 | 6W | | 57 | 172,82 | 172,06 | - | 70 | 152 | 19,0 | 32 | 14 | 2,47 |
| | | 60L050 | L050060 | 6W | | 60 | 181,91 | 181,15 | - | 75 | 160 | 19,0 | 42 | 14 | 3,10 |
| | | 65L050 | L050065 | 6A | | 65 | 197,07 | 196,31 | - | 75 | 176 | 19,0 | 42 | 14 | 3,20 |
| | | 66L050 | L050066 | 6A | | 66 | 200,11 | 199,34 | - | 75 | 179 | 19,0 | 42 | 14 | 3,23 |
| | | 72L050 | L050072 | 6A | | 72 | 218,30 | 217,53 | - | 75 | 197 | 19,0 | 42 | 14 | 4,86 |
| | | 84L050 | L050084 | 6A | | 84 | 254,68 | 253,92 | - | 75 | 233 | 19,0 | 42 | 14 | 5,00 |
| | | 90L050 | L050090 | 6A | | 90 | 272,87 | 272,11 | - | 75 | 252 | 19,0 | 42 | 14 | 5,50 |
| | | 96L050 | L050096 | 6A | | 96 | 291,06 | 290,30 | - | 75 | 269 | 19,0 | 42 | 14 | 6,00 |
| | | 120L050 | L050120 | 6A | | 120 | 363,83 | 363,07 | - | 75 | 342 | 19,0 | 42 | 14 | 8,50 |

L 075 - 3/8" (9,525 mm)

| Caratteristiche Features Merkmale Características | | Codice Code symbol Fabriknummer Code symbole Numero de fabrica | Nostro codice Our code Unser code Notre code Nuestro codigo | Tipo Type Typ Type Tipo | Tipo flangia Flanges type Bordscheiben Typ Type flasques Tipo tapetas | N. denti N. of teeth Zahnezahl N. bre de dents Cantidad de dientes | Dp | De | Df | Dm | Di | F | L | Foro stock Stock bore Vor bohrung Alesage en stock Agujero de stock | Peso Weight / Gewicht Poids / Peso Kg |
|--|---|--|---|-------------------------------------|---|--|--------|--------|-----|------|-----|------|-------|---|--|
| Acciaio / Steel / Stahl Acier / Acero | con flangia / with flanges mit Flanges / avec flasques / con tapetas | 10L075 | L075010 | 6F | F13 | 10 | 30,32 | 29,56 | 37 | 20 | — | 25,4 | 38 | 8 | 0,15 |
| | | 11L075 | L075011 | 6F | F13 | 11 | 33,35 | 32,59 | 37 | 22 | — | 25,4 | 38 | 8 | 0,17 |
| | | 12L075 | L075012 | 6F | F16 | 12 | 36,38 | 35,62 | 43 | 24 | — | 25,4 | 38 | 8 | 0,22 |
| | | 13L075 | L075013 | 6F | F17 | 13 | 39,41 | 38,65 | 44 | 28 | — | 25,4 | 38 | 8 | 0,25 |
| | | 14L075 | L075014 | 6F | F18 | 14 | 42,45 | 41,68 | 48 | 28 | — | 25,4 | 38 | 11 | 0,28 |
| | | 15L075 | L075015 | 6F | F19 | 15 | 45,48 | 44,72 | 51 | 34 | — | 25,4 | 38 | 11 | 0,38 |
| | | 16L075 | L075016 | 6F | F20 | 16 | 48,51 | 47,75 | 54 | 36 | — | 25,4 | 38 | 11 | 0,43 |
| | | 17L075 | L075017 | 6F | F21 | 17 | 51,54 | 50,78 | 57 | 36 | — | 25,4 | 38 | 11 | 0,44 |
| | | 18L075 | L075018 | 6F | F22 | 18 | 54,57 | 53,81 | 60 | 40 | — | 25,4 | 38 | 11 | 0,52 |
| | | 19L075 | L075019 | 6F | F24 | 19 | 57,61 | 56,84 | 64 | 40 | — | 25,4 | 38 | 11 | 0,56 |
| | | 20L075 | L075020 | 6F | F25 | 20 | 60,64 | 59,88 | 66 | 40 | — | 25,4 | 38 | 11 | 0,59 |
| | | 21L075 | L075021 | 6F | F26 | 21 | 63,67 | 62,91 | 70 | 45 | — | 25,4 | 38 | 11 | 0,64 |
| | | 22L075 | L075022 | 6F | F27 | 22 | 66,70 | 65,94 | 75 | 45 | — | 25,4 | 38 | 11 | 0,69 |
| | | 23L075 | L075023 | 6F | F28 | 23 | 69,73 | 68,97 | 79 | 55 | — | 25,4 | 38 | 11 | 0,76 |
| | | 24L075 | L075024 | 6F | F28 | 24 | 72,77 | 72,00 | 79 | 55 | — | 25,4 | 38 | 11 | 0,87 |
| | | 25L075 | L075025 | 6F | F29 | 25 | 75,80 | 75,04 | 83 | 58 | — | 25,4 | 38 | 11 | 0,95 |
| | | 26L075 | L075026 | 6F | F30 | 26 | 78,83 | 78,07 | 87 | 58 | — | 25,4 | 38 | 11 | 1,06 |
| | | 27L075 | L075027 | 6F | F30 | 27 | 81,86 | 81,10 | 97 | 58 | — | 25,4 | 38 | 11 | 1,18 |
| | | 28L075 | L075028 | 6F | F31 | 28 | 84,89 | 84,13 | 91 | 58 | — | 25,4 | 38 | 11 | 1,19 |
| | | 29L075 | L075029 | 6F | F32 | 29 | 87,93 | 87,16 | 93 | 58 | — | 25,4 | 38 | 11 | 1,25 |
| | | 30L075 | L075030 | 6F | F33 | 30 | 90,96 | 90,20 | 97 | 70 | — | 25,4 | 38 | 11 | 1,33 |
| | | 32L075 | L075032 | 6F | F34 | 32 | 97,02 | 96,26 | 102 | 70 | — | 25,4 | 38 | 11 | 1,54 |
| | | 33L075 | L075033 | 6F | F35 | 33 | 100,05 | 99,29 | 106 | 70 | — | 25,4 | 38 | 11 | 1,63 |
| | | 34L075 | L075034 | 6F | F36 | 34 | 103,08 | 102,32 | 112 | 70 | — | 25,4 | 38 | 11 | 1,37 |
| | | 35L075 | L075035 | 6F | F36 | 35 | 106,12 | 105,35 | 112 | 70 | — | 25,4 | 38 | 11 | 1,80 |
| | | 36L075 | L075036 | 6F | F37 | 36 | 109,15 | 108,39 | 115 | 70 | — | 25,4 | 38 | 11 | 1,89 |
| | | 40L075 | L075040 | 6WF | F40 | 40 | 121,28 | 120,51 | 128 | 70 | 100 | 25,4 | 38 | 11 | 2,35 |
| | | 41L075 | L075041 | 6WF | F41 | 41 | 124,31 | 123,55 | 131 | 70 | 103 | 25,4 | 38 | 11 | 2,40 |
| | | 42L075 | L075042 | 6WF | F42 | 42 | 127,34 | 126,58 | 135 | 70 | 106 | 25,4 | 38 | 11 | 2,53 |
| | | 44L075 | L075044 | 6WF | F45 | 44 | 133,40 | 132,64 | 142 | 70 | 112 | 25,4 | 38 | 11 | 2,75 |
| | | 45L075 | L075045 | 6WF | F45 | 45 | 136,44 | 135,67 | 142 | 70 | 115 | 25,4 | 38 | 11 | 2,86 |
| | | 47L075 | L075047 | 6WF | F48 | 47 | 142,50 | 141,74 | 150 | 70 | 121 | 25,4 | 38 | 11 | 3,02 |
| | | 48L075 | L075048 | 6WF | F48 | 48 | 145,53 | 144,77 | 150 | 70 | 124 | 25,4 | 38 | 11 | 3,19 |
| Ghisa / Cast iron / Grauguss Fonte / Hierro fundido | senza flangia / without flanges ohne Flanschen / sans flasques / sin tapetas | 49L075 | L075049 | 6W | | 49 | 148,56 | 147,80 | — | 70 | 127 | 25,4 | 38 | 14 | 2,10 |
| | | 50L075 | L075050 | 6W | | 50 | 151,60 | 150,83 | — | 70 | 130 | 25,4 | 38 | 14 | 2,20 |
| | | 52L075 | L075052 | 6W | | 52 | 157,66 | 156,90 | — | 70 | 136 | 25,4 | 38 | 14 | 2,38 |
| | | 56L075 | L075056 | 6W | | 56 | 169,79 | 169,02 | — | 70 | 149 | 25,4 | 38 | 14 | 2,49 |
| | | 57L075 | L075057 | 6W | | 57 | 172,82 | 172,06 | — | 70 | 152 | 25,4 | 38 | 14 | 2,73 |
| | | 60L075 | L075060 | 6W | | 60 | 181,91 | 181,15 | — | 75 | 160 | 25,4 | 45 | 14 | 3,44 |
| | | 65L075 | L075065 | 6A | | 65 | 197,07 | 196,31 | — | 75 | 176 | 25,4 | 45 | 14 | 3,50 |
| | | 66L075 | L075066 | 6A | | 66 | 200,11 | 199,34 | — | 75 | 179 | 25,4 | 45 | 14 | 3,60 |
| | | 72L075 | L075072 | 6A | | 72 | 218,30 | 217,53 | — | 75 | 197 | 25,4 | 45 | 14 | 4,58 |
| | | 84L075 | L075084 | 6A | | 84 | 254,68 | 253,92 | — | 75 | 233 | 25,4 | 45 | 14 | 5,60 |
| | | 90L075 | L075090 | 6A | | 90 | 272,87 | 272,11 | — | 75 | 252 | 25,4 | 45 | 14 | 6,50 |
| | | 96L075 | L075096 | 6A | | 96 | 291,06 | 290,30 | — | 75 | 269 | 25,4 | 45 | 14 | 7,00 |
| 120L075 | L075120 | 6A | | 120 | 363,83 | 363,07 | — | 75 | 342 | 25,4 | 45 | 14 | 10,00 | | |

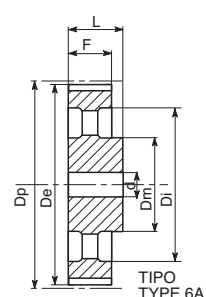
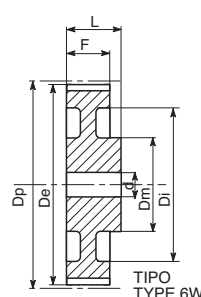
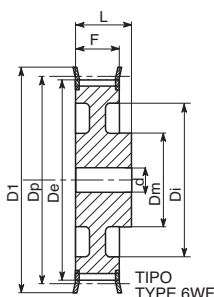
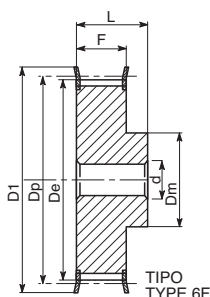

L 100 - 3/8" (9,525 mm)

| Caratteristiche Features Merkmale Características | Codice Code symbol Fabriknummer Code symbole Numero de fabrica | Nostro codice Our code Unser kode Notre code Nuestro codigo | Tipo Type Typ Tipo | Tipo flangia Flanges type Bordscheiben Typ Type flasques Tipo tapetas | N. denti N. of teeth Zahnezahl N. bre de dents Cantidad de dientes | Dp | De | Df | Dm | Di | F | L | Foro stock Stock bore Vor bohrung Alesage en stock Agujero de stock | Peso Weight / Gewicht Poids / Peso Kg |
|--|---|---|-----------------------------|---|--|--------|--------|-----|----|-----|------|----|---|--|
| Acciaio / Steel / Stahl Acier / Acero | con flangia / with flanges mit Flanges / avec flasques / con tapetas | 10L100 | 6F | F13 | 10 | 30,32 | 29,56 | 37 | 20 | — | 31,8 | 45 | 8 | 0,15 |
| | | 11L100 | 6F | F14 | 11 | 33,35 | 32,59 | 38 | 22 | — | 31,8 | 45 | 8 | 0,20 |
| | | 12L100 | 6F | F16 | 12 | 36,38 | 35,62 | 43 | 24 | — | 31,8 | 45 | 8 | 0,26 |
| | | 13L100 | 6F | F17 | 13 | 39,41 | 38,65 | 44 | 28 | — | 31,8 | 45 | 8 | 0,30 |
| | | 14L100 | 6F | F18 | 14 | 42,45 | 41,68 | 48 | 28 | — | 31,8 | 45 | 11 | 0,34 |
| | | 15L100 | 6F | F19 | 15 | 45,48 | 44,72 | 51 | 34 | — | 31,8 | 45 | 11 | 0,45 |
| | | 16L100 | 6F | F20 | 16 | 48,51 | 47,75 | 54 | 36 | — | 31,8 | 45 | 11 | 0,52 |
| | | 17L100 | 6F | F21 | 17 | 51,54 | 50,78 | 57 | 36 | — | 31,8 | 45 | 11 | 0,53 |
| | | 18L100 | 6F | F22 | 18 | 54,57 | 53,81 | 60 | 40 | — | 31,8 | 45 | 11 | 0,62 |
| | | 19L100 | 6F | F24 | 19 | 57,61 | 56,84 | 64 | 40 | — | 31,8 | 45 | 11 | 0,66 |
| | | 20L100 | 6F | F25 | 20 | 60,64 | 59,88 | 66 | 40 | — | 31,8 | 45 | 11 | 0,72 |
| | | 21L100 | 6F | F26 | 21 | 63,67 | 62,91 | 70 | 45 | — | 31,8 | 45 | 11 | 0,77 |
| | | 22L100 | 6F | F27 | 22 | 66,70 | 65,94 | 75 | 45 | — | 31,8 | 45 | 11 | 0,88 |
| | | 23L100 | 6F | F28 | 23 | 69,73 | 68,97 | 79 | 55 | — | 31,8 | 45 | 11 | 1,12 |
| | | 24L100 | 6F | F28 | 24 | 72,77 | 72,00 | 79 | 55 | — | 31,8 | 45 | 11 | 1,13 |
| | | 25L100 | 6F | F29 | 25 | 75,80 | 75,04 | 83 | 58 | — | 31,8 | 45 | 11 | 1,18 |
| | | 26L100 | 6F | F30 | 26 | 78,83 | 78,07 | 87 | 58 | — | 31,8 | 45 | 11 | 1,24 |
| | | 27L100 | 6F | F30 | 27 | 81,86 | 81,10 | 87 | 58 | — | 31,8 | 45 | 11 | 1,35 |
| | | 28L100 | 6F | F31 | 28 | 84,89 | 84,13 | 91 | 58 | — | 31,8 | 45 | 11 | 1,42 |
| | | 29L100 | 6F | F32 | 29 | 87,93 | 87,16 | 93 | 58 | — | 31,8 | 45 | 11 | 1,50 |
| | | 30L100 | 6F | F33 | 30 | 90,96 | 90,20 | 97 | 70 | — | 31,8 | 45 | 11 | 1,61 |
| | | 32L100 | 6F | F34 | 32 | 97,02 | 96,26 | 102 | 70 | — | 31,8 | 45 | 11 | 1,84 |
| | | 33L100 | 6F | F35 | 33 | 100,05 | 99,29 | 106 | 70 | — | 31,8 | 45 | 11 | 1,95 |
| | | 34L100 | 6F | F36 | 34 | 103,08 | 102,32 | 112 | 70 | — | 31,8 | 45 | 11 | 2,10 |
| | | 35L100 | 6F | F36 | 35 | 106,12 | 105,35 | 112 | 70 | — | 31,8 | 45 | 11 | 2,23 |
| | | 36L100 | 6F | F37 | 36 | 109,15 | 108,39 | 115 | 70 | — | 31,8 | 45 | 11 | 2,32 |
| | | 40L100 | 6WF | F40 | 40 | 121,28 | 120,51 | 128 | 70 | 100 | 31,8 | 45 | 11 | 2,80 |
| | | 41L100 | 6WF | F41 | 41 | 124,31 | 123,55 | 131 | 70 | 103 | 31,8 | 45 | 11 | 2,95 |
| | | 42L100 | 6WF | F42 | 42 | 127,34 | 126,58 | 135 | 70 | 106 | 31,8 | 45 | 11 | 3,10 |
| | | 44L100 | 6WF | F45 | 44 | 133,40 | 132,62 | 142 | 70 | 112 | 31,8 | 45 | 11 | 3,36 |
| | | 45L100 | 6WF | F45 | 45 | 136,44 | 135,67 | 142 | 70 | 115 | 31,8 | 45 | 11 | 3,45 |
| | | 47L100 | 6WF | F48 | 47 | 142,50 | 141,74 | 150 | 70 | 121 | 31,8 | 45 | 11 | 3,65 |
| | | 48L100 | 6WF | F48 | 48 | 145,53 | 144,77 | 150 | 70 | 124 | 31,8 | 45 | 11 | 3,86 |
| Ghisa / Cast iron / Grauguss Fonte / Hierro fundido | senza flangia / without flanges ohne Flanschen / sans flasques / sin tapetas | 49L100 | 6W | | 49 | 148,56 | 147,80 | — | 70 | 127 | 31,8 | 45 | 14 | 2,40 |
| | | 50L100 | 6W | | 50 | 151,60 | 150,83 | — | 70 | 130 | 31,8 | 45 | 14 | 2,50 |
| | | 52L100 | 6W | | 52 | 157,66 | 156,90 | — | 70 | 136 | 31,8 | 45 | 14 | 2,70 |
| | | 56L100 | 6W | | 56 | 169,79 | 169,02 | — | 70 | 149 | 31,8 | 45 | 14 | 2,91 |
| | | 57L100 | 6W | | 57 | 172,82 | 172,06 | — | 70 | 152 | 31,8 | 45 | 14 | 3,10 |
| | | 60L100 | 6W | | 60 | 181,91 | 181,15 | — | 75 | 160 | 31,8 | 50 | 14 | 3,55 |
| | | 65L100 | 6A | | 65 | 197,07 | 196,31 | — | 75 | 176 | 31,8 | 50 | 14 | 4,00 |
| | | 66L100 | 6A | | 66 | 200,11 | 199,34 | — | 75 | 179 | 31,8 | 50 | 14 | 4,15 |
| | | 72L100 | 6A | | 72 | 218,30 | 217,53 | — | 75 | 197 | 31,8 | 50 | 14 | 5,00 |
| | | 84L100 | 6A | | 84 | 254,68 | 253,92 | — | 75 | 233 | 31,8 | 50 | 14 | 6,30 |
| | | 90L100 | 6A | | 90 | 272,87 | 272,11 | — | 75 | 252 | 31,8 | 50 | 14 | 7,50 |
| | | 96L100 | 6A | | 96 | 291,06 | 290,30 | — | 75 | 269 | 31,8 | 50 | 14 | 8,20 |
| | | 120L100 | 6A | | 120 | 363,83 | 363,07 | — | 75 | 342 | 31,8 | 50 | 14 | 11,50 |

H 075 - 1/2" (12,75 mm)

| Caratteristiche Features Merkmale Características | Codice Code symbol Fabriknummer Code symbole Numero de fabrica | Nostro codice Our code Unser kode Notre code Nuestro codigo | Tipo Type Typ Tipo | Tipo flangia Flanges type Bordscheiben Typ Type flasques Tipo tapetas | N. denti N. of teeth Zahnezahl N. bre de dents Cantidad de dientes | Dp | De | Df | Dm | Di | F | L | Foro stock Stock bore Vor bohrung Alesage en stock Agujero de stock | Peso Weight / Gewicht Poids / Peso Kg |
|--|---|---|-----------------------------|---|--|--------|--------|-----|----|-----|------|----|---|--|
| Acciaio / Steel / Stahl Acier / Acero | con flangia / with flanges mit Flanges / avec flasques / con tapetas | 14H075 | 6F | F24 | 14 | 56,60 | 55,22 | 64 | 40 | — | 26,4 | 40 | 8 | 0,59 |
| | | 15H075 | 6F | F25 | 15 | 60,64 | 59,27 | 66 | 45 | — | 26,4 | 40 | 8 | 0,65 |
| | | 16H075 | 6F | F26 | 16 | 64,68 | 63,31 | 70 | 45 | — | 26,4 | 40 | 8 | 0,70 |
| | | 17H075 | 6F | F27 | 17 | 68,72 | 67,35 | 75 | 45 | — | 26,4 | 40 | 8 | 0,73 |
| | | 18H075 | 6F | F28 | 18 | 72,77 | 71,39 | 79 | 55 | — | 26,4 | 40 | 11 | 0,91 |
| | | 19H075 | 6F | F29 | 19 | 76,81 | 75,44 | 83 | 60 | — | 26,4 | 40 | 11 | 1,08 |
| | | 20H075 | 6F | F30 | 20 | 80,85 | 79,48 | 87 | 62 | — | 26,4 | 40 | 11 | 1,18 |
| | | 21H075 | 6F | F31 | 21 | 84,89 | 83,52 | 91 | 65 | — | 26,4 | 40 | 11 | 1,30 |
| | | 22H075 | 6F | F32 | 22 | 88,94 | 87,56 | 93 | 68 | — | 26,4 | 40 | 11 | 1,42 |
| | | 23H075 | 6F | F33 | 23 | 92,98 | 91,61 | 97 | 72 | — | 26,4 | 40 | 11 | 1,67 |
| | | 24H075 | 6F | F34 | 24 | 97,02 | 95,65 | 102 | 72 | — | 26,4 | 40 | 11 | 1,71 |
| | | 25H075 | 6F | F35 | 25 | 101,06 | 99,69 | 106 | 72 | — | 26,4 | 40 | 11 | 1,87 |
| | | 26H075 | 6F | F36 | 26 | 105,11 | 103,73 | 112 | 80 | — | 26,4 | 40 | 11 | 2,00 |
| | | 27H075 | 6F | F37 | 27 | 109,15 | 107,78 | 115 | 80 | — | 26,4 | 40 | 11 | 2,10 |
| | | 28H075 | 6F | F38 | 28 | 113,19 | 111,82 | 120 | 80 | — | 26,4 | 40 | 11 | 2,26 |
| | | 29H075 | 6F | F39 | 29 | 117,23 | 115,86 | 123 | 80 | — | 26,4 | 40 | 11 | 2,49 |
| | | 30H075 | 6F | F40 | 30 | 121,28 | 119,90 | 128 | 80 | — | 26,4 | 40 | 11 | 2,70 |
| | | 32H075 | 6F | F42 | 32 | 129,36 | 127,99 | 135 | 80 | — | 26,4 | 40 | 11 | 2,85 |
| | | 33H075 | 6F | F44 | 33 | 133,40 | 132,03 | 140 | 80 | — | 26,4 | 40 | 11 | 3,10 |
| | | 34H075 | 6F | F45 | 34 | 137,45 | 136,07 | 142 | 80 | — | 26,4 | 40 | 11 | 3,30 |
| | | 35H075 | 6F | F48 | 35 | 141,49 | 140,12 | 150 | 80 | — | 26,4 | 40 | 11 | 3,50 |
| | | 36H075 | 6WF | F48 | 36 | 145,53 | 144,16 | 150 | 80 | 118 | 26,4 | 40 | 11 | 3,65 |
| | | 38H075 | 6WF | F50 | 38 | 153,62 | 152,24 | 158 | 80 | 126 | 26,4 | 40 | 11 | 3,90 |
| | | 40H075 | 6WF | F52 | 40 | 161,70 | 160,33 | 168 | 80 | 134 | 26,4 | 40 | 11 | 4,23 |
| | | 42H075 | 6WF | F53 | 42 | 169,79 | 168,41 | 175 | 80 | 140 | 26,4 | 40 | 11 | 4,80 |
| Ghisa / Cast iron / Grauguss Fonte / Hierro fundido | senza flangia / without flanges ohne Flanschen / sans flasques / sin tapetas | 44H075 | 6WF | F55 | 44 | 177,87 | 176,50 | 184 | 80 | 150 | 26,4 | 40 | 14 | 5,20 |
| | | 45H075 | 6WF | F57 | 45 | 181,91 | 180,54 | 192 | 80 | 154 | 26,4 | 40 | 14 | 5,45 |
| | | 48H075 | 6WF | F59 | 48 | 194,04 | 192,67 | 200 | 90 | 166 | 26,4 | 45 | 14 | 4,30 |
| | | 49H075 | 6W | | 49 | 198,08 | 196,71 | — | 90 | 170 | 26,4 | 45 | 14 | 4,50 |
| | | 50H075 | 6W | | 50 | 202,13 | 200,75 | — | 90 | 174 | 26,4 | 45 | 14 | 4,66 |

Pulegge per cinghie dentate / Timing belt pulleys

Zahnriemenscheiben / Poulies pour courroies dentées / Poleas para correas dentadas



H 100 - 1/2" (12,75 mm)

| Caratteristiche Features Merkmale Características | | Codice Code symbol Fabriknummer Code symbole Numero de fabrica | Nostro codice Our code Unser code Notre code Nuestro código | Tipo Type Typ Type Tipo | Tipo flangia Flanges type Bordscheiben Typ Type flasques Tipo tapetas | N. denti N. of teeth Zahnezahl N. bre de dents Cantidad de dientes | Dp | De | Df | Dm | Di | F | L | Foro stock Stock bore Vor bohrung Alesage en stock Agujero de stock | Peso Weight / Gewicht Poids / Peso Kg | | |
|--|---|--|---|-------------------------------------|---|--|--------|--------|--------|--------|-----|------|-------|---|--|----|------|
| Acciaio / Steel / Stahl Acier / Acero | con flangia / with flanges mit Flanges / avec flasques / con tapetas | 14H100 | H100014 | 6F | F24 | 14 | 56,60 | 55,22 | 64 | 45 | — | 31,8 | 45 | 11 | 0,67 | | |
| | | 15H100 | H100015 | 6F | F25 | 15 | 60,64 | 59,27 | 66 | 45 | — | 31,8 | 45 | 11 | 0,77 | | |
| | | 16H100 | H100016 | 6F | F26 | 16 | 64,68 | 63,31 | 70 | 45 | — | 31,8 | 45 | 11 | 0,88 | | |
| | | 17H100 | H100017 | 6F | F27 | 17 | 68,72 | 67,35 | 75 | 45 | — | 31,8 | 45 | 11 | 0,88 | | |
| | | 18H100 | H100018 | 6F | F28 | 18 | 72,77 | 71,39 | 79 | 55 | — | 31,8 | 45 | 14 | 1,06 | | |
| | | 19H100 | H100019 | 6F | F29 | 19 | 76,81 | 75,44 | 83 | 60 | — | 31,8 | 45 | 14 | 1,23 | | |
| | | 20H100 | H100020 | 6F | F30 | 20 | 80,85 | 79,48 | 87 | 62 | — | 31,8 | 45 | 14 | 1,33 | | |
| | | 21H100 | H100021 | 6F | F31 | 21 | 84,89 | 83,52 | 91 | 65 | — | 31,8 | 45 | 14 | 1,43 | | |
| | | 22H100 | H100022 | 6F | F32 | 22 | 88,94 | 87,56 | 93 | 68 | — | 31,8 | 45 | 14 | 1,63 | | |
| | | 23H100 | H100023 | 6F | F33 | 23 | 92,98 | 91,61 | 97 | 72 | — | 31,8 | 45 | 14 | 1,85 | | |
| | | 24H100 | H100024 | 6F | F34 | 24 | 97,02 | 95,65 | 102 | 72 | — | 31,8 | 45 | 14 | 1,93 | | |
| | | 25H100 | H100025 | 6F | F35 | 25 | 101,06 | 99,69 | 106 | 72 | — | 31,8 | 45 | 14 | 2,07 | | |
| | | 26H100 | H100026 | 6F | F36 | 26 | 105,11 | 103,73 | 112 | 80 | — | 31,8 | 45 | 14 | 2,30 | | |
| | | 27H100 | H100027 | 6F | F37 | 27 | 109,15 | 107,78 | 115 | 80 | — | 31,8 | 45 | 14 | 2,40 | | |
| | | 28H100 | H100028 | 6F | F38 | 28 | 113,19 | 111,82 | 120 | 80 | — | 31,8 | 45 | 14 | 2,53 | | |
| | | 29H100 | H100029 | 6F | F39 | 29 | 117,23 | 115,86 | 123 | 80 | — | 31,8 | 45 | 14 | 2,70 | | |
| | | 30H100 | H100030 | 6F | F40 | 30 | 121,28 | 119,90 | 128 | 80 | — | 31,8 | 45 | 14 | 2,93 | | |
| | | 32H100 | H100032 | 6F | F42 | 32 | 129,36 | 127,99 | 135 | 80 | — | 31,8 | 45 | 14 | 3,06 | | |
| | | 33H100 | H100033 | 6F | F44 | 33 | 133,40 | 132,03 | 140 | 80 | — | 31,8 | 45 | 14 | 3,40 | | |
| | | 34H100 | H100034 | 6F | F45 | 34 | 137,45 | 136,07 | 142 | 80 | — | 31,8 | 45 | 14 | 3,57 | | |
| | | 35H100 | H100035 | 6F | F48 | 35 | 141,49 | 140,12 | 150 | 80 | — | 31,8 | 45 | 14 | 3,80 | | |
| | | 36H100 | H100036 | 6WF | F48 | 36 | 145,53 | 144,16 | 150 | 80 | 118 | 31,8 | 45 | 14 | 3,92 | | |
| | | 38H100 | H100038 | 6WF | F50 | 38 | 153,62 | 152,24 | 158 | 80 | 123 | 31,8 | 45 | 14 | 4,40 | | |
| | | 40H100 | H100040 | 6WF | F52 | 40 | 161,70 | 160,33 | 168 | 80 | 134 | 31,8 | 45 | 14 | 4,95 | | |
| | | 42H100 | H100042 | 6WF | F53 | 42 | 169,79 | 168,41 | 175 | 80 | 140 | 31,8 | 45 | 14 | 5,60 | | |
| | | Ghisa / Cast iron / Grauguss Fonte / Hierro fundido | senza flangia / without flanges ohne Flanschen / sans flasques / sin tapetas | 44H100 | H100044 | 6WF | F55 | 44 | 177,87 | 176,50 | 184 | 80 | 150 | 31,8 | 50 | 14 | 6,20 |
| | | | | 45H100 | H100045 | 6WF | F57 | 45 | 181,91 | 180,54 | 192 | 80 | 154 | 31,8 | 50 | 14 | 6,45 |
| | | | | 48H100 | H100048 | 6WF | F59 | 48 | 194,04 | 192,67 | 200 | 90 | 166 | 31,8 | 50 | 14 | 5,30 |
| 49H100 | H100049 | | | 6W | | 49 | 198,08 | 196,71 | — | 90 | 170 | 31,8 | 50 | 19 | 5,40 | | |
| 50H100 | H100050 | | | 6W | | 50 | 202,13 | 200,75 | — | 90 | 174 | 31,8 | 50 | 19 | 5,50 | | |
| 52H100 | H100052 | | | 6W | | 52 | 210,21 | 208,84 | — | 90 | 182 | 31,8 | 50 | 19 | 5,80 | | |
| 58H100 | H100058 | | | 6A | | 58 | 234,47 | 233,09 | — | 90 | 207 | 31,8 | 50 | 19 | 6,20 | | |
| 60H100 | H100060 | | | 6A | | 60 | 242,55 | 241,18 | — | 90 | 215 | 31,8 | 50 | 19 | 7,50 | | |
| 70H100 | H100070 | | | 6A | | 70 | 282,98 | 281,61 | — | 100 | 255 | 31,8 | 55 | 19 | 8,20 | | |
| 72H100 | H100072 | | | 6A | | 72 | 291,06 | 289,69 | — | 100 | 263 | 31,8 | 55 | 19 | 9,00 | | |
| 82H100 | H100082 | | | 6A | | 82 | 331,49 | 330,12 | — | 100 | 304 | 31,8 | 55 | 19 | 9,20 | | |
| 84H100 | H100084 | | | 6A | | 84 | 339,57 | 338,20 | — | 100 | 312 | 31,8 | 55 | 19 | 10,00 | | |
| 94H100 | H100094 | | | 6A | | 94 | 380,00 | 378,63 | — | 120 | 352 | 31,8 | 60 | 19 | 13,00 | | |
| 96H100 | H100096 | | | 6A | | 96 | 388,08 | 386,71 | — | 120 | 360 | 31,8 | 60 | 19 | 13,80 | | |
| 106H100 | H100106 | | | 6A | | 106 | 428,51 | 427,14 | — | 120 | 401 | 31,8 | 60 | 19 | 15,50 | | |
| 116H100 | H100116 | | | 6A | | 116 | 468,93 | 467,56 | — | 120 | 441 | 31,8 | 60 | 19 | 18,00 | | |
| 118H100 | H100118 | | | 6A | | 118 | 477,02 | 475,65 | — | 120 | 449 | 31,8 | 60 | 19 | 20,00 | | |
| 120H100 | H100120 | | | 6A | | 120 | 485,10 | 483,73 | — | 120 | 458 | 31,8 | 60 | 19 | 22,00 | | |
| 150H100 | H100150 | | | 6A | | 150 | 606,38 | 605,01 | — | 120 | 579 | 31,8 | 60 | 19 | 25,00 | | |
| 152H100 | H100152 | | | 6A | | 152 | 614,47 | 613,09 | — | 120 | 587 | 31,8 | 60 | 19 | 26,00 | | |
| 154H100 | H100154 | 6A | | 154 | 622,55 | 621,18 | — | 120 | 595 | 31,8 | 60 | 19 | 27,00 | | | | |
| 156H100 | H100156 | 6A | | 156 | 630,64 | 629,26 | — | 120 | 603 | 31,8 | 60 | 19 | 28,00 | | | | |

H 150 - 1/2" (12,75 mm)

| Caratteristiche Features Merkmale Características | | Codice Code symbol Fabriknummer Code symbole Numero de fabrica | Nostro codice Our code Unser code Notre code Nuestro código | Tipo Type Typ Type Tipo | Tipo flangia Flanges type Bordscheiben Typ Type flasques Tipo tapetas | N. denti N. of teeth Zahnezahl N. bre de dents Cantidad de dientes | Dp | De | Df | Dm | Di | F | L | Foro stock Stock bore Vor bohrung Alesage en stock Agujero de stock | Peso Weight / Gewicht Poids / Peso Kg | | |
|--|---|--|---|-------------------------------------|---|--|--------|--------|--------|--------|-----|------|-----|---|--|----|------|
| Acciaio / Steel / Stahl Acier / Acero | con flangia / with flanges mit Flanges / avec flasques / con tapetas | 14H150 | H150014 | 6F | F24 | 14 | 56,60 | 55,22 | 64 | 42 | — | 46,0 | 58 | 11 | 0,91 | | |
| | | 15H150 | H150015 | 6F | F25 | 15 | 60,64 | 59,27 | 66 | 45 | — | 46,0 | 58 | 11 | 0,99 | | |
| | | 16H150 | H150016 | 6F | F26 | 16 | 64,68 | 63,31 | 70 | 45 | — | 46,0 | 58 | 11 | 1,08 | | |
| | | 17H150 | H150017 | 6F | F27 | 17 | 68,72 | 67,35 | 75 | 45 | — | 46,0 | 58 | 11 | 1,15 | | |
| | | 18H150 | H150018 | 6F | F28 | 18 | 72,77 | 71,39 | 79 | 55 | — | 46,0 | 58 | 14 | 1,45 | | |
| | | 19H150 | H150019 | 6F | F29 | 19 | 76,81 | 75,44 | 83 | 60 | — | 46,0 | 58 | 14 | 1,55 | | |
| | | 20H150 | H150020 | 6F | F30 | 20 | 80,85 | 79,48 | 87 | 62 | — | 46,0 | 58 | 14 | 1,66 | | |
| | | 21H150 | H150021 | 6F | F31 | 21 | 84,89 | 83,52 | 91 | 65 | — | 46,0 | 58 | 14 | 1,87 | | |
| | | 22H150 | H150022 | 6F | F32 | 22 | 88,94 | 87,56 | 93 | 68 | — | 46,0 | 58 | 14 | 2,07 | | |
| | | 23H150 | H150023 | 6F | F33 | 23 | 92,98 | 91,61 | 97 | 72 | — | 46,0 | 58 | 14 | 2,28 | | |
| | | 24H150 | H150024 | 6F | F34 | 24 | 97,02 | 95,65 | 102 | 72 | — | 46,0 | 58 | 14 | 2,50 | | |
| | | 25H150 | H150025 | 6F | F35 | 25 | 101,06 | 99,69 | 106 | 72 | — | 46,0 | 58 | 14 | 2,71 | | |
| | | 26H150 | H150026 | 6F | F36 | 26 | 105,11 | 103,73 | 112 | 80 | — | 46,0 | 58 | 14 | 2,99 | | |
| | | 27H150 | H150027 | 6F | F37 | 27 | 109,15 | 107,78 | 115 | 80 | — | 46,0 | 58 | 14 | 3,15 | | |
| | | 28H150 | H150028 | 6F | F38 | 28 | 113,19 | 111,82 | 120 | 80 | — | 46,0 | 58 | 14 | 3,39 | | |
| | | 29H150 | H150029 | 6F | F39 | 29 | 117,23 | 115,86 | 123 | 80 | — | 46,0 | 58 | 14 | 3,57 | | |
| | | 30H150 | H150030 | 6F | F40 | 30 | 121,28 | 119,90 | 128 | 80 | — | 46,0 | 58 | 14 | 3,86 | | |
| | | 32H150 | H150032 | 6F | F42 | 32 | 129,36 | 127,99 | 135 | 80 | — | 46,0 | 58 | 14 | 4,37 | | |
| | | 33H150 | H150033 | 6F | F44 | 33 | 133,40 | 132,03 | 140 | 80 | — | 46,0 | 58 | 14 | 4,66 | | |
| | | 34H150 | H150034 | 6F | F45 | 34 | 137,45 | 136,07 | 142 | 80 | — | 46,0 | 58 | 14 | 4,98 | | |
| | | 35H150 | H150035 | 6F | F48 | 35 | 141,49 | 140,12 | 150 | 80 | — | 46,0 | 58 | 14 | 5,30 | | |
| | | 36H150 | H150036 | 6WF | F48 | 36 | 145,53 | 144,16 | 150 | 80 | 118 | 46,0 | 58 | 14 | 5,50 | | |
| | | 38H150 | H150038 | 6WF | F50 | 38 | 153,62 | 152,24 | 158 | 80 | 126 | 46,0 | 58 | 14 | 6,10 | | |
| | | 40H150 | H150040 | 6WF | F52 | 40 | 161,70 | 160,33 | 168 | 80 | 134 | 46,0 | 58 | 14 | 6,80 | | |
| | | 42H150 | H150042 | 6WF | F53 | 42 | 169,79 | 168,41 | 175 | 80 | 140 | 46,0 | 58 | 19 | 7,60 | | |
| | | Ghisa / Cast iron / Grauguss Fonte / Hierro fundido | senza flangia / without flanges ohne Flanschen / sans flasques / sin tapetas | 44H150 | H150044 | 6WF | F55 | 44 | 177,87 | 176,50 | 184 | 80 | 150 | 46,0 | 58 | 19 | 8,50 |
| | | | | 45H150 | H150045 | 6WF | F57 | 45 | 181,91 | 180,54 | 192 | 80 | 154 | 46,0 | 58 | 19 | 9,00 |
| | | | | 48H150 | H150048 | 6WF | F59 | 48 | 194,04 | 192,67 | 200 | 90 | 166 | 46,0 | 65 | 19 | 6,70 |
| 49H150 | H150049 | | | 6W | | 49 | 198,08 | 196,71 | — | 90 | 170 | 46,0 | 65 | 19 | 7,00 | | |
| 50H150 | H150050 | | | 6W | | 50 | 202,13 | 200,75 | — | 90 | 174 | 46,0 | 65 | 19 | 7,10 | | |
| 52H150 | H150052 | | | 6W | | 52 | 210,21 | 208,84 | — | 90 | 182 | 46,0 | 65 | 19 | 7,30 | | |
| 58H150 | H150058 | | | 6A | | 58 | 234,47 | 233,09 | — | 90 | 207 | 46,0 | 65 | 19 | 8,10 | | |
| 60H150 | H150060 | | | 6A | | 60 | 242,55 | 241,18 | — | 90 | 215 | 46,0 | 65 | 19 | 9,00 | | |
| 70H150 | H150070 | | | 6A | | 70 | 282,98 | 281,61 | — | 100 | 255 | 46,0 | 65 | 24 | 10,50 | | |
| 72H150 | H150072 | | | 6A | | 72 | 291,06 | 289,69 | — | 100 | 263 | 46,0 | 65 | 24 | 11,00 | | |
| 82H150 | H150082 | | | 6A | | 82 | 331,49 | 330,12 | — | 100 | 304 | 46,0 | 65 | 24 | 12,00 | | |
| 84H150 | H150084 | | | 6A | | 84 | 339,57 | 338,20 | — | 100 | 312 | 46,0 | 65 | 24 | 13,00 | | |
| 94H150 | H150094 | | | 6A | | 94 | 380,00 | 378,63 | — | 120 | 352 | 46,0 | 65 | 24 | 16,00 | | |
| 96H150 | H150096 | | | 6A | | 96 | 388,08 | 386,71 | — | 120 | 360 | 46,0 | 65 | 24 | 17,00 | | |
| 106H150 | H150106 | | | 6A | | 106 | 428,51 | 427,14 | — | 120 | 401 | 46,0 | 65 | 24 | 19,50 | | |
| 116H150 | H150116 | | | 6A | | 116 | 468,93 | 467,56 | — | 120 | 441 | 46,0 | 65 | 24 | 22,00 | | |
| 118H150 | H150118 | | | 6A | | 118 | 477,02 | 475,65 | — | 120 | 449 | 46,0 | 65 | 24 | 23,50 | | |
| 120H150 | H150120 | | | 6A | | 120 | 485,10 | 483,73 | — | 120 | 458 | 46,0 | 65 | 24 | 25,00 | | |
| 150H150 | H150150 | | | 6A | | 150 | 606,38 | 605,01 | — | 120 | 579 | 46,0 | 65 | 24 | 31,50 | | |
| 152H150 | H150152 | | | 6A | | 152 | 614,47 | 613,09 | — | 120 | 587 | 46,0 | 65 | 24 | 33,00 | | |
| 154H150 | H150154 | | | 6A | | 154 | 622,55 | 621,18 | — | 120 | 595 | 46,0 | 65 | 24 | 34,50 | | |
| 156H150 | H150156 | | | 6A | | 156 | 630,64 | 629,26 | — | 120 | 603 | 46,0 | 65 | 24 | 36,00 | | |

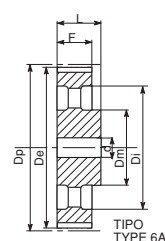
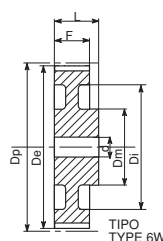
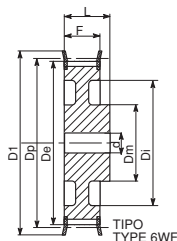
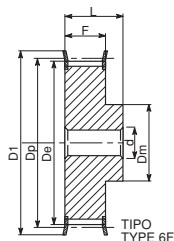

H 200 - 1/2" (12,75 mm)

| Caratteristiche Features Merkmalen Características Características | Codice Code symbol Fabriknummer Code symbole Numero de fabrica | Nostro codice Our code Unser code Notre code Nuestro código | Tipo Type Typ Type Tipo | Tipo flangia Flanges type Bordscheiben Typ Type flasques Tipo tapetas | N. denti N. of teeth Zahnezahl N. bre de dents Cantidad de dientes | Dp | De | Df | Dm | Di | F | L | Foro stock Stock bore Vor bohrung Alesage en stock Agujero de stock | Peso Weight / Gewicht Poids / Peso Kg |
|--|---|---|-------------------------------------|---|--|-----|--------|--------|-----|-----|-----|------|---|--|
| Acciaio / Steel / Stahl Acier / Acero | con flangia / with flanges mit Flanges / avec flasques / con tapetas | 14H200 | H200014 | 6F | F24 | 14 | 56,60 | 55,22 | 64 | 42 | — | 58,7 | 70 | 1,13 |
| | | 15H200 | H200015 | 6F | F25 | 15 | 60,64 | 59,27 | 66 | 45 | — | 58,7 | 70 | 1,21 |
| | | 16H200 | H200016 | 6F | F26 | 16 | 64,68 | 63,31 | 70 | 45 | — | 58,7 | 70 | 1,30 |
| | | 17H200 | H200017 | 6F | F27 | 17 | 68,72 | 67,35 | 75 | 45 | — | 58,7 | 70 | 1,45 |
| | | 18H200 | H200018 | 6F | F28 | 18 | 72,77 | 71,39 | 79 | 55 | — | 58,7 | 70 | 1,65 |
| | | 19H200 | H200019 | 6F | F29 | 19 | 76,81 | 75,44 | 83 | 60 | — | 58,7 | 70 | 1,90 |
| | | 20H200 | H200020 | 6F | F30 | 20 | 80,85 | 79,48 | 87 | 62 | — | 58,7 | 70 | 2,11 |
| | | 21H200 | H200021 | 6F | F31 | 21 | 84,89 | 83,52 | 91 | 65 | — | 58,7 | 70 | 2,23 |
| | | 22H200 | H200022 | 6F | F32 | 22 | 88,94 | 87,56 | 93 | 68 | — | 58,7 | 70 | 2,45 |
| | | 23H200 | H200023 | 6F | F33 | 23 | 92,98 | 91,61 | 97 | 72 | — | 58,7 | 70 | 2,71 |
| | | 24H200 | H200024 | 6F | F34 | 24 | 97,02 | 95,65 | 102 | 72 | — | 58,7 | 70 | 2,97 |
| | | 25H200 | H200025 | 6F | F35 | 25 | 101,06 | 99,69 | 106 | 72 | — | 58,7 | 70 | 3,32 |
| | | 26H200 | H200026 | 6F | F36 | 26 | 105,11 | 103,73 | 112 | 80 | — | 58,7 | 70 | 3,61 |
| | | 27H200 | H200027 | 6F | F37 | 27 | 109,15 | 107,78 | 115 | 80 | — | 58,7 | 70 | 3,90 |
| | | 28H200 | H200028 | 6F | F38 | 28 | 113,19 | 111,82 | 120 | 80 | — | 58,7 | 70 | 4,10 |
| | | 29H200 | H200029 | 6F | F39 | 29 | 117,23 | 115,86 | 123 | 80 | — | 58,7 | 70 | 4,42 |
| | | 30H200 | H200030 | 6F | F40 | 30 | 121,28 | 119,90 | 128 | 80 | — | 58,7 | 70 | 4,74 |
| | | 32H200 | H200032 | 6F | F42 | 32 | 129,36 | 127,99 | 135 | 80 | — | 58,7 | 70 | 5,60 |
| | | 33H200 | H200033 | 6F | F44 | 33 | 133,40 | 132,03 | 140 | 80 | — | 58,7 | 70 | 5,90 |
| | | 34H200 | H200034 | 6F | F45 | 34 | 137,45 | 136,07 | 142 | 80 | — | 58,7 | 70 | 6,20 |
| | | 35H200 | H200035 | 6F | F48 | 35 | 141,49 | 140,12 | 150 | 80 | — | 58,7 | 70 | 6,60 |
| | | 36H200 | H200036 | 6WF | F48 | 36 | 145,53 | 144,16 | 150 | 80 | 118 | 58,7 | 70 | 7,10 |
| | | 38H200 | H200038 | 6WF | F50 | 38 | 153,62 | 152,24 | 158 | 80 | 126 | 58,7 | 70 | 7,80 |
| | | 40H200 | H200040 | 6WF | F52 | 40 | 161,70 | 160,33 | 168 | 80 | 134 | 58,7 | 70 | 8,40 |
| | | 42H200 | H200042 | 6WF | F53 | 42 | 169,79 | 168,41 | 180 | 80 | 140 | 58,7 | 70 | 9,70 |
| | | 44H200 | H200044 | 6WF | F55 | 44 | 177,87 | 176,50 | 184 | 80 | 150 | 58,7 | 70 | 10,50 |
| | | 45H200 | H200045 | 6WF | F57 | 45 | 181,91 | 180,54 | 192 | 80 | 154 | 58,7 | 70 | 11,30 |
| | | 48H200 | H200048 | 6WF | F59 | 48 | 194,04 | 192,67 | 200 | 90 | 166 | 58,7 | 75 | 8,60 |
| Ghisa / Cast iron / Grauguss Fonte / Hierro fundido | senza flangia / without flanges ohne Flanschen / sans flasques / sin tapetas | 49H200 | H200049 | 6W | F48 | 49 | 198,08 | 196,71 | — | 90 | 170 | 58,7 | 75 | 7,60 |
| | | 50H200 | H200050 | 6W | F50 | 50 | 202,13 | 200,75 | — | 90 | 174 | 58,7 | 75 | 8,30 |
| | | 52H200 | H200052 | 6W | F52 | 52 | 210,21 | 208,84 | — | 90 | 182 | 58,7 | 75 | 8,50 |
| | | 58H200 | H200058 | 6A | F24 | 58 | 234,47 | 233,09 | — | 90 | 207 | 85,7 | 75 | 10,00 |
| | | 60H200 | H200060 | 6A | F26 | 60 | 242,55 | 241,18 | — | 90 | 215 | 85,7 | 75 | 11,00 |
| | | 70H200 | H200070 | 6A | F27 | 70 | 282,98 | 281,61 | — | 100 | 255 | 85,7 | 75 | 12,50 |
| | | 72H200 | H200072 | 6A | F28 | 72 | 291,06 | 289,69 | — | 100 | 263 | 85,7 | 75 | 14,00 |
| | | 82H200 | H200082 | 6A | F29 | 82 | 331,49 | 330,12 | — | 100 | 304 | 85,7 | 75 | 13,50 |
| | | 84H200 | H200084 | 6A | F30 | 84 | 339,57 | 338,20 | — | 100 | 312 | 85,7 | 75 | 15,00 |
| | | 94H200 | H200094 | 6A | F31 | 94 | 380,00 | 378,63 | — | 120 | 352 | 85,7 | 75 | 18,90 |
| | | 96H200 | H200096 | 6A | F32 | 96 | 388,08 | 386,71 | — | 120 | 360 | 85,7 | 75 | 20,30 |
| | | 106H200 | H200106 | 6A | F33 | 106 | 428,51 | 427,14 | — | 120 | 401 | 85,7 | 75 | 22,50 |
| | | 116H200 | H200116 | 6A | F34 | 116 | 468,93 | 467,56 | — | 120 | 441 | 85,7 | 75 | 24,70 |
| | | 118H200 | H200118 | 6A | F35 | 118 | 477,02 | 475,65 | — | 120 | 449 | 85,7 | 75 | 26,00 |
| | | 120H200 | H200120 | 6A | F36 | 120 | 485,10 | 483,73 | — | 120 | 458 | 85,7 | 75 | 28,00 |
| | | 150H200 | H200150 | 6A | F37 | 150 | 606,38 | 605,01 | — | 120 | 579 | 85,7 | 75 | 32,50 |
| | | 152H200 | H200152 | 6A | F38 | 152 | 614,47 | 613,09 | — | 120 | 587 | 85,7 | 75 | 35,00 |
| | | 154H200 | H200154 | 6A | F39 | 154 | 622,55 | 621,18 | — | 120 | 595 | 85,7 | 75 | 38,00 |
| | | 156H200 | H200156 | 6A | F40 | 156 | 630,64 | 629,26 | — | 120 | 603 | 85,7 | 75 | 41,00 |

H 300 - 1/2" (12,75 mm)

| Caratteristiche Features Merkmale Características | | Codice Code symbol Fabriknummer Code symbole Numero de fabrica | Nostro codice Our code Unser code Notre code Nuestro código | Tipo Type Typ Type Tipo | Tipo flangia Flanges type Bordscheiben Typ Type flasques Tipo tapetas | N. denti N. of teeth Zahnezahl N. bre de dents Cantidad de dientes | Dp | De | Df | Dm | Di | F | L | Foro stock Stock bore Vor bohrung Alesage en stock Agujero de stock | Peso Weight / Gewicht Poids / Peso Kg | | |
|--|---|--|--|-------------------------------------|---|--|--------|--------|--------|--------|-----|------|-------|---|--|----|-------|
| Acciaio / Steel / Stahl Acier / Acero | con flangia / with flanges mit Flanges / avec flasques / con tapetas | 14H300 | H300014 | 6F | F24 | 14 | 56,60 | 55,22 | 64 | 42 | — | 85,7 | 100 | 11 | 1,35 | | |
| | | 15H300 | H300015 | 6F | F25 | 15 | 60,64 | 59,27 | 66 | 45 | — | 85,7 | 100 | 11 | 1,55 | | |
| | | 16H300 | H300016 | 6F | F26 | 16 | 64,68 | 63,31 | 70 | 45 | — | 85,7 | 100 | 11 | 1,80 | | |
| | | 17H300 | H300017 | 6F | F27 | 17 | 68,72 | 67,35 | 75 | 45 | — | 85,7 | 100 | 11 | 2,10 | | |
| | | 18H300 | H300018 | 6F | F28 | 18 | 72,77 | 71,39 | 79 | 55 | — | 85,7 | 100 | 19 | 2,38 | | |
| | | 19H300 | H300019 | 6F | F29 | 19 | 76,81 | 75,44 | 83 | 60 | — | 85,7 | 100 | 19 | 2,64 | | |
| | | 20H300 | H300020 | 6F | F30 | 20 | 80,85 | 79,48 | 87 | 62 | — | 85,7 | 100 | 19 | 3,10 | | |
| | | 21H300 | H300021 | 6F | F31 | 21 | 84,89 | 83,52 | 91 | 65 | — | 85,7 | 100 | 19 | 3,32 | | |
| | | 22H300 | H300022 | 6F | F32 | 22 | 88,94 | 87,56 | 93 | 68 | — | 85,7 | 100 | 19 | 3,67 | | |
| | | 23H300 | H300023 | 6F | F33 | 23 | 92,98 | 91,61 | 97 | 72 | — | 85,7 | 100 | 19 | 4,00 | | |
| | | 24H300 | H300024 | 6F | F34 | 24 | 97,02 | 95,65 | 102 | 72 | — | 85,7 | 100 | 19 | 4,40 | | |
| | | 25H300 | H300025 | 6F | F35 | 25 | 101,06 | 99,69 | 106 | 72 | — | 85,7 | 100 | 19 | 4,79 | | |
| | | 26H300 | H300026 | 6F | F36 | 26 | 105,11 | 103,73 | 112 | 80 | — | 85,7 | 100 | 19 | 5,20 | | |
| | | 27H300 | H300027 | 6F | F37 | 27 | 109,15 | 107,78 | 115 | 80 | — | 85,7 | 100 | 19 | 5,60 | | |
| | | 28H300 | H300028 | 6F | F38 | 28 | 113,19 | 111,82 | 120 | 80 | — | 85,7 | 100 | 19 | 5,60 | | |
| | | 29H300 | H300029 | 6F | F39 | 29 | 117,23 | 115,86 | 123 | 80 | — | 85,7 | 100 | 19 | 6,00 | | |
| | | 30H300 | H300030 | 6F | F40 | 30 | 121,28 | 119,90 | 128 | 80 | — | 85,7 | 100 | 19 | 7,00 | | |
| | | 32H300 | H300032 | 6F | F42 | 32 | 129,36 | 127,99 | 135 | 80 | — | 85,7 | 100 | 19 | 7,80 | | |
| | | 33H300 | H300033 | 6F | F44 | 33 | 133,40 | 132,03 | 140 | 80 | — | 85,7 | 100 | 19 | 8,70 | | |
| | | 34H300 | H300034 | 6F | F45 | 34 | 137,45 | 136,07 | 142 | 80 | — | 85,7 | 100 | 19 | 9,70 | | |
| | | 35H300 | H300035 | 6F | F48 | 35 | 141,49 | 140,12 | 150 | 80 | — | 85,7 | 100 | 19 | 9,80 | | |
| | | Ghisa / Cast iron / Grauguss Fonte / Hierro fundido | senza flangia / without flanges / ohne flanschen sans flasques / sin tapetas | 36H300 | H300036 | 6WF | F48 | 36 | 145,53 | 144,16 | 150 | 80 | 118 | 85,7 | 100 | 19 | 9,90 |
| | | | | 38H300 | H300038 | 6WF | F50 | 38 | 153,62 | 152,24 | 158 | 80 | 126 | 85,7 | 100 | 19 | 11,00 |
| | | | | 40H300 | H300040 | 6WF | F52 | 40 | 161,70 | 160,33 | 168 | 80 | 134 | 85,7 | 100 | 19 | 12,20 |
| | | | | 42H300 | H300042 | 6WF | F53 | 42 | 169,79 | 168,41 | 180 | 80 | 140 | 85,7 | 100 | 24 | 13,80 |
| 44H300 | H300044 | | | 6WF | F55 | 44 | 177,87 | 176,50 | 184 | 80 | 150 | 85,7 | 100 | 24 | 15,00 | | |
| 45H300 | H300045 | | | 6WF | F57 | 45 | 181,91 | 180,54 | 192 | 80 | 154 | 85,7 | 100 | 24 | 15,20 | | |
| 48H300 | H300048 | | | 6WF | F59 | 48 | 194,04 | 192,67 | 200 | 90 | 166 | 85,7 | 100 | 24 | 17,10 | | |
| 49H300 | H300049 | | | 6W | — | 49 | 198,08 | 196,71 | — | 90 | 170 | 85,7 | 100 | 24 | 9,40 | | |
| 50H300 | H300050 | | | 6W | — | 50 | 202,13 | 200,75 | — | 90 | 174 | 85,7 | 100 | 24 | 10,60 | | |
| 52H300 | H300052 | | | 6W | — | 52 | 210,21 | 208,84 | — | 90 | 182 | 85,7 | 100 | 24 | 11,80 | | |
| 58H300 | H300058 | | | 6A | — | 58 | 234,47 | 233,09 | — | 90 | 207 | 85,7 | 100 | 24 | 12,20 | | |
| 60H300 | H300060 | | | 6A | — | 60 | 242,55 | 241,18 | — | 90 | 215 | 85,7 | 100 | 24 | 13,00 | | |
| 70H300 | H300070 | | | 6A | — | 70 | 282,98 | 281,61 | — | 100 | 255 | 85,7 | 100 | 28 | 16,50 | | |
| 72H300 | H300072 | | | 6A | — | 72 | 291,06 | 289,69 | — | 100 | 263 | 85,7 | 100 | 28 | 19,00 | | |
| 82H300 | H300082 | | | 6A | — | 82 | 331,49 | 330,12 | — | 100 | 304 | 85,7 | 100 | 28 | 18,00 | | |
| 84H300 | H300084 | | | 6A | — | 84 | 339,57 | 338,20 | — | 100 | 312 | 85,7 | 100 | 28 | 20,00 | | |
| 94H300 | H300094 | | | 6A | — | 94 | 380,00 | 378,63 | — | 120 | 352 | 85,7 | 100 | 28 | 25,50 | | |
| 96H300 | H300096 | | | 6A | — | 96 | 388,08 | 386,71 | — | 120 | 360 | 85,7 | 100 | 28 | 27,00 | | |
| 106H300 | H300106 | | | 6A | — | 106 | 428,51 | 427,14 | — | 120 | 401 | 85,7 | 100 | 28 | 27,90 | | |
| 116H300 | H300116 | | | 6A | — | 116 | 468,93 | 467,56 | — | 120 | 441 | 85,7 | 100 | 28 | 28,50 | | |
| 118H300 | H300118 | | | 6A | — | 118 | 477,02 | 475,65 | — | 120 | 449 | 85,7 | 100 | 28 | 31,00 | | |
| 120H300 | H300120 | | | 6A | — | 120 | 485,10 | 483,73 | — | 120 | 458 | 85,7 | 100 | 28 | 33,00 | | |
| 150H300 | H300150 | | | 6A | — | 150 | 606,38 | 605,01 | — | 120 | 579 | 85,7 | 100 | 28 | 38,00 | | |
| 152H300 | H300152 | | | 6A | — | 152 | 614,47 | 613,09 | — | 120 | 587 | 85,7 | 100 | 28 | 40,00 | | |
| 154H300 | H300154 | | | 6A | — | 154 | 622,55 | 621,18 | — | 120 | 595 | 85,7 | 100 | 28 | 42,00 | | |
| 156H300 | H300156 | 6A | — | 156 | 630,64 | 629,26 | — | 120 | 603 | 85,7 | 100 | 28 | 44,20 | | | | |

Pulegge per cinghie dentate / Timing belt pulleys

Zahnriemenscheiben / Poulies pour courroies dentées / Poleas para correas dentadas



XH 200 - 7/8" (22,225 mm)

| Caratteristiche Features Merkmale Características | Codice Code symbol Fabriknummer Code symbole Numero de fábrica | Nostro codice Our code Unser code Notre code Nuestro código | Tipo Type Typ Type Tipo | Tipo flangia Flanges type Bordscheiben Typ Type flasques Tipo tapetas | N. denti N. of teeth Zahnezahl N. bre de dents Cantidad de dientes | Dp | De | Df | Dm | Di | F | L | Foro stock Stock bore Vor bohrung Alesage en stock Agujero de stock | Peso Weight / Gewicht Poids / Peso Kg |
|--|--|---|-------------------------------------|---|--|--------|--------|-----|-----|-----|----|-----|---|--|
| Acciaio / Steel / Stahl Acier / Acero | con flangia / with flanges mit Flanges / avec flasques / con tapetas | 18XH200 | XH20018 | 6F | F44 | 127,34 | 124,55 | 140 | 100 | — | 65 | 80 | 24 | 5,90 |
| | | 19XH200 | XH20019 | 6F | F46 | 134,41 | 131,62 | 146 | 100 | — | 65 | 80 | 24 | 6,50 |
| | | 20XH200 | XH20020 | 6F | F50 | 141,49 | 138,69 | 155 | 100 | — | 65 | 80 | 24 | 7,20 |
| | | 21XH200 | XH20021 | 6F | F51 | 148,56 | 145,77 | 160 | 110 | — | 65 | 80 | 24 | 7,90 |
| | | 22XH200 | XH20022 | 6F | F52 | 155,64 | 152,84 | 168 | 110 | — | 65 | 80 | 24 | 8,70 |
| | | 24XH200 | XH20024 | 6F | F81 | 169,79 | 166,99 | 184 | 120 | — | 65 | 80 | 24 | 10,60 |
| | | 25XH200 | XH20025 | 6F | F56 | 176,86 | 174,07 | 188 | 120 | — | 65 | 80 | 24 | 11,40 |
| | | 26XH200 | XH20026 | 6F | F59 | 183,94 | 181,14 | 200 | 120 | — | 65 | 80 | 24 | 12,20 |
| | | 27XH200 | XH20027 | 6F | F59 | 191,01 | 188,22 | 200 | 120 | — | 65 | 80 | 24 | 13,50 |
| | | 28XH200 | XH20028 | 6F | F61 | 198,08 | 195,29 | 212 | 150 | — | 65 | 80 | 24 | 14,80 |
| | | 30XH200 | XH20030 | 6F | F62 | 212,23 | 209,44 | 226 | 150 | — | 65 | 80 | 24 | 16,60 |
| | | 32XH200 | XH20032 | 6WF | F64 | 226,38 | 223,59 | 240 | 150 | 184 | 65 | 80 | 24 | 17,90 |
| | | 34XH200 | XH20034 | 6WF | F66 | 240,53 | 237,74 | 256 | 150 | 198 | 65 | 80 | 24 | 18,20 |
| | senza flangia / without flanges ohne Flanschen / sans flasques sin tapetas | 38XH200 | XH20038 | 6WF | F69 | 268,83 | 266,03 | 286 | 150 | 227 | 65 | 100 | 28 | 19,00 |
| | | 40XH200 | XH20040 | 6WF | F70 | 282,98 | 280,18 | 296 | 150 | 241 | 65 | 100 | 28 | 22,10 |
| | | 46XH200 | XH20046 | 6VW | | 325,42 | 322,63 | — | 150 | 283 | 65 | 100 | 28 | 26,00 |
| | | 48XH200 | XH20048 | 6VW | | 339,57 | 336,78 | — | 150 | 297 | 65 | 100 | 28 | 27,60 |
| | | 50XH200 | XH20050 | 6VW | | 410,32 | 407,52 | — | 150 | 368 | 65 | 100 | 28 | 27,60 |
| | | 60XH200 | XH20060 | 6VW | | 424,47 | 421,67 | — | 150 | 382 | 65 | 100 | 28 | 22,10 |
| | | 70XH200 | XH20070 | 6A | | 495,21 | 492,42 | — | 190 | 453 | 65 | 100 | 28 | 39,00 |
| | | 72XH200 | XH20072 | 6A | | 509,36 | 506,56 | — | 190 | 467 | 65 | 100 | 28 | 42,00 |
| | | 78XH200 | XH20078 | 6A | | 551,81 | 549,01 | — | 190 | 510 | 65 | 100 | 28 | 48,00 |
| | | 80XH200 | XH20080 | 6A | | 565,95 | 563,16 | — | 190 | 524 | 65 | 100 | 28 | 51,00 |
| | | 82XH200 | XH20082 | 6A | | 580,10 | 577,31 | — | 190 | 538 | 65 | 100 | 28 | 54,00 |
| | | 84XH200 | XH20084 | 6A | | 594,25 | 591,46 | — | 190 | 552 | 65 | 100 | 28 | 57,00 |
| | | 94XH200 | XH20094 | 6A | | 665,00 | 662,20 | — | 190 | 623 | 65 | 100 | 28 | 64,00 |
| | | 96XH200 | XH20096 | 6A | | 679,15 | 676,35 | — | 190 | 637 | 65 | 100 | 28 | 67,00 |
| | | 118XH200 | XH20118 | 6A | | 834,78 | 831,99 | — | 190 | 792 | 65 | 100 | 28 | 88,00 |
| | | 120XH200 | XH20120 | 6A | | 848,93 | 846,14 | — | 190 | 806 | 65 | 100 | 28 | 90,00 |

XH 300 - 7/8" (22,225 mm)

| Caratteristiche Features Merkmale Características | Codice Code symbol Fabriknummer Code symbole Numero de fábrica | Nostro codice Our code Unser code Notre code Nuestro código | Tipo Type Typ Type Tipo | Tipo flangia Flanges type Bordscheiben Typ Type flasques Tipo tapetas | N. denti N. of teeth Zahnezahl N. bre de dents Cantidad de dientes | Dp | De | Df | Dm | Di | F | L | Foro stock Stock bore Vor bohrung Alesage en stock Agujero de stock | Peso Weight / Gewicht Poids / Peso Kg |
|--|--|---|-------------------------------------|---|--|--------|--------|-----|-----|-----|------|-----|---|--|
| Acciaio / Steel / Stahl Acier / Acero | con flangia / with flanges mit Flanges / avec flasques / con tapetas | 18XH300 | XH30018 | 6F | F44 | 127,34 | 124,55 | 140 | 100 | — | 90,5 | 110 | 28 | 8,90 |
| | | 19XH300 | XH30019 | 6F | F46 | 134,41 | 131,62 | 146 | 100 | — | 90,5 | 110 | 28 | 9,20 |
| | | 20XH300 | XH30020 | 6F | F50 | 141,49 | 138,69 | 155 | 100 | — | 90,5 | 110 | 28 | 9,50 |
| | | 21XH300 | XH30021 | 6F | F51 | 148,56 | 145,77 | 160 | 110 | — | 90,5 | 110 | 28 | 10,80 |
| | | 22XH300 | XH30022 | 6F | F52 | 155,64 | 152,84 | 168 | 110 | — | 90,5 | 110 | 28 | 12,10 |
| | | 24XH300 | XH30024 | 6F | F81 | 169,79 | 166,99 | 184 | 120 | — | 90,5 | 110 | 28 | 14,40 |
| | | 25XH300 | XH30025 | 6F | F56 | 176,86 | 174,07 | 188 | 120 | — | 90,5 | 110 | 28 | 15,10 |
| | | 26XH300 | XH30026 | 6F | F59 | 183,94 | 181,14 | 200 | 120 | — | 90,5 | 110 | 28 | 16,70 |
| | | 27XH300 | XH30027 | 6F | F59 | 191,01 | 188,22 | 200 | 120 | — | 90,5 | 110 | 28 | 18,40 |
| | | 28XH300 | XH30028 | 6F | F61 | 198,08 | 195,29 | 212 | 150 | — | 90,5 | 110 | 28 | 20,20 |
| | | 30XH300 | XH30030 | 6F | F62 | 212,23 | 209,44 | 226 | 150 | — | 90,5 | 110 | 28 | 23,80 |
| | | 32XH300 | XH30032 | 6WF | F64 | 226,38 | 223,59 | 240 | 150 | — | 90,5 | 110 | 28 | 26,60 |
| | | 34XH300 | XH30034 | 6WF | F66 | 240,53 | 237,74 | 256 | 150 | 198 | 90,5 | 110 | 28 | 29,40 |
| | senza flangia / without flanges ohne Flanschen / sans flasques sin tapetas | 38XH300 | XH30038 | 6WF | F69 | 268,83 | 266,03 | 286 | 175 | 227 | 90,5 | 120 | 32 | 32,00 |
| | | 40XH300 | XH30040 | 6WF | F70 | 282,98 | 280,18 | 296 | 175 | 241 | 90,5 | 120 | 32 | 37,50 |
| | | 46XH300 | XH30046 | 6VW | | 325,42 | 322,63 | — | 175 | 283 | 90,5 | 120 | 32 | 32,50 |
| | | 48XH300 | XH30048 | 6VW | | 339,57 | 336,78 | — | 175 | 297 | 90,5 | 120 | 32 | 34,00 |
| | | 50XH300 | XH30050 | 6VW | | 410,32 | 407,52 | — | 175 | 368 | 90,5 | 120 | 32 | 37,00 |
| | | 60XH300 | XH30060 | 6VW | | 424,47 | 421,67 | — | 175 | 382 | 90,5 | 120 | 32 | 39,00 |
| | | 70XH300 | XH30070 | 6A | | 495,21 | 492,42 | — | 175 | 453 | 90,5 | 120 | 32 | 53,00 |
| | | 72XH300 | XH30072 | 6A | | 509,36 | 506,56 | — | 175 | 467 | 90,5 | 120 | 32 | 55,00 |
| | | 78XH300 | XH30078 | 6A | | 551,81 | 549,01 | — | 175 | 510 | 90,5 | 120 | 32 | 62,00 |
| | | 80XH300 | XH30080 | 6A | | 565,95 | 563,16 | — | 175 | 524 | 90,5 | 120 | 32 | 64,00 |
| | | 82XH300 | XH30082 | 6A | | 580,10 | 577,31 | — | 175 | 538 | 90,5 | 120 | 32 | 66,00 |
| | | 84XH300 | XH30084 | 6A | | 594,25 | 591,46 | — | 175 | 552 | 90,5 | 120 | 32 | 69,00 |
| | | 94XH300 | XH30094 | 6A | | 665,00 | 662,20 | — | 175 | 623 | 90,5 | 120 | 32 | 81,00 |
| | | 96XH300 | XH30096 | 6A | | 679,15 | 676,35 | — | 175 | 637 | 90,5 | 120 | 32 | 85,00 |
| | | 118XH300 | XH30118 | 6A | | 834,78 | 831,99 | — | 175 | 792 | 90,5 | 120 | 32 | 116,00 |
| | | 120XH300 | XH30120 | 6A | | 848,93 | 846,14 | — | 175 | 806 | 90,5 | 120 | 32 | 121,00 |

XH 400 - 7/8" (22,225 mm)

| Caratteristiche Features Merkmale Características | | Codice Code symbol Fabriknummer Code symbole Numero de fabrica | Nostro codice Our code Unser code Notre code Nuestro código | Tipo Type Typ Type Tipo | Tipo flangia Flanges type Bordscheiben Typ Type flasques Tipo tapetas | N. denti N. of teeth Zahnezahl N. bre de dents Cantidad de dientes | Dp | De | Df | Dm | Di | F | L | Foro stock Stock bore Vor bohrung Alesage en stock Agujero de stock | Peso Weight / Gewicht Poids / Peso Kg |
|---|--|--|---|-------------------------------------|---|--|--------|--------|-----|-----|-----|-----|--------|---|--|
| Acciaio / Steel / Stahl Acier / Acero | con flangia / with flanges mit Flanges / avec flasques / con tapetas | 18XH400 | XH40018 | 6F | F44 | 18 | 127,34 | 124,55 | 140 | 100 | — | 118 | 132 | 32 | 9,50 |
| | | 19XH400 | XH40019 | 6F | F46 | 19 | 134,41 | 131,62 | 146 | 100 | — | 118 | 132 | 32 | 10,65 |
| | | 20XH400 | XH40020 | 6F | F50 | 20 | 141,49 | 138,69 | 154 | 100 | — | 118 | 132 | 32 | 11,80 |
| | | 21XH400 | XH40021 | 6F | F51 | 21 | 148,56 | 145,77 | 160 | 110 | — | 118 | 132 | 32 | 13,20 |
| | | 22XH400 | XH40022 | 6F | F52 | 22 | 155,64 | 152,84 | 168 | 110 | — | 118 | 132 | 32 | 14,73 |
| | | 24XH400 | XH40024 | 6F | F81 | 24 | 169,79 | 166,99 | 184 | 120 | — | 118 | 132 | 32 | 17,80 |
| | | 25XH400 | XH40025 | 6F | F56 | 25 | 176,86 | 174,07 | 192 | 120 | — | 118 | 132 | 32 | 19,40 |
| | | 26XH400 | XH40026 | 6F | F59 | 26 | 183,94 | 181,14 | 200 | 120 | — | 118 | 132 | 32 | 21,10 |
| | | 27XH400 | XH40027 | 6F | F59 | 27 | 191,01 | 188,22 | 200 | 120 | — | 118 | 132 | 32 | 22,80 |
| | | 28XH400 | XH40028 | 6F | F61 | 28 | 198,08 | 195,29 | 211 | 150 | — | 118 | 132 | 32 | 22,60 |
| | | 30XH400 | XH40030 | 6F | F62 | 30 | 212,23 | 209,44 | 226 | 150 | — | 118 | 132 | 32 | 28,70 |
| | | 32XH400 | XH40032 | 6F | F64 | 32 | 226,38 | 223,59 | 240 | 150 | — | 118 | 132 | 32 | 32,50 |
| | | 34XH400 | XH40034 | 6F | F66 | 34 | 240,53 | 237,74 | 256 | 150 | — | 118 | 132 | 32 | 36,50 |
| Ghisa / Cast iron / Grauguss Fonte / Hierro fundido | senza flangia / without flanges ohne Flanschen / sans flasques sin tapetas | 38XH400 | XH40038 | 6WVF | F69 | 38 | 268,83 | 266,03 | 286 | 150 | 227 | 118 | 132 | 32 | 40,00 |
| | | 40XH400 | XH40040 | 6WVF | F70 | 40 | 282,98 | 280,18 | 296 | 150 | 241 | 118 | 132 | 32 | 32,90 |
| | | 46XH400 | XH40046 | 6W | | 46 | 325,42 | 322,63 | — | 175 | 283 | 118 | 132 | 32 | 38,00 |
| | | 48XH400 | XH40048 | 6W | | 48 | 339,57 | 336,78 | — | 175 | 297 | 118 | 132 | 32 | 41,00 |
| | | 50XH400 | XH40050 | 6W | | 50 | 410,32 | 407,52 | — | 175 | 368 | 118 | 132 | 32 | 46,00 |
| | | 60XH400 | XH40060 | 6W | | 60 | 424,47 | 421,67 | — | 175 | 382 | 118 | 132 | 32 | 47,00 |
| | | 70XH400 | XH40070 | 6A | | 70 | 495,21 | 492,42 | — | 175 | 453 | 118 | 132 | 32 | 66,00 |
| | | 72XH400 | XH40072 | 6A | | 72 | 509,36 | 506,56 | — | 175 | 467 | 118 | 132 | 32 | 68,00 |
| | | 78XH400 | XH40078 | 6A | | 78 | 551,81 | 549,01 | — | 175 | 510 | 118 | 132 | 32 | 71,00 |
| | | 80XH400 | XH40080 | 6A | | 80 | 565,95 | 563,16 | — | 175 | 524 | 118 | 132 | 32 | 73,00 |
| | | 82XH400 | XH40082 | 6A | | 82 | 580,10 | 577,31 | — | 175 | 538 | 118 | 132 | 32 | 74,50 |
| | | 84XH400 | XH40084 | 6A | | 84 | 594,25 | 591,46 | — | 175 | 552 | 118 | 132 | 32 | 78,00 |
| | | 94XH400 | XH40094 | 6A | | 94 | 665,00 | 662,20 | — | 175 | 623 | 118 | 132 | 32 | 86,00 |
| 96XH400 | XH40096 | 6A | | 96 | 679,15 | 676,35 | — | 175 | 637 | 118 | 132 | 32 | 98,00 | | |
| 118XH400 | XH40118 | 6A | | 118 | 834,78 | 831,99 | — | 175 | 792 | 118 | 132 | 32 | 142,00 | | |
| 120XH400 | XH40120 | 6A | | 120 | 848,93 | 846,14 | — | 175 | 806 | 118 | 132 | 32 | 156,00 | | |

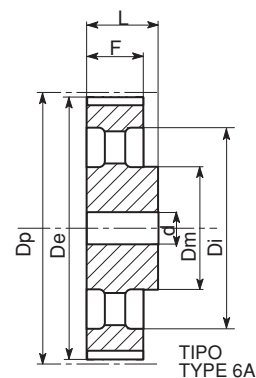
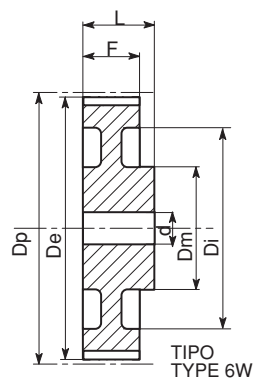
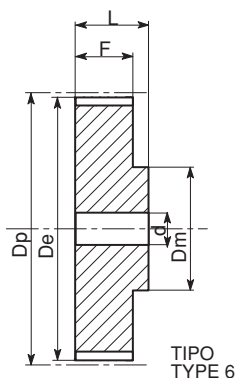
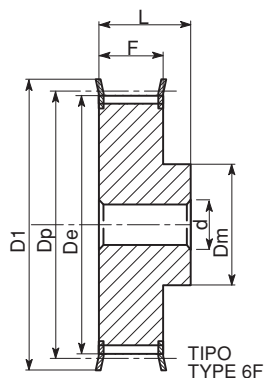

XXH 200 - 1" 1/4 (31,750 mm)

| Caratteristiche Features Merkmal Características | Codice Code symbol Fabriknummer Code symbole Numero de fabrica | Nostro codice Our code Unser kode Notre code Nuestro codigo | Tipo Type Typ Type Tipo | Tipo flangia Flanges type Bordscheiben Typ Type flasques Tipo tapetas | N. denti N. of teeth Zahnezahl N. bre de dents Cantidad de dientes | Dp | De | Df | Dm | Di | F | L | Foro stock Stock bore Vorbohrung Alesage en stock Agujero de stock | Peso Weight / Gewicht Poids / Peso Kg |
|---|--|---|-------------------------------------|---|--|----|--------|--------|-----|-----|-----|------|--|--|
| Acciaio / Steel / Stahl Acier / Acero | con flangia / with flanges mit Flanges / avec flasques con tapetas | 18XXH200 | XXH2018 | 6F | F58 | 18 | 181,91 | 178,87 | 198 | 140 | — | 64,2 | 100 | 14,2 |
| | | 19XXH200 | XXH2019 | 6F | F60 | 19 | 192,02 | 188,97 | 205 | 140 | — | 64,2 | 100 | 15,8 |
| | | 20XXH200 | XXH2020 | 6F | F61 | 20 | 202,13 | 199,08 | 212 | 150 | — | 64,2 | 100 | 17,3 |
| | | 21XXH200 | XXH2021 | 6F | F62 | 21 | 212,23 | 209,19 | 226 | 150 | — | 64,2 | 100 | 18,5 |
| | | 22XXH200 | XXH2022 | 6F | F64 | 22 | 222,34 | 219,29 | 240 | 150 | — | 64,2 | 100 | 20,0 |
| Ghisa / Cast iron / Grauguss Fonte / Hierro fundido | senza flangia / without flanges ohne Flanschen / sans flasques sin tapetas | 24XXH200 | XXH2024 | 6 | | 24 | 242,55 | 239,50 | — | 150 | — | 64,2 | 100 | 23,6 |
| | | 25XXH200 | XXH2025 | 6W | | 25 | 252,66 | 249,61 | — | 150 | 196 | 64,2 | 100 | 18,0 |
| | | 26XXH200 | XXH2026 | 6W | | 26 | 262,76 | 259,79 | — | 150 | 207 | 64,2 | 100 | 20,0 |
| | senza flangia / without flanges ohne Flanschen / sans flasques sin tapetas | 27XXH200 | XXH2027 | 6W | | 27 | 272,87 | 269,82 | — | 150 | 216 | 64,2 | 100 | 24,0 |
| | | 30XXH200 | XXH2030 | 6W | | 30 | 303,19 | 300,14 | — | 150 | 247 | 64,2 | 100 | 26,0 |
| | | 34XXH200 | XXH2034 | 6W | | 34 | 343,62 | 340,57 | — | 150 | 287 | 64,2 | 100 | 31,8 |
| | | 40XXH200 | XXH2040 | 6W | | 40 | 404,25 | 401,21 | — | 150 | 348 | 64,2 | 100 | 43,0 |
| | | 48XXH200 | XXH2048 | 6W | | 48 | 485,10 | 482,06 | — | 175 | 429 | 64,2 | 100 | 60,4 |
| | | 60XXH200 | XXH2060 | 6A | | 60 | 606,38 | 603,33 | — | 175 | 547 | 64,2 | 120 | 100,0 |
| | | 72XXH200 | XXH2072 | 6A | | 72 | 727,66 | 724,61 | — | 175 | 668 | 64,2 | 120 | 130,0 |
| | | 90XXH200 | XXH2090 | 6A | | 90 | 909,57 | 906,52 | — | 175 | 850 | 64,2 | 120 | 156,0 |

XXH 300 - 1" 1/4 (31,750 mm)

| Caratteristiche Features Merkmal Características | Codice Code symbol Fabriknummer Code symbole Numero de fabrica | Nostro codice Our code Unser kode Notre code Nuestro codigo | Tipo Type Typ Type Tipo | Tipo flangia Flanges type Bordscheiben Typ Type flasques Tipo tapetas | N. denti N. of teeth Zahnezahl N. bre de dents Cantidad de dientes | Dp | De | Df | Dm | Di | F | L | Foro stock Stock bore Vorbohrung Alesage en stock Agujero de stock | Peso Weight / Gewicht Poids / Peso Kg |
|---|--|---|-------------------------------------|---|--|----|--------|--------|-----|-----|-----|------|--|--|
| Acciaio / Steel / Stahl Acier / Acero | con flangia / with flanges mit Flanges / avec flasques con tapetas | 18XXH300 | XXH30018 | 6F | F58 | 18 | 181,91 | 178,87 | 198 | 140 | — | 91,4 | 110 | 16,0 |
| | | 19XXH300 | XXH30019 | 6F | F60 | 19 | 192,02 | 188,97 | 205 | 140 | — | 91,4 | 110 | 18,4 |
| | | 20XXH300 | XXH30020 | 6F | F61 | 20 | 202,13 | 199,08 | 212 | 150 | — | 91,4 | 110 | 20,4 |
| | | 21XXH300 | XXH30021 | 6F | F62 | 21 | 212,23 | 209,19 | 226 | 150 | — | 91,4 | 110 | 22,0 |
| | | 22XXH300 | XXH30022 | 6F | F64 | 22 | 222,34 | 219,29 | 240 | 150 | — | 91,4 | 110 | 25,0 |
| Ghisa / Cast iron / Grauguss Fonte / Hierro fundido | senza flangia / without flanges ohne Flanschen / sans flasques sin tapetas | 24XXH300 | XXH30024 | 6 | | 24 | 242,55 | 239,50 | — | 150 | — | 91,4 | 110 | 29,2 |
| | | 25XXH300 | XXH30025 | 6W | | 25 | 252,66 | 249,61 | — | 150 | 196 | 91,4 | 110 | 24,6 |
| | | 26XXH300 | XXH30026 | 6W | | 26 | 262,76 | 259,79 | — | 150 | 207 | 91,4 | 110 | 27,0 |
| | senza flangia / without flanges ohne Flanschen / sans flasques sin tapetas | 27XXH300 | XXH30027 | 6W | | 27 | 272,87 | 269,82 | — | 150 | 216 | 91,4 | 110 | 29,0 |
| | | 30XXH300 | XXH30030 | 6W | | 30 | 303,19 | 300,14 | — | 150 | 247 | 91,4 | 110 | 31,0 |
| | | 34XXH300 | XXH30034 | 6W | | 34 | 343,62 | 340,57 | — | 150 | 287 | 91,4 | 110 | 39,0 |
| | | 40XXH300 | XXH30040 | 6W | | 40 | 404,25 | 401,21 | — | 150 | 348 | 91,4 | 110 | 45,0 |
| | | 48XXH300 | XXH30048 | 6W | | 48 | 485,10 | 482,06 | — | 175 | 429 | 91,4 | 110 | 60,0 |
| | | 60XXH300 | XXH30060 | 6A | | 60 | 606,38 | 603,33 | — | 175 | 547 | 91,4 | 120 | 100,0 |
| | | 72XXH300 | XXH30072 | 6A | | 72 | 727,66 | 724,61 | — | 175 | 668 | 91,4 | 120 | 135,0 |
| | | 90XXH300 | XXH30090 | 6A | | 90 | 909,57 | 906,52 | — | 175 | 850 | 91,4 | 120 | 160,0 |

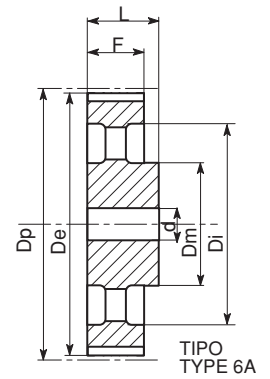
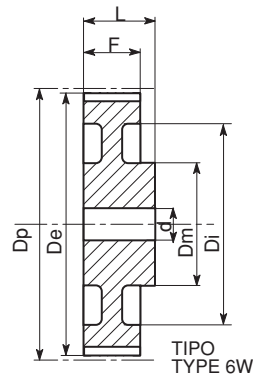
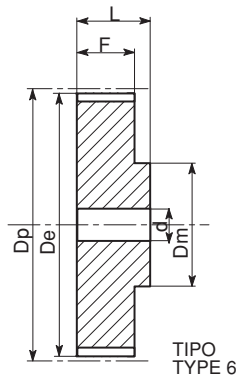
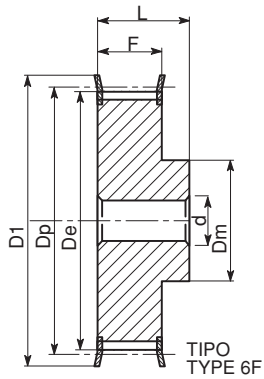

XXH 400 - 1" 1/4 (31,750 mm)

| Caratteristiche Features Merkmal Características | Codice Code symbol Fabriknummer Code symbole Numero de fabrica | Nostro codice Our code Unser kode Notre code Nuestro codigo | Tipo Type Typ Type Tipo | Tipo flangia Flanges type Bordscheiben Typ Type flasques Tipo tapetas | N. denti N. of teeth Zahnezahl N. bre de dents Cantidad de dientes | Dp | De | Df | Dm | Di | F | L | Foro stock Stock bore Vorbohrung Alesage en stock Agujero de stock | Peso Weight / Gewicht Poids / Peso Kg |
|---|--|---|-------------------------------------|---|--|----|--------|--------|-----|-----|-----|-------|--|--|
| Acciaio / Steel / Stahl Acier / Acero | con flangia / with flanges mit Flanges / avec flasques con tapetas | 18XXH400 | XXH4018 | 6F | F58 | 18 | 181,91 | 178,87 | 198 | 140 | — | 120,7 | 140 | 20,8 |
| | | 19XXH400 | XXH4019 | 6F | F60 | 19 | 192,02 | 188,97 | 205 | 140 | — | 120,7 | 140 | 24,0 |
| | | 20XXH400 | XXH4020 | 6F | F61 | 20 | 202,13 | 199,08 | 212 | 150 | — | 120,7 | 140 | 26,0 |
| | | 21XXH400 | XXH4021 | 6F | F62 | 21 | 212,23 | 209,19 | 226 | 150 | — | 120,7 | 140 | 28,5 |
| | | 22XXH400 | XXH4022 | 6F | F64 | 22 | 222,34 | 219,29 | 240 | 150 | — | 120,7 | 140 | 31,6 |
| Ghisa / Cast iron / Grauguss Fonte / Hierro fundido | senza flangia / without flanges ohne Flanschen / sans flasques sin tapetas | 24XXH400 | XXH4024 | 6 | | 24 | 242,55 | 239,50 | — | 150 | — | 120,7 | 140 | 35,0 |
| | | 25XXH400 | XXH4025 | 6W | | 25 | 252,66 | 249,61 | — | 150 | 196 | 120,7 | 140 | 28,0 |
| | | 26XXH400 | XXH4026 | 6W | | 26 | 262,76 | 259,79 | — | 150 | 207 | 120,7 | 140 | 32,4 |
| | senza flangia / without flanges ohne Flanschen / sans flasques sin tapetas | 27XXH400 | XXH4027 | 6W | | 27 | 272,87 | 269,82 | — | 150 | 216 | 120,7 | 140 | 34,0 |
| | | 30XXH400 | XXH4030 | 6W | | 30 | 303,19 | 300,14 | — | 185 | 247 | 120,7 | 140 | 36,0 |
| | | 34XXH400 | XXH4034 | 6W | | 34 | 343,62 | 340,57 | — | 185 | 287 | 120,7 | 140 | 47,6 |
| | | 40XXH400 | XXH4040 | 6W | | 40 | 404,25 | 401,21 | — | 185 | 348 | 120,7 | 140 | 65,0 |
| | | 48XXH400 | XXH4048 | 6W | | 48 | 485,10 | 482,06 | — | 185 | 429 | 120,7 | 140 | 80,5 |
| | | 60XXH400 | XXH4060 | 6A | | 60 | 606,38 | 603,33 | — | 185 | 547 | 120,7 | 140 | 108,0 |
| | | 72XXH400 | XXH4072 | 6A | | 72 | 727,66 | 724,61 | — | 220 | 668 | 120,7 | 140 | 140,0 |
| | | 90XXH400 | XXH4090 | 6A | | 90 | 909,57 | 906,52 | — | 220 | 850 | 120,7 | 140 | 170,0 |

XXH 500 - 1" 1/4 (31,750 mm)

| Caratteristiche Features Merkmal Características | Codice Code symbol Fabriknummer Code symbole Numero de fabrica | Nostro codice Our code Unser kode Notre code Nuestro codigo | Tipo Type Typ Type Tipo | Tipo flangia Flanges type Bordscheiben Typ Type flasques Tipo tapetas | N. denti N. of teeth Zahnezahl N. bre de dents Cantidad de dientes | Dp | De | Df | Dm | Di | F | L | Foro stock Stock bore Vorbohrung Alesage en stock Agujero de stock | Peso Weight / Gewicht Poids / Peso Kg |
|---|--|---|-------------------------------------|---|--|----|--------|--------|-----|-----|-----|-------|--|--|
| Acciaio / Steel / Stahl Acier / Acero | con flangia / with flanges mit Flanges / avec flasques con tapetas | 18XXH500 | XXH5018 | 6F | F58 | 18 | 181,91 | 178,87 | 198 | 140 | — | 145,3 | 168 | 24,0 |
| | | 19XXH500 | XXH5019 | 6F | F60 | 19 | 192,02 | 188,97 | 205 | 140 | — | 145,3 | 168 | 28,0 |
| | | 20XXH500 | XXH5020 | 6F | F61 | 20 | 202,13 | 199,08 | 212 | 150 | — | 145,3 | 168 | 31,4 |
| | | 21XXH500 | XXH5021 | 6F | F62 | 21 | 212,23 | 209,19 | 226 | 150 | — | 145,3 | 168 | 34,0 |
| | | 22XXH500 | XXH5022 | 6F | F64 | 22 | 222,34 | 219,29 | 240 | 150 | — | 145,3 | 168 | 38,3 |
| Ghisa / Cast iron / Grauguss Fonte / Hierro fundido | senza flangia / without flanges ohne Flanschen / sans flasques sin tapetas | 24XXH500 | XXH5024 | 6 | | 24 | 242,55 | 239,50 | — | 150 | — | 145,3 | 168 | 45,0 |
| | | 25XXH500 | XXH5025 | 6W | | 25 | 252,66 | 249,61 | — | 150 | 196 | 145,3 | 168 | 36,0 |
| | | 26XXH500 | XXH5026 | 6W | | 26 | 262,76 | 259,79 | — | 150 | 207 | 145,3 | 168 | 37,5 |
| | senza flangia / without flanges ohne Flanschen / sans flasques sin tapetas | 27XXH500 | XXH5027 | 6W | | 27 | 272,87 | 269,82 | — | 150 | 216 | 145,3 | 168 | 42,0 |
| | | 30XXH500 | XXH5030 | 6W | | 30 | 303,19 | 300,14 | — | 215 | 247 | 145,3 | 168 | 46,8 |
| | | 34XXH500 | XXH5034 | 6W | | 34 | 343,62 | 340,57 | — | 215 | 287 | 145,3 | 168 | 57,0 |
| | | 40XXH500 | XXH5040 | 6W | | 40 | 404,25 | 401,21 | — | 215 | 348 | 145,3 | 168 | 68,0 |
| | | 48XXH500 | XXH5048 | 6W | | 48 | 485,10 | 482,06 | — | 215 | 429 | 145,3 | 168 | 88,8 |
| | | 60XXH500 | XXH5060 | 6A | | 60 | 606,38 | 603,33 | — | 240 | 547 | 145,3 | 120 | 99,8 |
| | | 72XXH500 | XXH5072 | 6A | | 72 | 727,66 | 724,61 | — | 240 | 668 | 145,3 | 120 | 172,0 |
| | | 90XXH500 | XXH5090 | 6A | | 90 | 909,57 | 906,52 | — | 240 | 850 | 145,3 | 120 | 242,5 |