



High Performance from Rexnord

**Marine diesel version**



**Maximum  
operating  
reliability**

## Marine diesel version

High Performance from Rexnord.

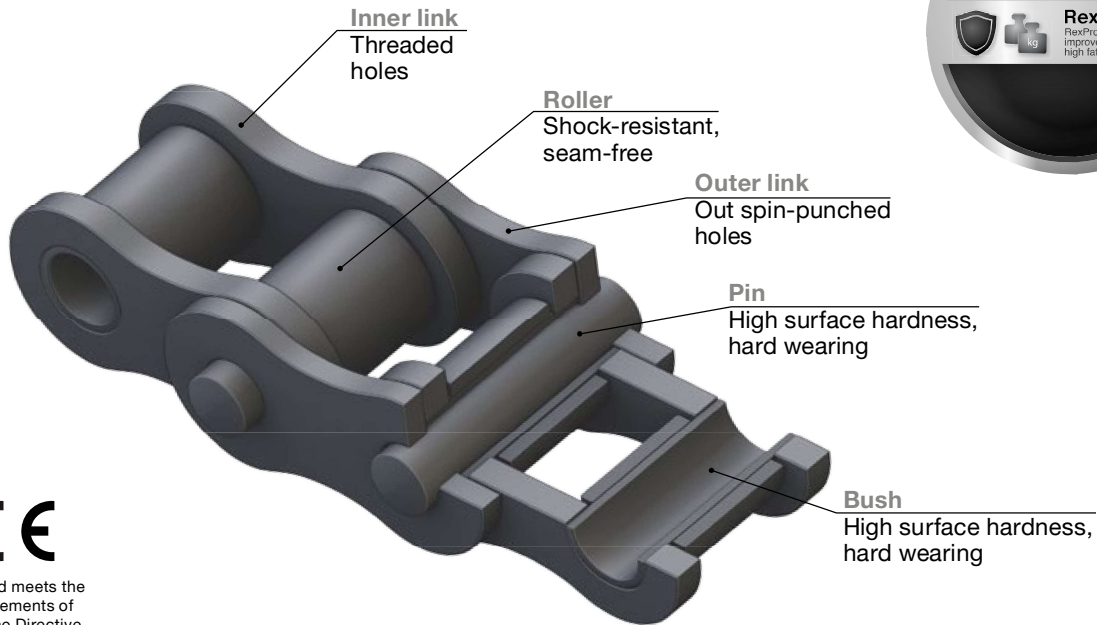

Rexnord meets the requirements of Machine Directive 2006/42/EC

### APPLICATIONS

- Steelmaking industry e.g. looping towers
- Heavy mechanical engineering
- Marine diesel timing chains

### CHARACTERISTICS

- High-precision adjustability
- Special Rexnord inner link contour for outstanding fatigue resistance
- Optimum operating reliability

### ADVANTAGES

- Suitable for use where other roller chains have reached their performance limit
- Long service life
- Optimum running-in performance

### LUBRICATION

- RexPro lubrication without heavy metals for improved protection
- Operating temperature: -30°C to +130°C (can be extended from -40°C to +250°C)
- Very good surface adhesion; remains drip resistant even at high temperatures
- No heavy metals, Teflon- and silicone-free

## RexPro - High performance from Rexnord



### Excellent Corrosion Protection

- 8 - 10 times better than the best competitors
- More than 100 % better in the buckling test
- Highly versatile, also suitable for aggressive environments



### Improved Wear Resistance

- 8 - 12 % improvement in comparison to predecessor
- Great protection through RexPro lubrication
- Long working life
- High operating reliability



### High Fatigue Resistance

- Ball-drifted plate holes
- Shot-peened chain links, seam-free rollers
- High pre-loading



### Eco friendly

- Through RexPro lubrication
- No heavy metals; Teflon- and silicone-free
- Environmental management system conforms to DIN EN ISO 14001

## Salt spray test in accordance with DIN EN ISO 9227

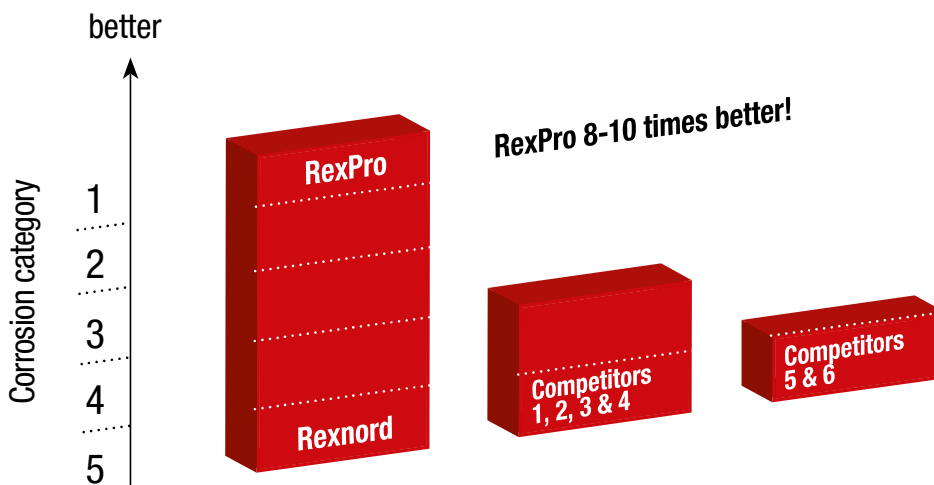

Rexnord meets the requirements of Machine Directive 2006/42/EC

## Marine diesel version

High Performance from Rexnord.

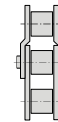

### Simplex roller chains



**CE**  
Rexnord meets the  
requirements of  
Machine Directive  
2006/42/EC



#### Excellent Corrosion Protection

- 8 - 10 times better than the best competitors
- More than 100 % better in the buckling test
- Highly versatile, also suitable for aggressive environments



#### Improved Wear Resistance

- 8 - 12 % improvement in comparison to predecessor
- Great protection through RexPro lubrication
- Long working life
- High operating reliability



#### High Fatigue Resistance

- Ball-drifted plate holes
- Shot-peened chain links, seam-free rollers
- High pre-loading



#### Eco friendly

- Through RexPro lubrication
- No heavy metals; Teflon- and silicone-free
- Environmental management system conforms to DIN EN ISO 14001

## Simplex roller chains, DIN ISO 606 (DIN 8187) (Marine-Diesel)

Chain No.	Pitch		Width between inner plates	Roller diameter	Pin diameter	Width over inner link	Plate depth	Transverse pitch	Pin length	Bearing area	Required minimum breaking strength DIN / ISO	Weight
	p											
	b <sub>1</sub> min	d <sub>1</sub> max	d <sub>2</sub> max	b <sub>2</sub> max	g	a <sub>1</sub> max	a <sub>3</sub> max	A	F <sub>U</sub>	q		
	Inch	mm	mm	mm	mm	mm	mm	mm	mm	cm <sup>2</sup>	N	kg/m
32 B - 1 M	2.00	50.8	30.99	29.21	17.81	45.5	41.2	-	65.1	8.10	250 000	9.5
40 B - 1 M	2.50	63.5	38.10	39.37	22.89	55.7	55.3	-	82.6	12.7	355 000	17.0
48 B - 1 M	3.00	76.2	45.72	48.26	29.24	70.5	65.3	-	98.5	20.6	560 000	26.0
56 B - 1 M	3.50	88.9	53.34	53.98	34.32	81.3	80.3	-	114.0	27.9	850 000	37.0
64 B - 1 M	4.00	101.6	60.96	63.50	39.40	92.0	93.3	-	130.0	36.2	1 120 000	50.0
72 B - 1 M	4.50	114.3	68.58	72.39	44.50	103.0	105.3	-	147.0	46.2	1 400 000	65.0

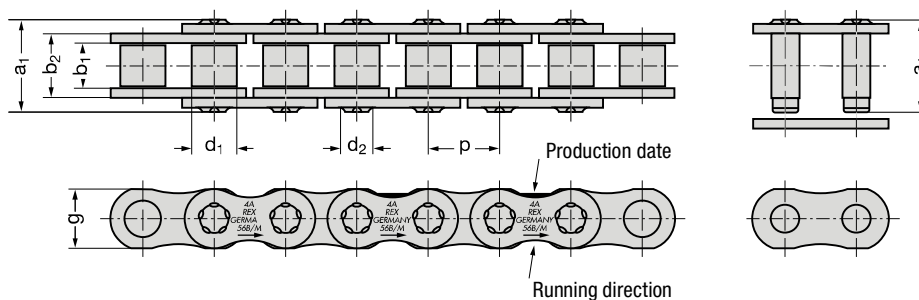



## Marine diesel version

High Performance from Rexnord.

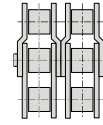

### Duplex roller chains



#### Excellent Corrosion Protection

- 8 - 10 times better than the best competitors
- More than 100 % better in the buckling test
- Highly versatile, also suitable for aggressive environments



#### Improved Wear Resistance

- 8 - 12 % improvement in comparison to predecessor
- Great protection through RexPro lubrication
- Long working life
- High operating reliability



#### High Fatigue Resistance

- Ball-drifted plate holes
- Shot-peened chain links, seam-free rollers
- High pre-loading



#### Eco friendly

- Through RexPro lubrication
- No heavy metals; Teflon- and silicone-free
- Environmental management system conforms to DIN EN ISO 14001



Rexnord meets the requirements of Machine Directive 2006/42/EC

### Duplex roller chains, DIN ISO 606 (DIN 8187) (Marine-Diesel)

Chain No.	Pitch		Width between inner plates	Roller diameter	Pin diameter	Width over inner link	Plate depth	Transverse pitch	Pin length	Bearing area	Required minimum tensile strength DIN/ISO	Weight
	p		b <sub>1</sub> min	d <sub>1</sub> max	d <sub>2</sub> max	b <sub>2</sub> max	g	e	a <sub>1</sub> max	A	F <sub>U</sub>	q
	Inch	mm	mm	mm	mm	mm	mm	mm	mm	cm <sup>2</sup>	N	kg/m
40 B - 2 M	2.50	63.5	38.10	39.37	22.89	55.7	55.3	72.29	154.0	25.5	630 000	34.0
48 B - 2 M	3.00	76.2	45.72	48.26	29.24	70.5	65.3	91.21	190.0	41.2	1 000 000	53.0
56 B - 2 M	4.50	88.9	53.34	53.98	34.32	81.3	80.3	106.60	221.0	55.8	1 600 000	74.0
64 B - 2 M	4.00	101.6	60.96	63.50	39.40	92.0	93.3	119.89	250.0	72.5	2 000 000	98.0
72 B - 2 M	4.50	114.3	68.58	72.39	44.50	103.0	105.3	136.27	283.0	92.4	2 500 000	128.0

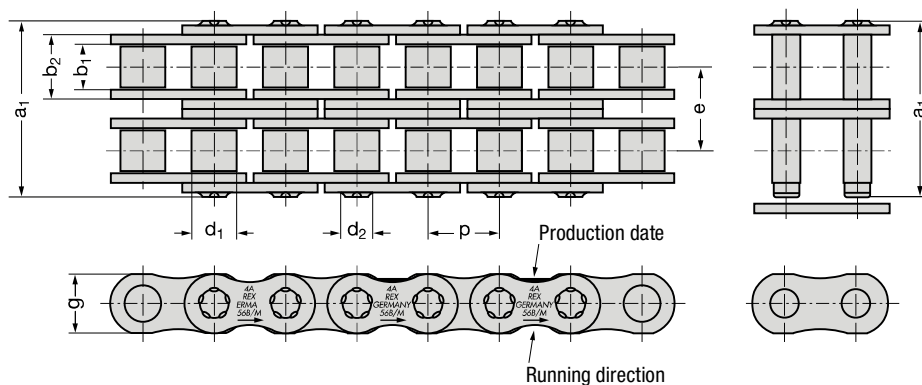

## Connecting dimensions for roller chains, European and American types

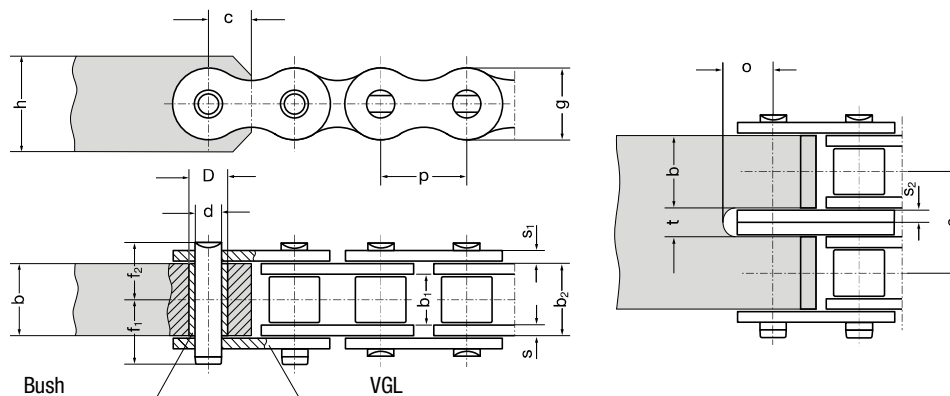

- Required material hardness of fixing elements: at least 490 N/mm<sup>2</sup>
- To increase wear resistance, fit a bush (surface hardness rating approx. 60 HRC) to the connecting element, if joint mobility is required at the connection point.
- Hardened bushes are not required in case of static loading
- Please order bushes using the corresponding bush part no.
- The bush bore diameters  $d^{C10}$  result from press-fitting in bore diameter  $D^{S7}$
- If no bushes are fitted, the bore  $d^{C10}$  is inserted directly into the connection element

### Connecting dimensions for roller chains, European type, DIN ISO 606 (DIN 8187)

Chain No.	Pitch		Width between inner plates	Width over inner link	Plate thickness														Bore Ø					Bush part no.
	p	b <sub>1</sub> min	b <sub>2</sub> max	s	s <sub>1</sub>	s <sub>2</sub>	g	e	f <sub>1</sub>	f <sub>2</sub>	h	b max	c	d C10	D S7	t	o							
	inch	mm	mm	mm	mm	mm	mm	mm	mm	mm	mm	mm	mm	mm	mm	mm	mm	mm						
08 B	0.50	12.70	7.75	11.30	1.70	1.70	1.25	11.60	13.92	10.30	8.40	11	11.20	6.0	4.45	6.27	2.7	7.5	001544					
10 B	0.625	15.875	9.65	13.28	1.70	1.50	1.50	14.60	16.59	11.30	9.40	13	13.20	7.5	5.08	7.00	3.2	8.0	001543					
12 B	0.75	19.05	11.68	15.62	1.80	1.80	1.80	15.90	19.46	13.20	11.10	16	15.60	10.0	5.72	8.40	3.8	9.5	001542					
16 B	1.00	25.40	17.02	25.40	3.75	3.05	3.05	20.50	31.88	21.60	17.70	20	25.40	14.0	8.28	11.70	6.4	13.0	001541					
20 B	1.25	31.75	19.56	29.00	4.50	4.50	3.50	25.70	36.45	24.10	20.20	26	29.00	16.5	10.19	14.00	7.4	16.5	001449					
24 B	1.50	38.10	25.40	37.90	5.80	5.00	5.00	33.00	48.36	31.60	26.90	33	37.90	19.5	14.63	18.99	10.6	20.0	001540					
28 B	1.75	44.45	30.99	46.50	6.50	5.50	6.00	37.00	59.56	36.60	31.60	36	46.50	23.0	15.90	21.64	12.6	24.0	001539					
32 B	2.00	50.80	30.99	45.50	6.30	6.30	6.30	41.20	58.55	38.40	32.50	42	45.50	27.0	17.81	23.12	13.2	27.0	001538					
40 B	2.50	63.50	38.10	55.70	8.50	8.00	8.00	51.50	72.29	47.50	39.40	52	55.70	35.0	22.89	29.18	16.6	35.0	017776					
48 B	3.00	76.20	45.72	70.50	12.00	10.00	10.00	63.50	91.21	56.00	49.20	64	70.50	40.0	29.24	37.90	20.6	40.0	001535					
56 B	3.50	88.90	53.34	81.30	13.60	12.00	12.00	77.00	106.60	64.80	57.80	77	81.30	45.0	34.32	43.50	25.0	51.0	001536					

### Connecting dimensions for roller chains, American type, DIN ISO 606 (DIN 8188)

Chain No.	Pitch		Width beet- ween inner plates	Width over inner link	Plate thickness		g	e	f <sub>1</sub>	f <sub>2</sub>	h	b max	c	Bore Ø		t	o	Bush part no.
														d C10	D S7			
	p	b <sub>1</sub> min	b <sub>2</sub> max	s	s <sub>1</sub>	s	s <sub>1</sub>	s	e	f <sub>1</sub>	f <sub>2</sub>	h	b max	c	d C10	D S7	t	
inch	mm	mm	mm	mm	mm	mm	mm	mm	mm	mm	mm	mm	mm	mm	mm	mm	mm	mm
40	0.50	12.70	7.85	11.15	1.50	1.50	11.60	14.38	11.2	8.1	11	11.10	6.0	3.96	5.98	3.2	7.0	001544
50	0.625	15.875	9.40	13.80	2.00	2.00	14.60	18.11	12.0	10.2	13	13.80	7.7	5.08	7.65	4.2	9.0	001543
50	0.75	19.05	12.57	17.70	2.40	2.40	17.60	22.78	14.4	12.8	16	17.60	9.0	5.94	9.00	5.0	10.0	001542
80	1.00	25.40	18.75	22.50	3.05	3.05	23.50	29.29	20.4	16.5	22	22.30	12.0	7.92	11.67	6.8	14.0	001541
100	1.25	31.75	18.98	27.40	4.00	4.00	28.70	35.76	23.7	19.7	26	27.40	15.5	9.53	13.82	8.4	17.5	001449
120	1.50	38.10	25.22	35.30	4.70	4.70	34.40	45.44	30.0	24.9	30	35.20	18.5	11.10	16.13	9.8	20.0	001540
140	1.75	44.45	25.22	37.00	5.50	5.50	40.80	48.87	31.6	26.7	36	37.00	21.5	12.70	18.29	11.6	23.5	001539
160	2.00	50.80	31.55	45.00	6.30	6.30	47.80	58.55	36.4	31.8	42	44.70	24.0	14.27	20.70	13.2	27.5	001538
180	2.25	57.15	35.72	50.50	7.00	7.00	54.00	65.35	41.4	35.7	47	50.60	27.0	17.46	25.35	14.6	32.0	017776
200	2.50	63.50	37.85	54.70	8.00	8.00	60.00	71.55	45.0	39.0	52	54.60	30.0	19.84	28.38	16.6	34.5	001535
240	3.00	76.20	47.35	67.50	9.50	9.50	70.00	87.33	55.5	47.4	62	67.50	37.0	23.80	34.28	19.6	41.0	001536



## Overview Rexnord roller chains

### Roller Chains

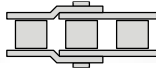

- Outstanding protection against corrosion and wear
- Unique protection against chain joint stiffness
- Extremely eco-friendly

- Maintenance-free
- Low noise
- Eco-friendly

- Combination of RexPlus and RexCarbon
- Excellent resistance to rust and acids
- Maintenance-free
- NSF H1 certification

- The optimum choice for light and medium duty
- Good cost-benefit ratio
- High availability

- Durable and low-maintenance
- Longer servicing intervals
- High loading capacity

- Excellent resistance to rust and acids
- Highly reliable
- Fulfills hygiene requirements
- NSF H1 certification

- Outstanding corrosion resistance
- Long service life
- High loading capacity

- Extremely high loading capacity
- Long service life
- Outstanding protection against corrosion and wear

### Leaf Chains

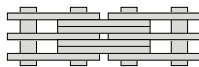

- Outstanding protection against corrosion and wear
- Unique protection against chain joint stiffness
- Extremely eco-friendly

- Durable and low-maintenance
- Longer servicing intervals
- High loading capacity
- Extreme wear resistance for double-length service life

- Outstanding corrosion resistance
- Long service life
- High loading capacity

- The optimum choice for light and medium duty
- Good cost-benefit ratio
- Good availability