



Movement Technologies

# Bandas Modulares Serie 508





Movement Technologies



**MP80 C**  
Micropitch Belt Series

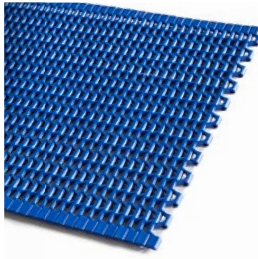

**MP80 FG**  
Micropitch Belt Series



**MP80 NS**  
Micropitch Belt Series

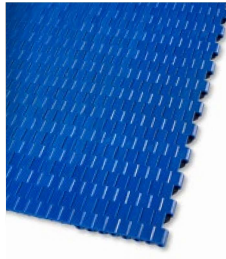

**MP80 NP**  
Micropitch Belt Series



**EC127 C**

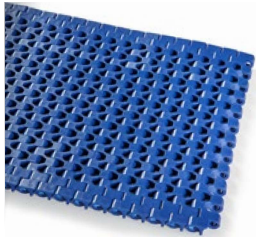

**EC127 FG**



**EC127 GT**

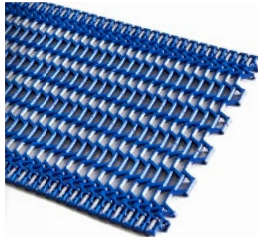

**MD127 GAP%50**



**HC127 C**



**SM127 C**



**SM127 FG**



**SM127 CRV**



**XP254 CR**  
Corrugated & Logistic Belt Series



**XP254 FLT CR**  
Corrugated & Logistic Belt Series



**XP254 C**

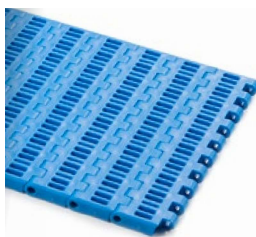

**XP254 PR%22**



**XP254 FG**

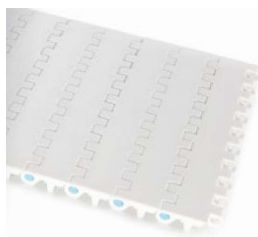

**EC254 C**

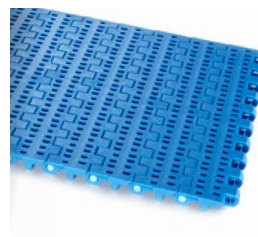

**EC254 PR%16**

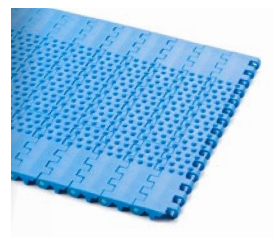

**EC254 NT**



**MD254 FG**



**MD254 C**

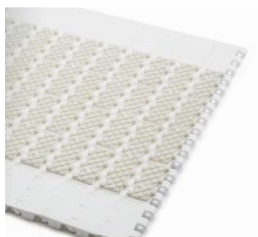

**MD254 GT**

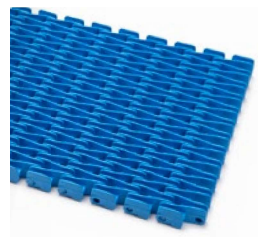

**MD254 RR**



**MD254 GAP%48**



***EC508 C***



***EC508 PR%22***



***EC508 FG***

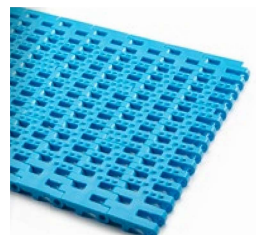

***EC508 FG-NT***



***EC508 PR%11***



***EC508 PR%13***



***EC508 DT***

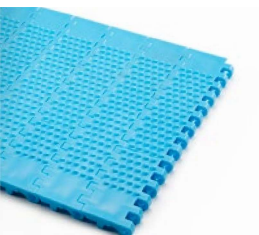

***EC508 NT***



***MD508 C***



***MD508 FG***



***MD508 PR%25***



***HP508 RR***



***HP508 FG***  
*Battery Belt*



***HP508 C***

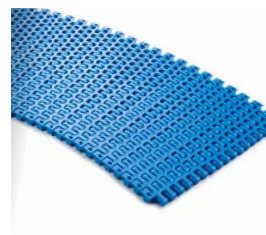

***EC254 R***  
*Radius Belt 2,1*

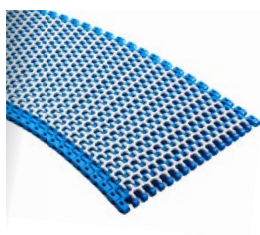

***EC254 R-GT***  
*Radius Belt 2,1 with  
friction surface*



***EC254T R***  
*Tight Radius Belt 1,4*



***EC508T R***  
*Tight Radius Belt 1,5*



# *EC508*

## *Modular Belt Series*

*EC508 C*

*EC508 PR%22*

*EC508 FG*

*EC508 FG-NT*

*EC508 PR%11*

*EC508 PR%13*

*EC508 DT*

*EC508 NT*

*Sprockets & Accessories*

*Engineering Information*









# **EC508 C**

## **Modular Belt Series**

### **• Meat Applications**

*Slaughtering - Evisceration, Cutting Lines, Debonning Lines,  
Bone Takeaway, Dressing Lines, Trim Lines*

### **• Poultry Applications**

*Live Birds, Slaughtering - Evisceration, Skinning, Cut - Up,  
Chiller Discharge, Bird Accumulation, Freezing Lines, Elevator*

### **• Sea Food Applications**

*Trim Lines, Control Tables, Glazing, Elevator*

### **• Bakery Applications**

*Row Dough Handling, Laminating Lines*

### **• Snack Food Applications**

*Potato Processing*

### **• Fruits and Vegetables Applications**

*Bulk Feeding, Elevator, Control Sorting Table, Filling*

### **• Automotive Applications**

*Chair Lift - Feeder*

### **• Packaging Applications**

*Bluk Inclines, Box Transport Horizontal*



# EC508 C

Pitch:	50,8 mm / <b>2 inch</b>
Belt Surface:	Close, Smooth Surface
Minimum Width:	100 mm / <b>3.94 inch</b>
Open Area (%):	0%
Flight:	Yes ( T25, T50, T75, T100, T150, TNC50, TNC100, TC75, TC100, TC150, TCC75, TCC100, TCC150, TCCH100 )
Sidewall:	Yes ( h=25 mm, h=50 mm, h=75 mm, h=100 mm )
Rod:	Ø7 mm / <b>0.276 inch</b> - Self Lock
Approved:	FDA and EU
Curve:	No
Color:	Additional colors available
Cleanability:	Excellent
Belt Thickness:	16 mm / <b>0.630 inch</b>



## Product Features and Functional Benefits

- Easy to clean reduces downtime for cleaning time 70%.
- Close transfer applications.
- Reduces bacteria growth.
- Unique sprocket engagement - higher product load and longer conveyors.
- Strong and thick product supports allow more load without breaking.
- Impact resistance to withstand heavy objects falling into the belt.

## Available Moulded Module Sizes

- 200 mm / **7.87 inch** module
- 100 mm / **3.94 inch** module
- 60 mm / **2.36 inch** module
- 40 mm / **1.57 inch** module

## EC508 C / Technical Information

BELT MATERIAL	BELT STRENGTH				TEMPERATURE		BELT WEIGHT
	Straight		Curve		°C / °F (min.)	°C / °F (max.)	Kg/m² / lb/ft²
	N/m	lb/ft	N/m	lb/ft			
Polypropylene	19800	<b>1356</b>	-	-	+5 / <b>+41</b>	+90 / <b>+194</b>	9,0 / <b>1.85</b>
Polyethylene	11000	<b>753</b>	-	-	-73 / <b>-99.4</b>	+66 / <b>+150.8</b>	9,4 / <b>1.93</b>
Acetal	33000	<b>2260</b>	-	-	-43 / <b>-45.4</b>	+110 / <b>+230</b>	13,5 / <b>2.77</b>

- Belt strength and temperature values are maximum on the table.

## EC508 C / Standard Belt Widths

BELT SERIES	WIDTH (W)				Belt With Tolerance (max.)
	PP-PE		POM		
	mm	inch	mm	inch	
EC 508 C	200,0	7.87	200,0	7.87	± 1 mm
EC 508 C	300,0	11.81	300,0	11.81	± 2 mm
EC 508 C	400,0	15.75	400,0	15.75	± 2 mm
EC 508 C	500,0	19.69	500,0	19.69	± 2 mm
EC 508 C	600,0	23.62	600,0	23.62	± 3 mm
EC 508 C	700,0	27.56	700,0	27.56	± 3 mm
EC 508 C	800,0	31.50	800,0	31.50	± 3 mm
EC 508 C	900,0	35.43	900,0	35.43	± 4 mm
EC 508 C	1000,0	39.37	1000,0	39.37	± 4 mm
EC 508 C	1100,0	43.31	1100,0	43.31	± 4 mm
EC 508 C	1200,0	47.24	1200,0	47.24	± 4 mm
EC 508 C	1300,0	51.18	1300,0	51.18	± 5 mm
EC 508 C	1400,0	55.11	1400,0	55.11	± 5 mm
EC 508 C	1500,0	59.06	1500,0	59.06	± 5 mm

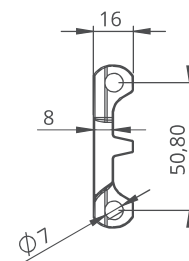
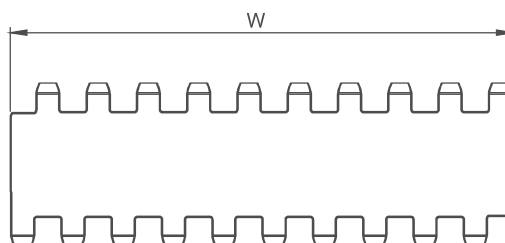

- Standard belt increments 100 mm.
- Non-standard belt increments 20 mm.
- Please contact with customer service for precise belt measurements.

# ***EC508 PR%22***

## ***Modular Belt Series***

### ***• Meat Applications***

*Dressing Lines, Trim Lines, Elevator, Metal Detector*

### ***• Poultry Applications***

*Cut-up Lines, Debonning Lines, Chiller Discharge, Rehang / Bird Accumulation, Freezing Lines, Elevators*

### ***• Sea Food Applications***

*Draining, Elevator*

### ***• Snack Food Applications***

*Can Draining*

### ***• Fruits and Vegetables Applications***

*Prewashing / Rinsing, Draining, Peeling, Elevator, Blanching*



# EC508 PR%22

Pitch:	50,8 mm / <b>2 inch</b>
Belt Surface:	Open, Smooth Surface
Minimum Width:	100 mm / <b>3.94 inch</b>
Open Area (%):	22%. ( Biggest opening 3 x 12 mm )
Flight:	Yes ( T25, T50, T75, T100, T150, TNC50, TNC100, TC75, TC100, TC150, TCC75, TCC100, TCC150, TCCH100 )
Sidewall:	Yes ( h=25 mm, h=50 mm, h=75 mm, h=100 mm )
Rod:	Ø7 mm / <b>0.276 inch</b> - Self Lock
Approved:	FDA and EU
Curve:	No
Color:	Additional colors available
Cleanability:	Excellent
Belt Thickness:	16 mm / <b>0.630 inch</b>



## Product Features and Functional Benefits

- Unique sprocket engagement - precise indexing, easy cleaning.
- Different openings to optimize performance in cooling and draining applications.
- Easy to clean reduces downtime for cleaning time 70%.
- Unique sprocket engagement - higher product load and longer conveyors.
- Reduces bacteria growth.

## Available Moulded Module Sizes

- 200 mm / **7.87 inch** module
- 100 mm / **3.94 inch** module
- 60 mm / **2.36 inch** module
- 40 mm / **1.57 inch** module

## EC508 PR%22 / Technical Information

BELT MATERIAL	BELT STRENGTH				TEMPERATURE		BELT WEIGHT
	Straight		Curve		°C / °F (min.)	°C / °F (max.)	Kg/m² / lb/ft²
	N/m	lb/ft	N/m	lb/ft			
Polypropylene	19800	<b>1356</b>	-	-	+5 / <b>+41</b>	+90 / <b>+194</b>	6,7 / <b>1.37</b>
Polyethylene	11000	<b>753</b>	-	-	-73 / <b>-99.4</b>	+66 / <b>+150.8</b>	7,0 / <b>1.43</b>
Acetal	33000	<b>2260</b>	-	-	-43 / <b>-45.4</b>	+110 / <b>+230</b>	8,7 / <b>1.78</b>

- Belt strength and temperature values are maximum on the table.

## EC508 PR%22 / Standard Belt Widths

BELT SERIES	WIDTH (W)				Belt With Tolerance (max.)
	PP-PE		POM		
	mm	inch	mm	inch	
EC508 PR22	200,0	7.87	200,0	7.87	± 1 mm
EC508 PR22	300,0	11.81	300,0	11.81	± 2 mm
EC508 PR22	400,0	15.75	400,0	15.75	± 2 mm
EC508 PR22	500,0	19.69	500,0	19.69	± 2 mm
EC508 PR22	600,0	23.62	600,0	23.62	± 3 mm
EC508 PR22	700,0	27.56	700,0	27.56	± 3 mm
EC508 PR22	800,0	31.50	800,0	31.50	± 3 mm
EC508 PR22	900,0	35.43	900,0	35.43	± 4 mm
EC508 PR22	1000,0	39.37	1000,0	39.37	± 4 mm
EC508 PR22	1100,0	43.31	1100,0	43.31	± 4 mm
EC508 PR22	1200,0	47.24	1200,0	47.24	± 4 mm
EC508 PR22	1300,0	51.18	1300,0	51.18	± 5 mm
EC508 PR22	1400,0	55.11	1400,0	55.11	± 5 mm
EC508 PR22	1500,0	59.06	1500,0	59.06	± 5 mm

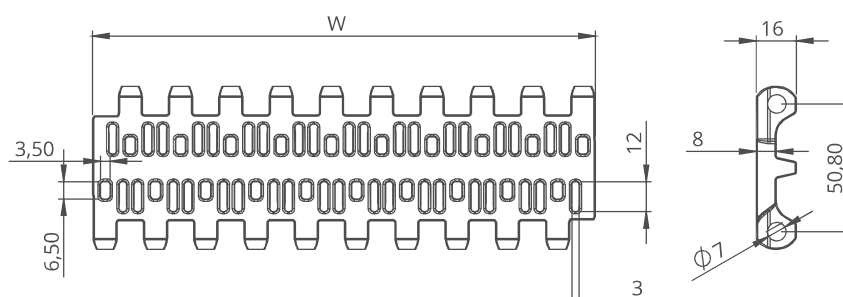

- Standard belt increments 100 mm.
- Non-standard belt increments 20 mm.
- Please contact with customer service for precise belt measurements.

# **EC508 FG**

## **Modular Belt Series**

- **Bakery Applications**

*Oven Infeed/Outfeed, Cooling Lines, Coating Lines, Glazing Lines,  
Freezing Lines, Conditioning Lines*

- **Sea Food Applications**

*Breeding Machines, Draining Lines*

- **Snack Food Applications**

*Puffer Lines, Boiler Infeed, Oven Infeed / Outfeed, Cooling Lines*

- **Fruits and Vegetables Applications**

*Prewashing / Rinsing, Draining*

- **Tire Manufacturing Applications**

*Mixer Infeed / Outfeed, Extrusion Shower Lines, Cooling Incline,  
Cooling Decline, Cooling Horizontal*



# EC508 FG

Pitch:	50,8 mm / <b>2 inch</b>
Belt Surface:	Open, Smooth Surface
Minimum Width:	200 mm / <b>7.87 inch</b>
Open Area (%):	35%. ( Biggest opening 9 x 12 mm )
Flight:	Yes ( T25, T50, T75, T100, T150, TNC50, TNC100, TC75, TC100, TC150, TCC75, TCC100, TCC150, TCCH100 )
Sidewall:	Yes ( h=25 mm, h=50 mm, h=75 mm, h=100 mm )
Rod:	Ø7 mm / <b>0.276 inch</b> - Self Lock
Approved:	FDA and EU
Curve:	No
Color:	Additional colors available
Cleanability:	Excellent
Belt Thickness:	16 mm / <b>0.630 inch</b>



## Product Features and Functional Benefits

- Belt provides optimal open area for drainage and airflow.
- Less friction and product contact for easy cooking, cooling and freezing of products.
- Reduced dirt and oxide build due to self cleaning surface.
- Easy to clean reduces downtime for cleaning time 70%.

## Available Moulded Module Sizes

- 200 mm / **7.87 inch** module

## EC508 FG / Technical Information

BELT MATERIAL	BELT STRENGTH				TEMPERATURE		BELT WEIGHT
	Straight		Curve		°C / °F (min.)	°C / °F (max.)	Kg/m² / lb/ft²
	N/m	lb/ft	N/m	lb/ft			
Polypropylene	17600	<b>1205</b>	-	-	+5 / <b>+41</b>	+90 / <b>+194</b>	7,5 / <b>1.54</b>
Polyethylene	7700	<b>528</b>	-	-	-73 / <b>-99.4</b>	+66 / <b>+150.8</b>	8,0 / <b>1.65</b>
Acetal	27500	<b>1883</b>	-	-	-43 / <b>-45.4</b>	+110 / <b>+230</b>	11,0 / <b>2.25</b>

- Belt strength and temperature values are maximum on the table.

## EC508 FG / Standard Belt Widths

BELT SERIES	WIDTH (W)				Belt With Tolerance (max.)
	PP-PE		POM		
	mm	inch	mm	inch	
EC 508 FG	200,0	7.87	200,0	7.87	± 1 mm
EC 508 FG	300,0	11.81	300,0	11.81	± 2 mm
EC 508 FG	400,0	15.75	400,0	15.75	± 2 mm
EC 508 FG	500,0	19.69	500,0	19.69	± 2 mm
EC 508 FG	600,0	23.62	600,0	23.62	± 3 mm
EC 508 FG	700,0	27.56	700,0	27.56	± 3 mm
EC 508 FG	800,0	31.50	800,0	31.50	± 3 mm
EC 508 FG	900,0	35.43	900,0	35.43	± 4 mm
EC 508 FG	1000,0	39.37	1000,0	39.37	± 4 mm
EC 508 FG	1100,0	43.31	1100,0	43.31	± 4 mm
EC 508 FG	1200,0	47.24	1200,0	47.24	± 4 mm
EC 508 FG	1300,0	51.18	1300,0	51.18	± 5 mm
EC 508 FG	1400,0	55.11	1400,0	55.11	± 5 mm
EC 508 FG	1500,0	59.06	1500,0	59.06	± 5 mm

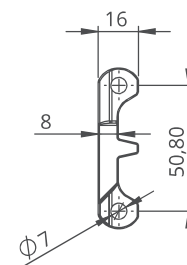
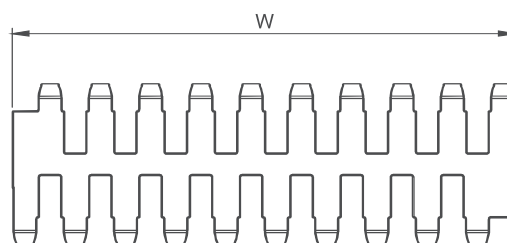

- Standard belt increments 100 mm.
- Non-standard belt increments 20 mm.
- Please contact with customer service for precise belt measurements.

[www.rodamientos.net](http://www.rodamientos.net)



# ***EC508 FG-NT***

## ***Modular Belt Series***

- **Bakery Applications**

*Oven Infeed/Outfeed, Cooling Lines, Coating Lines, Glazing Lines,  
Freezing Lines, Conditioning Lines*

- **Sea Food Applications**

*Breeding Machines, Draining Lines*

- **Snack Food Applications**

*Proofer Lines, Boiler Infeed, Oven Infeed / Outfeed, Cooling Lines*

- **Fruits and Vegetables Applications**

*Prewashing / Rinsing, Draining*

- **Tire Manufacturing Applications**

*Mixer Infeed / Outfeed, Extrusion Shower Lines, Cooling Incline,  
Cooling Decline, Cooling Horizontal*



# EC508 FG-NT

Pitch:	50,8 mm / <b>2 inch</b>
Belt Surface:	Open, Nub Top Surface
Minimum Width:	200 mm / <b>7.87 inch</b>
Open Area (%):	35%. ( Biggest opening 9 x 12 mm )
Flight:	Yes ( T25, T50, T75, T100, T150, TNC50, TNC100, TC75, TC100, TC150, TCC75, TCC100, TCC150, TCCH100 )
Sidewall:	Yes ( h=25 mm, h=50 mm, h=75 mm, h=100 mm )
Rod:	Ø7 mm / <b>0.275 inch</b> - Self Lock
Approved:	FDA and EU
Curve:	No
Color:	Additional colors available
Cleanability:	Excellent
Belt Thickness:	18.5 mm / <b>0.728 inch</b>



## Product Features and Functional Benefits

- Belt provides optimal open area for drainage and airflow.
- Less friction and product contact for easy cooking, cooling and freezing of products.
- Non-adhesive due to reduced contact surface.
- Reduced dirt and oxide build due to self cleaning surface.
- Easy to clean reduces downtime for cleaning time 70%.

## Available Moulded Module Sizes

- 200 mm / **7.87 inch** module
- 200 mm / **7.87 inch** edge module with 40 mm indent

## EC508 FG-NT / Technical Information

BELT MATERIAL	BELT STRENGTH				TEMPERATURE		BELT WEIGHT
	Straight		Curve		°C (min.) - °F (min.)	°C (max.) - °F (max.)	Kg/m² - lb/ft²
	N/m	lb/ft	N/m	lb/ft			
Polypropylene	17600	1205	-	-	+5 / +42.8	+90 / +194	7,7 - 1.58
Polyethylene	7700	528	-	-	-73 / -99.4	+66 / +150.8	8,2 - 1.69
Acetal	27500	1883	-	-	-43 / -45.4	+110 / +230	11,4 - 2.33

## EC508 FG-NT / Standard Belt Widths

- Belt strength and temperature values are maximum on the table.

BELT SERIES	WIDTH (W)				Belt With Tolerance (max.)
	PP-PE		POM		
	mm	inch	mm	inch	
EC 508 FG-NT	200,0	<b>7.87</b>	200,0	<b>7.87</b>	± 1 mm
EC 508 FG-NT	300,0	<b>11.81</b>	300,0	<b>11.81</b>	± 2 mm
EC 508 FG-NT	400,0	<b>15.75</b>	400,0	<b>15.75</b>	± 2 mm
EC 508 FG-NT	500,0	<b>19.69</b>	500,0	<b>19.69</b>	± 2 mm
EC 508 FG-NT	600,0	<b>23.62</b>	600,0	<b>23.62</b>	± 3 mm
EC 508 FG-NT	700,0	<b>27.56</b>	700,0	<b>27.56</b>	± 3 mm
EC 508 FG-NT	800,0	<b>31.50</b>	800,0	<b>31.50</b>	± 3 mm
EC 508 FG-NT	900,0	<b>35.43</b>	900,0	<b>35.43</b>	± 4 mm
EC 508 FG-NT	1000,0	<b>39.37</b>	1000,0	<b>39.37</b>	± 4 mm
EC 508 FG-NT	1100,0	<b>43.31</b>	1100,0	<b>43.31</b>	± 4 mm
EC 508 FG-NT	1200,0	<b>47.24</b>	1200,0	<b>47.24</b>	± 4 mm
EC 508 FG-NT	1300,0	<b>51.18</b>	1300,0	<b>51.18</b>	± 5 mm
EC 508 FG-NT	1400,0	<b>55.11</b>	1400,0	<b>55.11</b>	± 5 mm
EC 508 FG-NT	1500,0	<b>59.06</b>	1500,0	<b>59.06</b>	± 5 mm

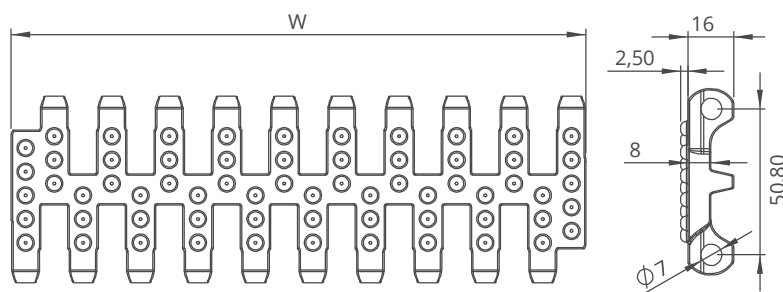

- Standard belt increments 100 mm.
- Non-standard belt increments 20 mm.
- Please contact with customer service for precise belt measurements.



# ***EC508 PR%11***

## ***Modular Belt Series***

### **• Meat Applications**

*Dressing Lines, Trim Lines, Elevator, Metal Detector*

### **• Poultry Applications**

*Cut-up Lines, Debonning Lines, Chiller Discharge, Rehang / Bird Accumulation, Freezing Lines, Elevators*

### **• Sea Food Applications**

*Draining, Elevator*

### **• Snack Food Applications**

*Can Draining*

### **• Fruits and Vegetables Applications**

*Prewashing / Rinsing, Draining, Peeling, Elevator*



# EC508 PR%11

Pitch:	50,8 mm / <b>2 inch</b>
Belt Surface:	Open, Mesh Top Surface
Minimum Width:	200 mm / <b>7.87 inch</b>
Open Area (%):	11%. ( Biggest opening 1,2 x 12 mm )
Flight:	Yes ( T25, T50, T75, T100, T150, TNC50, TNC100, TC75, TC100, TC150, TCC75, TCC100, TCC150, TCCH100 )
Sidewall:	Yes ( h=25 mm, h=50 mm, h=75 mm, h=100 mm )
Rod:	Ø7 mm / <b>0.276 inch</b> - Self Lock
Approved:	FDA and EU
Curve:	No
Color:	Additional colors available
Cleanability:	Excellent
Belt Thickness:	16 mm / <b>0.630 inch</b>



## Product Features and Functional Benefits

- Unique sprocket engagement - precise indexing, easy cleaning.
- Different openings to optimize performance in cooling and draining applications.
- Easy to clean reduces downtime for cleaning time 70%.
- Unique sprocket engagement - higher product load and longer conveyors.
- Reduces bacteria growth.

## Available Moulded Module Sizes

- 200 mm / **7.87 inch** module

## EC508 PR%11 / Technical Information

BELT MATERIAL	BELT STRENGTH				TEMPERATURE		BELT WEIGHT
	Straight		Curve		°C / °F (min.)	°C / °F (max.)	Kg/m² / lb/ft²
	N/m	lb/ft	N/m	lb/ft			
Polypropylene	19800	<b>1356</b>	-	-	+5 / <b>+41</b>	+90 / <b>+194</b>	7,8 / <b>1.60</b>
Polyethylene	-	-	-	-	-	-	-
Acetal	-	-	-	-	-	-	-

- Belt strength and temperature values are maximum on the table.

## EC508 PR%11 / Standard Belt Widths

BELT SERIES	WIDTH (W)				Belt With Tolerance (max.)
	PP		POM		
	mm	inch	mm	inch	
EC508 PR11	200,0	7.87	-	-	± 1 mm
EC508 PR11	300,0	11.81	-	-	± 2 mm
EC508 PR11	400,0	15.75	-	-	± 2 mm
EC508 PR11	500,0	19.69	-	-	± 2 mm
EC508 PR11	600,0	23.62	-	-	± 3 mm
EC508 PR11	700,0	27.56	-	-	± 3 mm
EC508 PR11	800,0	31.50	-	-	± 3 mm
EC508 PR11	900,0	35.43	-	-	± 4 mm
EC508 PR11	1000,0	39.37	-	-	± 4 mm
EC508 PR11	1100,0	43.31	-	-	± 4 mm
EC508 PR11	1200,0	47.24	-	-	± 4 mm
EC508 PR11	1300,0	51.18	-	-	± 5 mm
EC508 PR11	1400,0	55.11	-	-	± 5 mm
EC508 PR11	1500,0	59.06	-	-	± 5 mm

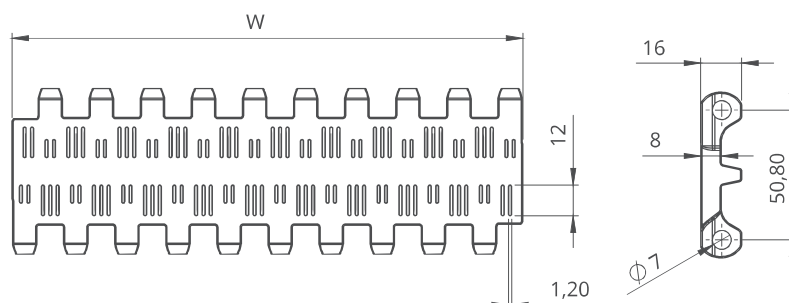

- Standard belt increments 100 mm.
- Non-standard belt increments 20 mm.
- Please contact with customer service for precise belt measurements.

[www.rodamientos.net](http://www.rodamientos.net)



# ***EC508 PR%13***

## ***Modular Belt Series***

- ***Poultry Applications***

*Cut-up Lines, Debonning Lines, Chiller Discharge, Rehang / Bird Accumulation, Freezing Lines, Elevators*

- ***Sea Food Applications***

*Draining, Elevator*

- ***Snack Food Applications***

*Can Draining*

- ***Fruits and Vegetables Applications***

*Prewashing / Rinsing, Draining, Peeling, Elevator*



# EC508 PR%13

Pitch:	50,8 mm / <b>2 inch</b>
Belt Surface:	Open, Smooth Surface
Minimum Width:	200 mm / <b>7.87 inch</b>
Open Area (%):	13%. ( Biggest opening Ø3,8 mm )
Flight:	Yes ( T25, T50, T75, T100, T150, TNC50, TNC100, TC75, TC100, TC150, TCC75, TCC100, TCC150, TCCH100 )
Sidewall:	Yes ( h=25 mm, h=50 mm, h=75 mm, h=100 mm )
Rod:	Ø7 mm / <b>0.276 inch</b> - Self Lock
Approved:	FDA and EU
Curve:	No
Color:	Additional colors available
Cleanability:	Excellent
Belt Thickness:	16 mm / <b>0.630 inch</b>



## Product Features and Functional Benefits

- Unique sprocket engagement - precise indexing, easy cleaning.
- Different openings to optimize performance in cooling and draining applications.
- Easy to clean reduces downtime for cleaning time 70%.
- Unique sprocket engagement - higher product load and longer conveyors.
- Reduces bacteria growth.

## Available Moulded Module Sizes

- 200 mm / **7.87 inch** module

## EC508 PR%13 / Technical Information

BELT MATERIAL	BELT STRENGTH				TEMPERATURE		BELT WEIGHT
	Straight		Curve		°C / °F (min.)	°C / °F (max.)	Kg/m² / lb/ft²
	N/m	lb/ft	N/m	lb/ft			
Polypropylene	19800	<b>1356</b>	-	-	+5 / <b>+41</b>	+90 / <b>+194</b>	7,5 / <b>1.54</b>
Polyethylene	11000	<b>753</b>	-	-	-73 / <b>-99.4</b>	+66 / <b>+150.8</b>	7,8 / <b>1.59</b>
Acetal	33000	<b>2260</b>	-	-	-43 / <b>-45.4</b>	+110 / <b>+230</b>	11,2 / <b>2.28</b>

- Belt strength and temperature values are maximum on the table.

## EC508 PR%13 / Standard Belt Widths

BELT SERIES	WIDTH (W)				Belt With Tolerance (max.)
	PP-PE		POM		
	mm	inch	mm	inch	
EC508 PR13	200,0	<b>7.87</b>	200,0	<b>7.87</b>	± 1 mm
EC508 PR13	300,0	<b>11.81</b>	300,0	<b>11.81</b>	± 2 mm
EC508 PR13	400,0	<b>15.75</b>	400,0	<b>15.75</b>	± 2 mm
EC508 PR13	500,0	<b>19.69</b>	500,0	<b>19.69</b>	± 2 mm
EC508 PR13	600,0	<b>23.62</b>	600,0	<b>23.62</b>	± 3 mm
EC508 PR13	700,0	<b>27.56</b>	700,0	<b>27.56</b>	± 3 mm
EC508 PR13	800,0	<b>31.50</b>	800,0	<b>31.50</b>	± 3 mm
EC508 PR13	900,0	<b>35.43</b>	900,0	<b>35.43</b>	± 4 mm
EC508 PR13	1000,0	<b>39.37</b>	1000,0	<b>39.37</b>	± 4 mm
EC508 PR13	1100,0	<b>43.31</b>	1100,0	<b>43.31</b>	± 4 mm
EC508 PR13	1200,0	<b>47.24</b>	1200,0	<b>47.24</b>	± 4 mm
EC508 PR13	1300,0	<b>51.18</b>	1300,0	<b>51.18</b>	± 5 mm
EC508 PR13	1400,0	<b>55.11</b>	1400,0	<b>55.11</b>	± 5 mm
EC508 PR13	1500,0	<b>59.06</b>	1500,0	<b>59.06</b>	± 5 mm

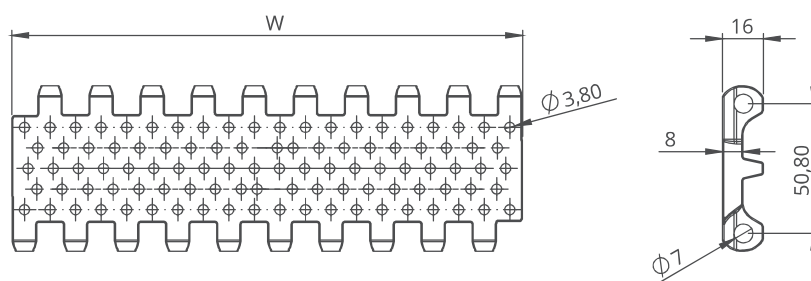

- Standard belt increments 100 mm.
- Non-standard belt increments 20 mm.
- Please contact with customer service for precise belt measurements.





# ***EC508 DT***

## ***Modular Belt Series***

### ***• Meat Applications***

*Slaughtering / Evisceration, Cutting Lines, Deboning Lines,  
Bone Takeaway, Dressing Lines, Trim Lines*

### ***• Poultry Applications***

*Live Birds, Slaughtering / Evisceration, Skinning, Cut-up, Chiller Discharge,  
Bird Accumulation, Freezing Lines, Elevators*

### ***• Sea Food Applications***

*Trim Lines, Control Tables, Glazing, Elevators*

### ***• Fruits and Vegetables Applications***

*Bulk Feeding, Elevators, Control Sorting Table, Filling*



# EC508 DT

Pitch:	50,8 mm / <b>2 inch</b>
Belt Surface:	Close, Diamond Top Surface
Minimum Width:	200 mm / <b>7.87 inch</b>
Open Area (%):	0%
Flight:	Yes ( T25, T50, T75, T100, T150, TNC50, TNC100, TC75, TC100, TC150, TCC75, TCC100, TCC150, TCCH100 )
Sidewall:	Yes ( h=25 mm, h=50 mm, h=75 mm, h=100 mm )
Rod:	Ø7 mm / <b>0.276 inch</b> - Self Lock
Approved:	FDA and EU
Curve:	No
Color:	Additional colors available
Cleanability:	Excellent
Belt Thickness:	17 mm / <b>0.669 inch</b>

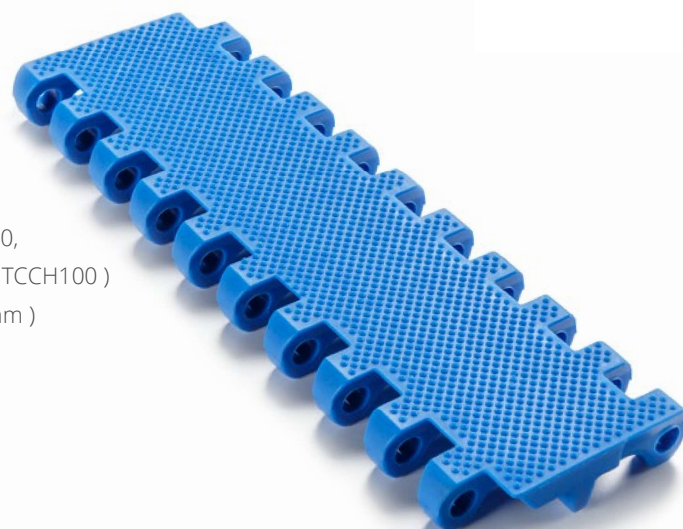

## Product Features and Functional Benefits

- Easy to clean reduces downtime for cleaning time 70%.
- Close, sticky transfer applications. Non-adhesive due to reduced contact surface.
- Reduces bacteria growth.
- Unique sprocket engagement - higher product load and longer conveyors.
- Strong and thick product supports allow more load without breaking.
- Impact resistance to withstand heavy objects falling into the belt.

## Available Moulded Module Sizes

- 200 mm / **7.87 inch** module
- 200 mm / **7.87 inch** edge module with 40 mm indent
- 100 mm / **3.94 inch** edge module with 40 mm indent

## EC508 DT / Technical Information

BELT MATERIAL	BELT STRENGTH				TEMPERATURE		BELT WEIGHT
	Straight		Curve		°C / °F (min.)	°C / °F (max.)	Kg/m² / lb/ft²
	N/m	lb/ft	N/m	lb/ft			
Polypropylene	19800	<b>1356</b>	-	-	+5 / <b>+41</b>	+90 / <b>+194</b>	9,1 / <b>1.86</b>
Polyethylene	11000	<b>753</b>	-	-	-73 / <b>-99.4</b>	+66 / <b>+150.8</b>	9,5 / <b>1.95</b>
Acetal	33000	<b>2260</b>	-	-	-43 / <b>-45.4</b>	+110 / <b>+230</b>	13,6 / <b>2.79</b>

- Belt strength and temperature values are maximum on the table.

## EC508 DT / Standard Belt Widths

BELT SERIES	WIDTH (W)				Belt With Tolerance (max.)
	PP-PE		POM		
	mm	inch	mm	inch	
EC508 DT	200,0	7.87	200,0	7.87	± 1 mm
EC508 DT	300,0	11.81	300,0	11.81	± 2 mm
EC508 DT	400,0	15.75	400,0	15.75	± 2 mm
EC508 DT	500,0	19.69	500,0	19.69	± 2 mm
EC508 DT	600,0	23.62	600,0	23.62	± 3 mm
EC508 DT	700,0	27.56	700,0	27.56	± 3 mm
EC508 DT	800,0	31.50	800,0	31.50	± 3 mm
EC508 DT	900,0	35.43	900,0	35.43	± 4 mm
EC508 DT	1000,0	39.37	1000,0	39.37	± 4 mm
EC508 DT	1100,0	43.31	1100,0	43.31	± 4 mm
EC508 DT	1200,0	47.24	1200,0	47.24	± 4 mm
EC508 DT	1300,0	51.18	1300,0	51.18	± 5 mm
EC508 DT	1400,0	55.11	1400,0	55.11	± 5 mm
EC508 DT	1500,0	59.06	1500,0	59.06	± 5 mm

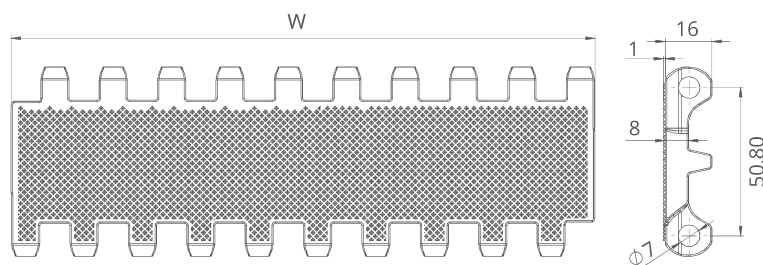

- Standard belt increments 100 mm.
- Non-standard belt increments 20 mm.
- Please contact with customer service for precise belt measurements.



# ***EC508 NT***

## ***Modular Belt Series***

- **Meat Applications**

*Slaughtering / Evisceration, Cutting Lines, Deboning Lines,  
Bone Takeaway, Dressing Lines, Trim Lines*

- **Poultry Applications**

*Live Birds, Slaughtering / Evisceration, Skining, Cut-up, Chiller Discharge,  
Bird Accumulation, Freezing Lines, Elevators*

- **Sea Food Applications**

*Trim Lines, Control Tables, Glazing, Elevators*

- **Fruits and Vegetables Applications**

*Bulk Feeding, Elevators, Control Sorting Table, Filling*



# EC508 NT

Pitch:	50,8 mm / <b>2 inch</b>
Belt Surface:	Close, Nub Top Surface
Minimum Width:	200 mm / <b>7.87 inch</b>
Open Area (%):	0%
Flight:	Yes ( T25, T50, T75, T100, T150, TNC50, TNC100, TC75, TC100, TC150, TCC75, TCC100, TCC150, TCCH100 )
Sidewall:	Yes ( h=25 mm, h=50 mm, h=75 mm, h=100 mm )
Rod:	Ø7 mm / <b>0.275 inch</b> - Self Lock
Approved:	FDA and EU
Curve:	No
Color:	Additional colors available
Cleanability:	Excellent
Belt Thickness:	18,5 mm / <b>0.728 inch</b>



## Product Features and Functional Benefits

- Easy to clean reduces downtime for cleaning time 70%.
- Close, sticky transfer applications. Non-adhesive due to reduced contact surface.
- Reduces bacteria growth.
- Unique sprocket engagement - higher product load and longer conveyors.
- Strong and thick product supports allow more load without breaking.
- Impact resistance to withstand heavy objects falling into the belt.

## Available Moulded Module Sizes

- 200 mm / **7.87 inch** module
- 200 mm / **7.87 inch** edge module with 40 mm indent

## EC508 NT / Technical Information

BELT MATERIAL	BELT STRENGTH				TEMPERATURE		BELT WEIGHT
	Straight		Curve		°C (min.) - °F (min.)	°C (max.) - °F (max.)	Kg/m² - lb/ft²
	N/m	lb/ft	N/m	lb/ft			
Polypropylene	-	-	-	-	-	-	-
Polyethylene	11000	753	-	-	-73 / -99.4	+66 / +150.8	9,6 - 1.97
Acetal	33000	2260	-	-	-43 / -45.4	+110 / +230	13,9 - 2.85

## EC508 NT / Standard Belt Widths

- Belt strength and temperature values are maximum on the table.

BELT SERIES	WIDTH (W)				Belt With Tolerance (max.)
	PE		POM		
	mm	inch	mm	inch	
EC508 NT	200,0	<b>7.87</b>	200,0	<b>7.87</b>	± 1 mm
EC508 NT	300,0	<b>11.81</b>	300,0	<b>11.81</b>	± 2 mm
EC508 NT	400,0	<b>15.75</b>	400,0	<b>15.75</b>	± 2 mm
EC508 NT	500,0	<b>19.69</b>	500,0	<b>19.69</b>	± 2 mm
EC508 NT	600,0	<b>23.62</b>	600,0	<b>23.62</b>	± 3 mm
EC508 NT	700,0	<b>27.56</b>	700,0	<b>27.56</b>	± 3 mm
EC508 NT	800,0	<b>31.50</b>	800,0	<b>31.50</b>	± 3 mm
EC508 NT	900,0	<b>35.43</b>	900,0	<b>35.43</b>	± 4 mm
EC508 NT	1000,0	<b>39.37</b>	1000,0	<b>39.37</b>	± 4 mm
EC508 NT	1100,0	<b>43.31</b>	1100,0	<b>43.31</b>	± 4 mm
EC508 NT	1200,0	<b>47.24</b>	1200,0	<b>47.24</b>	± 4 mm
EC508 NT	1300,0	<b>51.18</b>	1300,0	<b>51.18</b>	± 5 mm
EC508 NT	1400,0	<b>55.11</b>	1400,0	<b>55.11</b>	± 5 mm
EC508 NT	1500,0	<b>59.06</b>	1500,0	<b>59.06</b>	± 5 mm

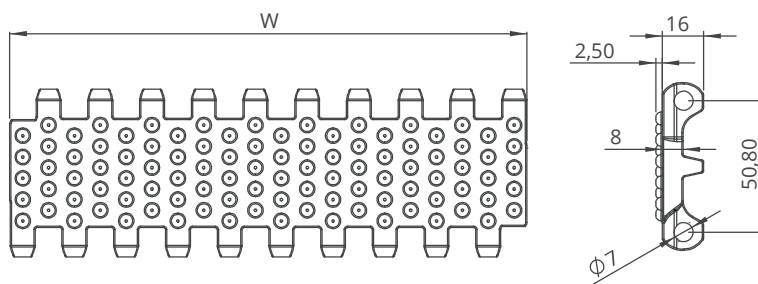

- Standard belt increments 100 mm.
- Non-standard belt increments 20 mm.
- Please contact with customer service for precise belt measurements.

# EC508 Series Sprockets and Technical Specifications



Z10



Z10



Z12

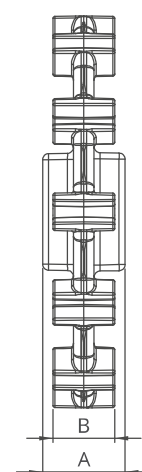
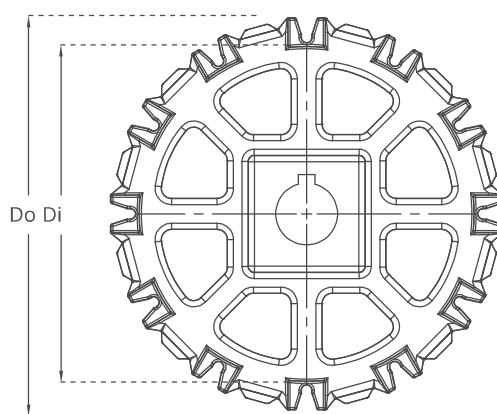
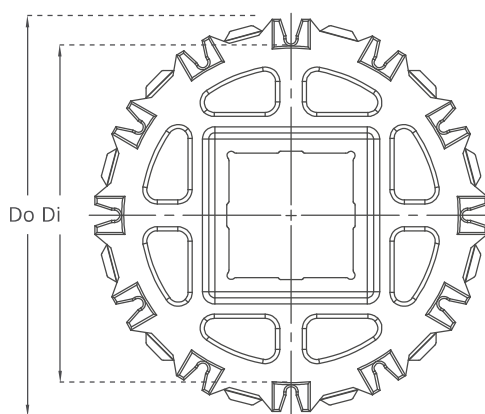

## EC508 Series / Standard Sprockets Dimensions

NO. TEETH	Di mm/inch	Do mm/inch	B mm/inch	A mm/inch	Square Bore(Q) mm/inch	Round Bore(R) mm/inch	PRODUCT CODE	
							Square Type (Q)	Round Type (R)
Z6	73,0 / <b>2.87</b>	90,0 / <b>3.54</b>	30 / <b>1.18</b>	40 / <b>1.57</b>	40 / <b>1.5</b>	25-30 / <b>1-1.25</b>	EC508SQZ6*PA	EC508SRZ6*PA
Z8	107,5 / <b>4.23</b>	124,5 / <b>4.90</b>	30 / <b>1.18</b>	40 / <b>1.57</b>	40 / <b>1.5</b>	25-30 / <b>1-1.25</b>	EC508SQZ8*PA	EC508SRZ8*PA
Z10	141,5 / <b>5.57</b>	158,0 / <b>6.22</b>	30 / <b>1.18</b>	40 / <b>1.57</b>	40-60 / <b>1.5-2.5</b>	25-30 / <b>1-1.25</b>	EC508SQZ10*PA	EC508SRZ10*PA
Z12	175,2 / <b>6.90</b>	191,2 / <b>7.53</b>	30 / <b>1.18</b>	40 / <b>1.57</b>	40-60 / <b>1.5-2.5</b>	25-30 / <b>1-1.25</b>	EC508SQZ12*PA	EC508SRZ12*PA

\*Other sprockets and hub sizes are manufactured up to request.

\*POM (Acetal) and PP (Polypropylene) sprockets raw material is available on request.

**\*Machined Split Sprockets are available for each size.**



Clamp



Machined Split Sprocket

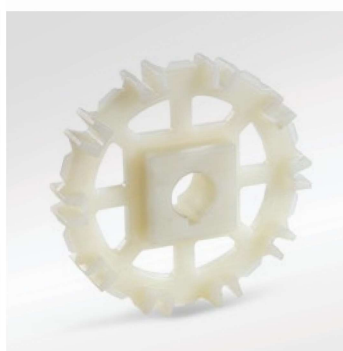

Moulded Sprocket

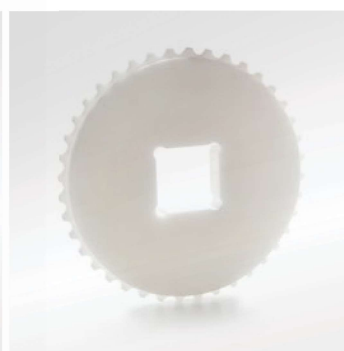

Machined Sprocket



# EC508 Series Accessories and Technical Specifications

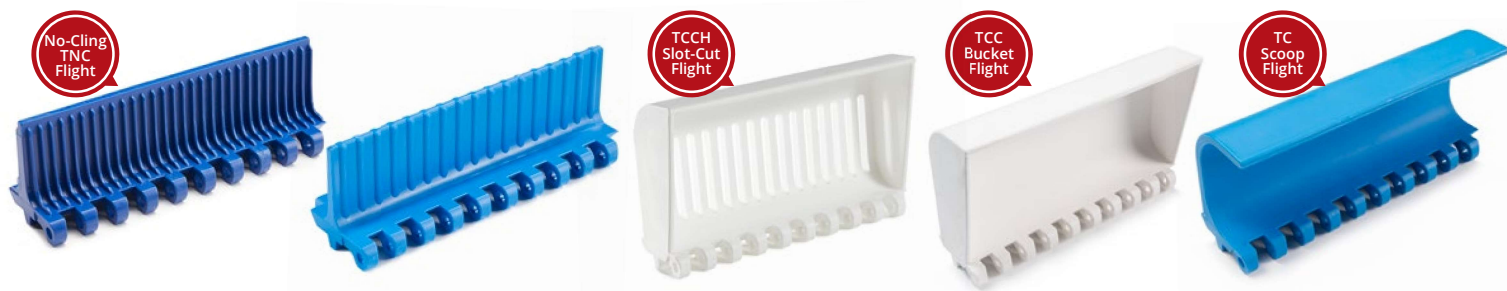

## EC508 Series / Flight & Sidewall Dimensions

EC508 Series / Flights & Sidewalls				
PRODUCT CODE	Flight Height (mm/ <i>inch</i> )	Flight Width (mm/ <i>inch</i> )	PRODUCT CODE	Sidewall Height (mm/ <i>inch</i> )
EC508T25	25 / <b>1</b>	200 / <b>7.87</b>	EC508SW25	25 / <b>1</b>
EC508T50	50 / <b>2</b>	200 / <b>7.87</b>	EC508SW50	50 / <b>2</b>
EC508T75	75 / <b>3</b>	200 / <b>7.87</b>	EC508SW75	75 / <b>3</b>
EC508T100	100 / <b>4</b>	200 / <b>7.87</b>	EC508SW100	100 / <b>4</b>
EC508T150	150 / <b>6</b>	200 / <b>7.87</b>	-	-
EC508TC75	75 / <b>3</b>	200 / <b>7.87</b>	-	-
EC508TC100	100 / <b>4</b>	200 / <b>7.87</b>	-	-
EC508TC150	150 / <b>6</b>	200 / <b>7.87</b>	-	-
EC508TCC75	75 / <b>3</b>	200 / <b>7.87</b>	-	-
EC508TCC100	100 / <b>4</b>	200 / <b>7.87</b>	-	-
EC508TCC150	150 / <b>6</b>	200 / <b>7.87</b>	-	-
EC508TNC100	100 / <b>4</b>	200 / <b>7.87</b>	-	-
EC508TCH100	100 / <b>4</b>	200 / <b>7.87</b>	-	-
EC508TCCH100	100 / <b>4</b>	200 / <b>7.87</b>	-	-

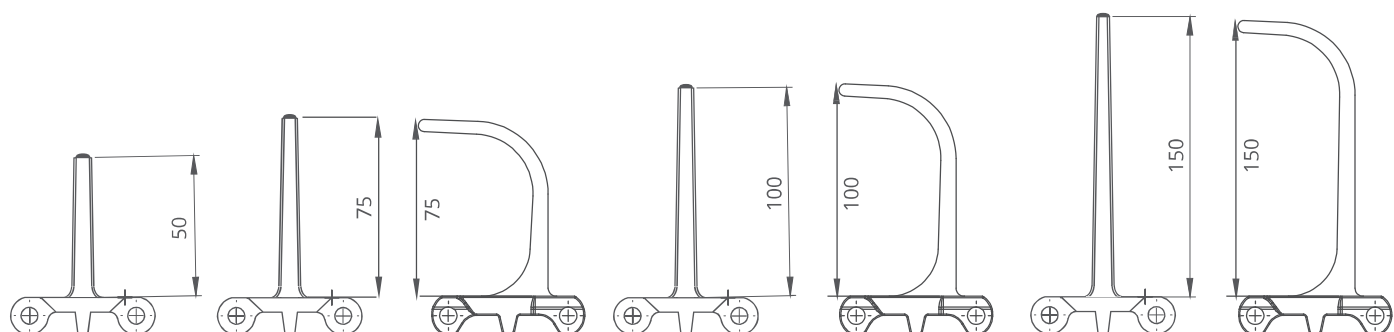

\* Additional flight dimensions are available up to 150 mm.

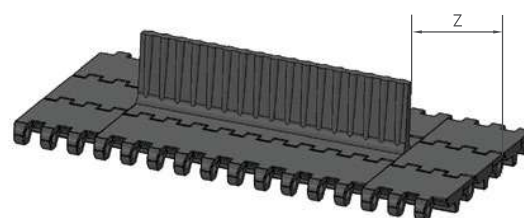
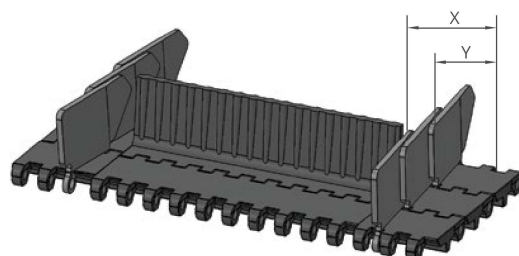

## EC508 Series / Sidewall Technical Specifications

Possible Sidewall and Flight Indents	X		Y	
	mm	inch	mm	inch
Standard, no module cutting	40,0	<b>1.57</b>	18,2	<b>0.72</b>
Non-standard	50,0	<b>1.97</b>	28,2	<b>1.11</b>
Standard, no module cutting	60,0	<b>2.36</b>	38,2	<b>1.50</b>
Non-standard	70,0	<b>2.76</b>	48,2	<b>1.90</b>
Standard, module cutting necessary	80,0	<b>3.15</b>	58,2	<b>2.29</b>
Non-standard	90,0	<b>3.54</b>	68,2	<b>2.69</b>

**Note:** Gap between flight and sidewall minimum 2-3 mm

## EC508 Series / Flight Technical Specifications

Possible Flight Indents for EC508 Series	Z	
	mm	inch
Standard, no module cutting	40,0	<b>1.57</b>
Standard, no module cutting	60,0	<b>2.36</b>
Standard, module cutting	80,0	<b>3.15</b>
Standard, no module cutting	100,0	<b>3.94</b>

\*Non-standard flight indent is on request. [www.rodamientos.net](http://www.rodamientos.net)

# EC508 Series *Engineering Information*

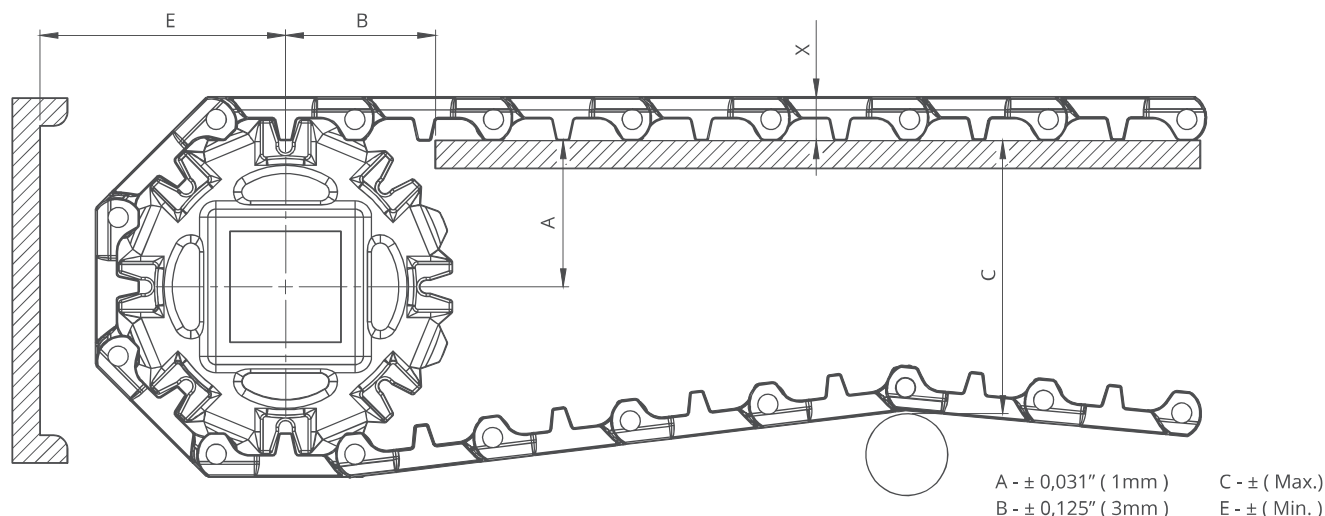

## EC508 Series / Conveyor Frame Dimensions

Sprockets Description			A		B		C		E		X	
Pitch Diameter		No.Teeth	Range (Bottom to Top)		inch	mm	inch	mm	inch	mm	inch	mm
inch	mm		inch	mm								
EC508 C, EC508 PR%22, EC508 PR%13, EC508 PR%11, EC508 FG												
3.23	82,0	6	1.70	43,3	1.72	43,8	2.92	74,3	2.73	69,3	0.63	16,0
4.57	116,0	8	2.34	59,4	2.08	52,7	4.23	107,4	3.36	85,4	0.63	16,0
5.91	150,0	10	2.96	75,3	2.38	60,5	5.52	140,3	3.99	101,3	0.63	16,0
7.23	183,6	12	3.65	92,8	2.58	65,5	6.87	174,6	4.68	118,8	0.63	16,0
EC508 DT												
3.23	82,0	6	1.70	43,3	1.72	43,8	2.92	74,3	2.73	69,3	0.67	17,0
4.57	116,0	8	2.34	59,4	2.08	52,7	4.23	107,4	3.36	85,4	0.67	17,0
5.91	150,0	10	2.96	75,3	2.38	60,5	5.52	140,3	3.99	101,3	0.67	17,0
7.23	183,6	12	3.65	92,8	2.58	65,5	6.87	174,6	4.68	118,8	0.67	17,0
EC508 NT, EC508 FG-NT												
3.23	82,0	6	1.70	43,3	1.72	43,8	2.83	71,8	2.83	71,8	0.73	18,5
4.57	116,0	8	2.34	59,4	2.08	52,7	4.13	104,9	3.46	87,9	0.73	18,5
5.91	150,0	10	2.96	75,3	2.38	60,5	5.43	137,8	4.09	103,8	0.73	18,5
7.23	183,6	12	3.65	92,8	2.58	65,5	6.78	172,1	4.78	121,3	0.73	18,5

## EC508 Series / Slider Support System For Straight Running Belts

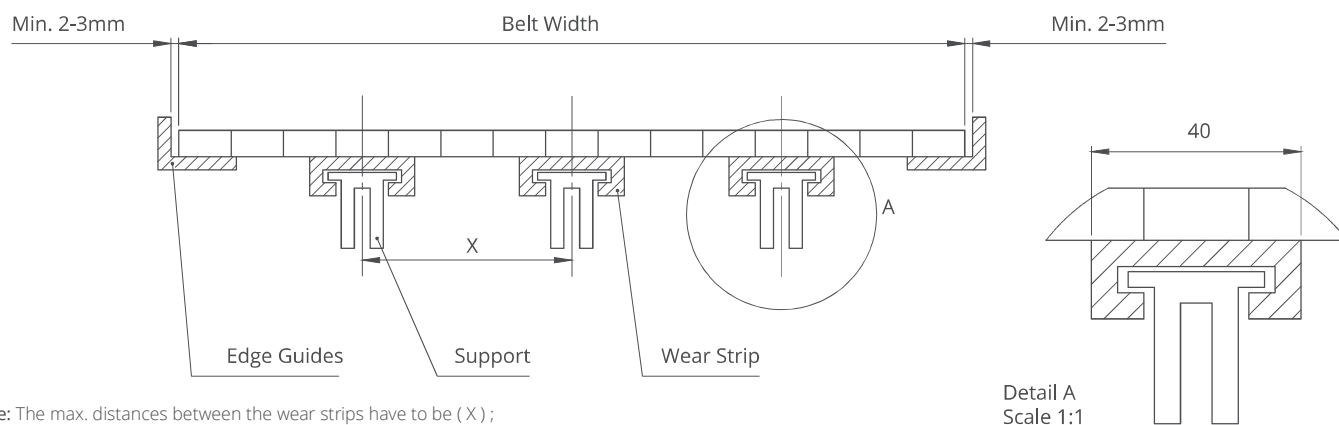

Note: The max. distances between the wear strips have to be (X);  
 125 mm for 2" belts. 80 mm for 1" / 0.5" belts.



# EC508 Series *Engineering Information*

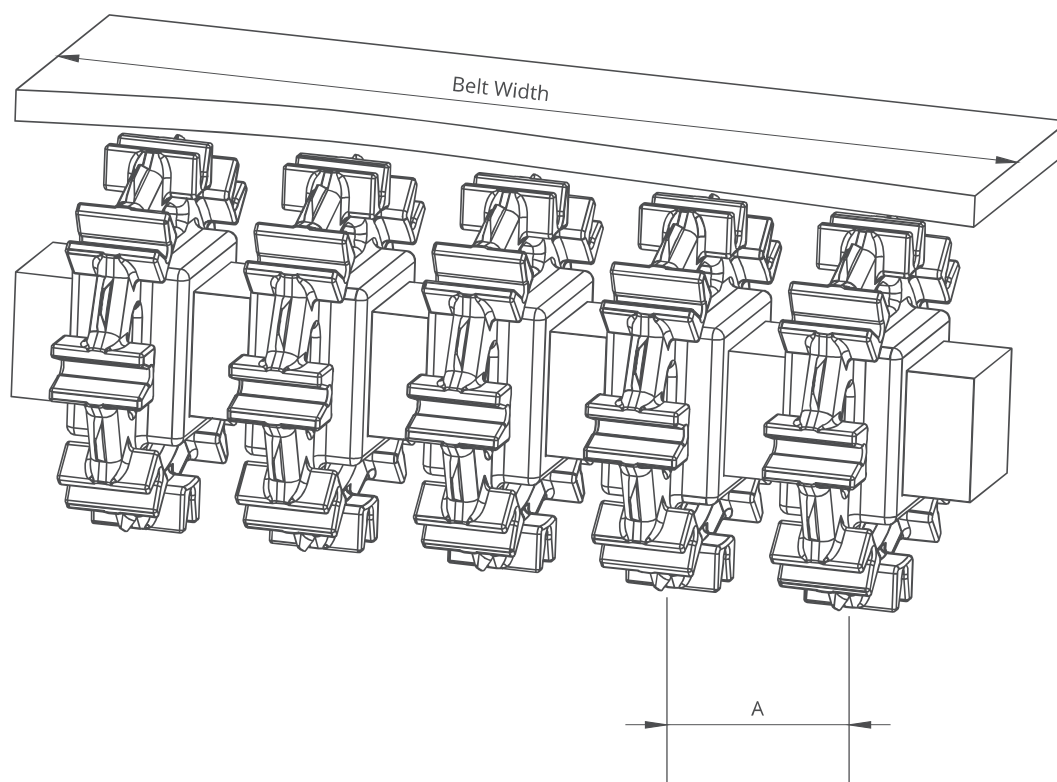

## EC508 Series / Sprockets Arrangement

Standard Belt Width		Number of sprockets per shaft		A (mm/inch)	
mm	inch	Drive Shaft	Return Shaft	Min.	Max.
200,0	<b>7.9</b>	2	2	60/ <b>2.36</b>	150/ <b>5.9</b>
300,0	<b>11.8</b>	3	2	60/ <b>2.36</b>	150/ <b>5.9</b>
400,0	<b>15.7</b>	3	3	60/ <b>2.36</b>	150/ <b>5.9</b>
500,0	<b>19.7</b>	4	3	60/ <b>2.36</b>	150/ <b>5.9</b>
600,0	<b>23.6</b>	4	3	60/ <b>2.36</b>	150/ <b>5.9</b>
700,0	<b>27.6</b>	5	4	60/ <b>2.36</b>	150/ <b>5.9</b>
800,0	<b>31.5</b>	6	4	60/ <b>2.36</b>	150/ <b>5.9</b>
900,0	<b>35.4</b>	6	5	60/ <b>2.36</b>	150/ <b>5.9</b>
1000,0	<b>39.4</b>	7	5	60/ <b>2.36</b>	150/ <b>5.9</b>
1100,0	<b>43.3</b>	7	5	60/ <b>2.36</b>	150/ <b>5.9</b>
1200,0	<b>47.2</b>	8	6	60/ <b>2.36</b>	150/ <b>5.9</b>
1400,0	<b>55.1</b>	9	7	60/ <b>2.36</b>	150/ <b>5.9</b>
1600,0	<b>63.0</b>	10	7	60/ <b>2.36</b>	150/ <b>5.9</b>
1800,0	<b>70.9</b>	11	8	60/ <b>2.36</b>	150/ <b>5.9</b>
2000,0	<b>78.7</b>	12	8	60/ <b>2.36</b>	150/ <b>5.9</b>
2200,0	<b>86.6</b>	13	9	60/ <b>2.36</b>	150/ <b>5.9</b>
2400,0	<b>94.5</b>	14	10	60/ <b>2.36</b>	150/ <b>5.9</b>
2600,0	<b>102.4</b>	15	10	60/ <b>2.36</b>	150/ <b>5.9</b>
2800,0	<b>110.2</b>	16	11	60/ <b>2.36</b>	150/ <b>5.9</b>
3000,0	<b>118.1</b>	17	12	60/ <b>2.36</b>	150/ <b>5.9</b>

Note: Number of sprockets depends on the belt load.

# MD508

*Modular Belt Series*

*MD508 C*

*MD508 FG*

*MD508 PR%25*

*Sprockets & Accessories*

*Engineering Information*









# MD508 C

## Modular Belt Series

- **Corrugated Cardbord Applications**

Down Stackers, Corrugator Take Off, Strap Feed

- **Lumber Industry**

Lumber Transport, Cutting Process

- **Snack Food Applications**

Potato Processing

- **Fruits and Vegetables Applications**

Bulk Feeding, Elevator, Control Sorting Table, Filling

- **Automotive Applications**

Chair Lift - Feeder

- **Packaging Applications**

Bluk Inclines, Box Transport Horizontal



# MD508 C ( Heavy Duty Food Belts )

Pitch:	50,8 mm / <b>2 inch</b>
Belt Surface:	Close, Smooth Surface
Minimum Width:	150 mm / <b>5.90 inch</b>
Open Area (%):	0%
Flight:	Yes ( T50, T100, T150 )
Sidewall:	No
Rod:	Ø7 mm / <b>0.275 inch</b> - Self Lock
Approved:	FDA and EU
Curve:	No
Color:	Additional colors available
Cleanability:	Good
Belt Thickness:	16 mm / <b>0.629 inch</b>



## Product Features and Functional Benefits

- Unique sprocket engagement reduces pulsation and increases load capacity.
- High power, bi-directional belt for long conveyors.
- Unique sprocket engagement - higher product load and longer conveyors.
- Strong and thick product supports allow more load without breaking.
- Impact resistance to with stand heavy objects falling into the belt.

## Available Moulded Module Sizes

- 150 mm / **5.90 inch** module

## MD508 C / Technical Information

BELT MATERIAL	BELT STRENGTH				TEMPERATURE		BELT WEIGHT
	Straight		Curve		°C / °F (min.)	°C / °F (max.)	Kg/m² / lb/ft²
	N/m	lb/ft	N/m	lb/ft			
Polypropylene	37400	<b>2562</b>	-	-	+5 / <b>+41</b>	+90 / <b>+194</b>	8,7 / <b>1.78</b>
Polyethylene	26400	<b>1808</b>	-	-	-73 / <b>-99.4</b>	+66 / <b>+150.8</b>	9,3 / <b>1.90</b>
Acetal	66000	<b>4522</b>	-	-	-43 / <b>-45.4</b>	+110 / <b>+230</b>	13,5 / <b>2.77</b>

- Belt strength and temperature values are maximum on the table.

## MD508 C / Standard Belt Widths

BELT SERIES	WIDTH (W)				Belt With Tolerance (max.)
	PP-PE		POM		
	mm	inch	mm	inch	
MD508 C	150,0	5.91	150,0	5.91	± 0,5 mm
MD508 C	225,0	8.86	225,0	8.86	± 2 mm
MD508 C	300,0	11.81	300,0	11.81	± 2 mm
MD508 C	375,0	14.76	375,0	14.76	± 2 mm
MD508 C	450,0	17.72	450,0	17.72	± 3 mm
MD508 C	525,0	20.67	525,0	20.67	± 3 mm
MD508 C	600,0	23.62	600,0	23.62	± 3 mm
MD508 C	675,0	26.57	675,0	26.57	± 3 mm
MD508 C	750,0	29.53	750,0	29.53	± 4 mm
MD508 C	825,0	32.48	825,0	32.48	± 4 mm
MD508 C	900,0	35.43	900,0	35.43	± 4 mm
MD508 C	975,0	38.38	975,0	38.38	± 5 mm
MD508 C	1050,0	41.34	1050,0	41.34	± 5 mm
MD508 C	1125,0	44.29	1125,0	44.29	± 5 mm

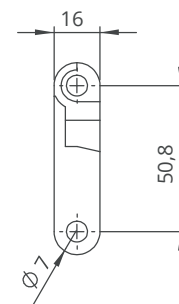
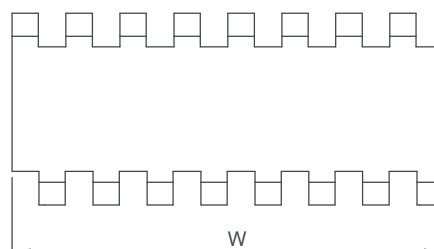

- Standard belt increments 75 mm.
- Non-standard belt increments 18,75 mm.
- Please contact with customer service for precise belt measurements.

# MD508 FG

## Modular Belt Series

- **Bakery Applications**

Oven Infeed/Outfeed, Cooling Lines, Coating Lines, Glazing Lines,  
Freezing Lines, Conditioning Lines

- **Sea Food Applications**

Breeding Machines, Draining Lines

- **Snack Food Applications**

Proofer Lines, Boiler Infeed, Oven Infeed / Outfeed, Cooling Lines

- **Fruits and Vegetables Applications**

Prewashing / Rinsing, Draining

- **Tire Manufacturing Applications**

Mixer Infeed / Outfeed, Extrusion Shower Lines, Cooling Incline,  
Cooling Decline, Cooling Horizontal



# MD508 FG ( Heavy Duty Food Belts )

Pitch:	50,8 mm / <b>2 inch</b>
Belt Surface:	Open, Smooth Surface
Minimum Width:	150 mm / <b>5.90 inch</b>
Open Area (%):	34%. ( Biggest opening 6 x 19,8 mm )
Flight:	Yes ( T50, T100, T150 )
Sidewall:	No
Rod:	Ø7 mm / <b>0.275 inch</b> - Self Lock
Approved:	FDA and EU
Curve:	No
Color:	Additional colors available
Cleanability:	Good
Belt Thickness:	16 mm / <b>0.629 inch</b>



## Product Features and Functional Benefits

- Belt provides optimal open area for drainage and airflow.
- Unique sprocket engagement reduces pulsation and increases load capacity.
- High power, bi-directional belt for long conveyors.
- Unique sprocket engagement - higher product load and longer conveyors.
- Strong and thick product supports allow more load without breaking.
- Impact resistance to with stand heavy objects falling on the belt.

## Available Moulded Module Sizes

- 150 mm / **5.90 inch** module

## MD508 FG / Technical Information

BELT MATERIAL	BELT STRENGTH				TEMPERATURE		BELT WEIGHT
	Straight		Curve		°C / °F (min.)	°C / °F (max.)	Kg/m² / lb/ft²
	N/m	lb/ft	N/m	lb/ft			
Polypropylene	28600	<b>1959</b>	-	-	+5 / <b>+41</b>	+90 / <b>+194</b>	6,8 / <b>1.39</b>
Polyethylene	19800	<b>1356</b>	-	-	-73 / <b>-99.4</b>	+66 / <b>+150.8</b>	7,2 / <b>1.48</b>
Acetal	38500	<b>2637</b>	-	-	-43 / <b>-45.4</b>	+110 / <b>+230</b>	10,2 / <b>2.09</b>

- Belt strength and temperature values are maximum on the table.

## MD508 FG / Standard Belt Widths

BELT SERIES	WIDTH (W)				Belt With Tolerance (max.)
	PP-PE		POM		
	mm	inch	mm	inch	
MD508 FG	150,0	5.91	150,0	5.91	± 1 mm
MD508 FG	225,0	8.86	225,0	8.86	± 2 mm
MD508 FG	300,0	11.81	300,0	11.81	± 2 mm
MD508 FG	375,0	14.76	375,0	14.76	± 2 mm
MD508 FG	450,0	17.72	450,0	17.72	± 3 mm
MD508 FG	525,0	20.67	525,0	20.67	± 3 mm
MD508 FG	600,0	23.62	600,0	23.62	± 3 mm
MD508 FG	675,0	26.57	675,0	26.57	± 4 mm
MD508 FG	750,0	29.53	750,0	29.53	± 4 mm
MD508 FG	825,0	32.48	825,0	32.48	± 4 mm
MD508 FG	900,0	35.43	900,0	35.43	± 4 mm
MD508 FG	975,0	38.38	975,0	38.38	± 5 mm
MD508 FG	1050,0	41.34	1050,0	41.34	± 5 mm
MD508 FG	1125,0	44.29	1125,0	44.29	± 5 mm

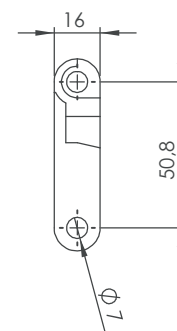
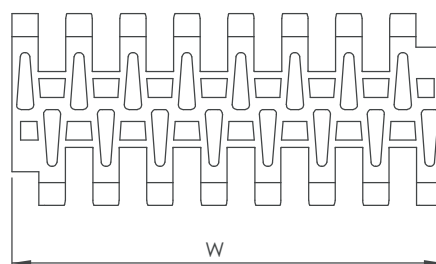

- Standard belt increments 75 mm.
- Non-standard belt increments 18,75 mm.
- Please contact with customer service for precise belt measurements.

# **MD508 PR%25**

## **Modular Belt Series**

- **Meat Applications**

*Dressing Lines, Trim Lines, Elevator, Metal Detector*

- **Poultry Applications**

*Cut-up Lines, Debonning Lines, Chiller Discharge, Rehang / Bird Accumulation, Freezing Lines, Elevators*

- **Sea Food Applications**

*Draining, Elevator*

- **Snack Food Applications**

*Can Draining*

- **Fruits and Vegetables Applications**

*Prewashing / Rinsing, Draining, Peeling, Elevator, Blanching*



# MD508 PR%25 ( Heavy Duty Food Belts )

Pitch:	50,8 mm / <b>2 inch</b>
Belt Surface:	Open, Smooth Surface
Minimum Width:	150 mm / <b>5.90 inch</b>
Open Area (%):	25%. ( Biggest opening 3 x 19,5 mm )
Flight:	Yes ( T50, T100, T150 )
Sidewall:	No
Rod:	Ø7 mm / <b>0.275 inch</b> - Self Lock
Approved:	FDA and EU
Curve:	No
Color:	Additional colors available
Cleanability:	Good
Belt Thickness:	16 mm / <b>0.629 inch</b>



## Product Features and Functional Benefits

- Belt provides optimal open area for drainage and airflow.
- Unique sprocket engagement reduces pulsation and increases load capacity.
- High power, bi-directional belt for long conveyors.
- Unique sprocket engagement - higher product load and longer conveyors.
- Strong and thick product supports allow more load without breaking.
- Impact resistance to with stand heavy objects falling on the belt.

## Available Moulded Module Sizes

- 150 mm / **5.90 inch** module

## MD508 PR%25 / Technical Information

BELT MATERIAL	BELT STRENGTH				TEMPERATURE		BELT WEIGHT
	Straight		Curve		°C (min.) - °F (min.)	°C (max.) - °F (max.)	Kg/m² - lb/ft²
	N/m	lb/ft	N/m	lb/ft			
Polypropylene	41800	<b>2863</b>	-	-	+5 / <b>+42.8</b>	+90 / <b>+194</b>	8,0 - <b>1.64</b>
Polyethylene	26400	<b>1808</b>	-	-	-73 / <b>-99.4</b>	+66 / <b>+150.8</b>	8,3 - <b>1.70</b>
Acetal	60500	<b>4145</b>	-	-	-43 / <b>-45.4</b>	+110 / <b>+230</b>	12,0 - <b>2.46</b>

- Belt strength and temperature values are maximum on the table.

## MD508 PR%25 / Standard Belt Widths

BELT SERIES	WIDTH (W)				Belt With Tolerance (max.)
	PP-PE		POM		
	mm	inch	mm	inch	
MD508 PR25	150,0	5.91	150,0	5.91	± 1 mm
MD508 PR25	225,0	8.86	225,0	8.86	± 2 mm
MD508 PR25	300,0	11.81	300,0	11.81	± 2 mm
MD508 PR25	375,0	14.76	375,0	14.76	± 2 mm
MD508 PR25	450,0	17.72	450,0	17.72	± 3 mm
MD508 PR25	525,0	20.67	525,0	20.67	± 3 mm
MD508 PR25	600,0	23.62	600,0	23.62	± 3 mm
MD508 PR25	675,0	26.57	675,0	26.57	± 4 mm
MD508 PR25	750,0	29.53	750,0	29.53	± 4 mm
MD508 PR25	825,0	32.48	825,0	32.48	± 4 mm
MD508 PR25	900,0	35.43	900,0	35.43	± 4 mm
MD508 PR25	975,0	38.38	975,0	38.38	± 5 mm
MD508 PR25	1050,0	41.34	1050,0	41.34	± 5 mm
MD508 PR25	1125,0	44.29	1125,0	44.29	± 5 mm

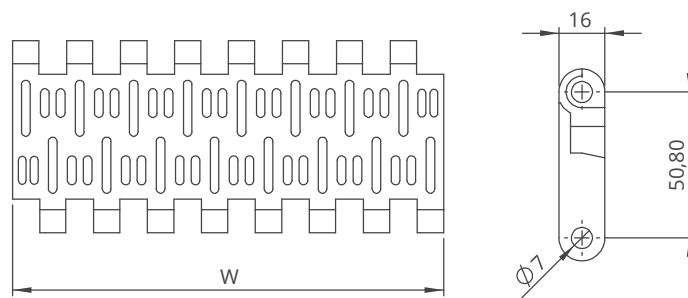

- Standard belt increments 75 mm.
- Non-standard belt increments 18,75 mm.
- Please contact with customer service for precise belt measurements.

[www.rodamientos.net](http://www.rodamientos.net)

# MD508 Series Sprockets and Technical Specifications



Z8



Z10



Z12

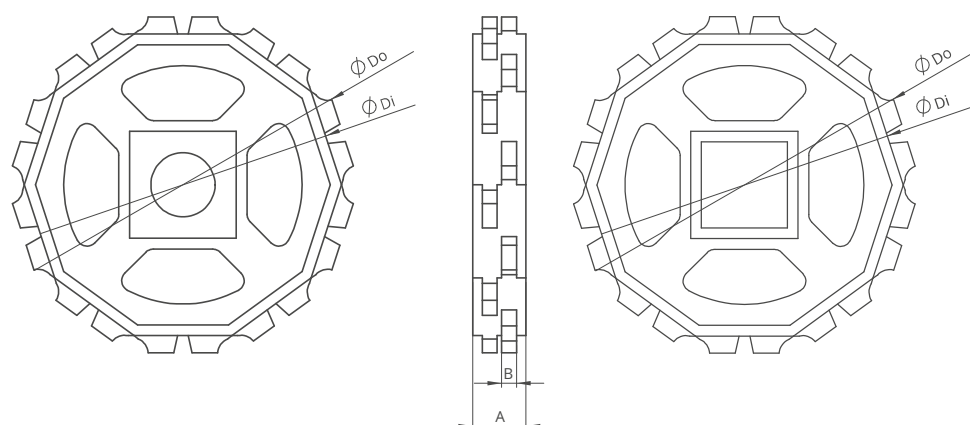

## MD508 Series / Standard Sprockets Dimensions

NO. TEETH	Di mm/inch	Do mm/inch	B mm/inch	A mm/inch	Square Bore (Q) mm/inch	Round Bore (R) mm/inch	PRODUCT CODE	
							Square Type (Q)	Round Type (R)
Z8	107,37 / <b>4.23</b>	127,35 / <b>5.01</b>	7 / <b>0.27</b>	40 / <b>1.57</b>	40 / <b>1.5</b>	25-30 / <b>1-1.25</b>	MD508SQZ8*POM	MD508SRZ8*POM
Z10	141,27 / <b>5.56</b>	160,14 / <b>6.30</b>	7 / <b>0.27</b>	40 / <b>1.57</b>	40-60 / <b>1.5-2.5</b>	25-30 / <b>1-1.25</b>	MD508SQZ10*POM	MD508SRZ10*POM
Z12	174,71 / <b>6.87</b>	193,24 / <b>7.61</b>	7 / <b>0.27</b>	40 / <b>1.57</b>	40-60 / <b>1.5-2.5</b>	25-30 / <b>1-1.25</b>	MD508SQZ12*POM	MD508SRZ12*POM

\*Other sprockets and hub sizes are manufactured up to request.

\*PA (Polyamide) and PP (Polypropylene) sprockets raw material is available on request.

**\*Machined Split Sprockets are available for each size.**



Clamp



Machined Split Sprocket

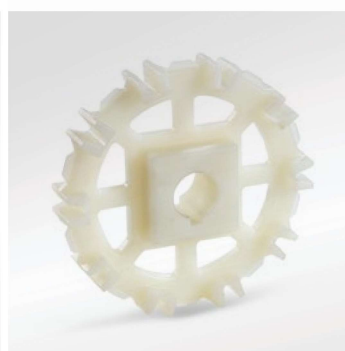

Moulded Sprocket

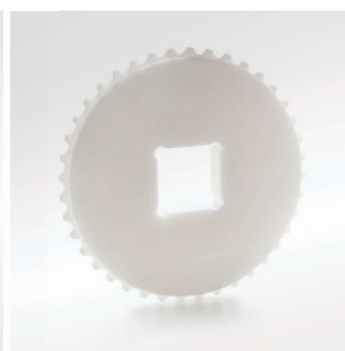

Machined Sprocket



# MD508 Series *Accessories and Technical Specifications*



## MD508 Series / Flight Dimensions

MD508 Series / Flights				
PRODUCT CODE	Flight Height (mm/ <b>inch</b> )	Flight Width (mm/ <b>inch</b> )	PRODUCT CODE	Sidewall Height (mm/ <b>inch</b> )
MD508T50	50 / <b>2</b>	150 / <b>5.90</b>	-	-
MD508T100	100 / <b>4</b>	150 / <b>5.90</b>	-	-
MD508T150	150 / <b>6</b>	150 / <b>5.90</b>	-	-

## MD508 Series / Flight Technical Specifications

Possible Flight Indents for MD508 Series	Z	
	mm	inch
Standard, module cutting	37,5	<b>1.48</b>
Standard, module cutting	56,0	<b>2.20</b>
Standard, no module cutting	75,0	<b>2.95</b>
Standard, module cutting	112,5	<b>4.43</b>

\*Non-standard flight indent is on request.

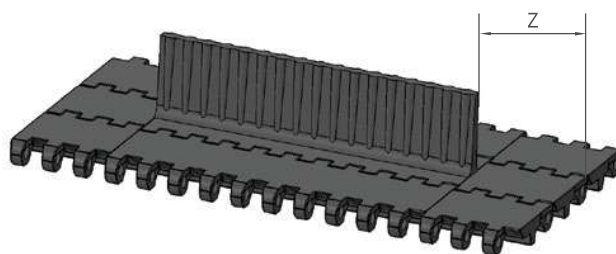

# MD508 Series *Engineering Information*

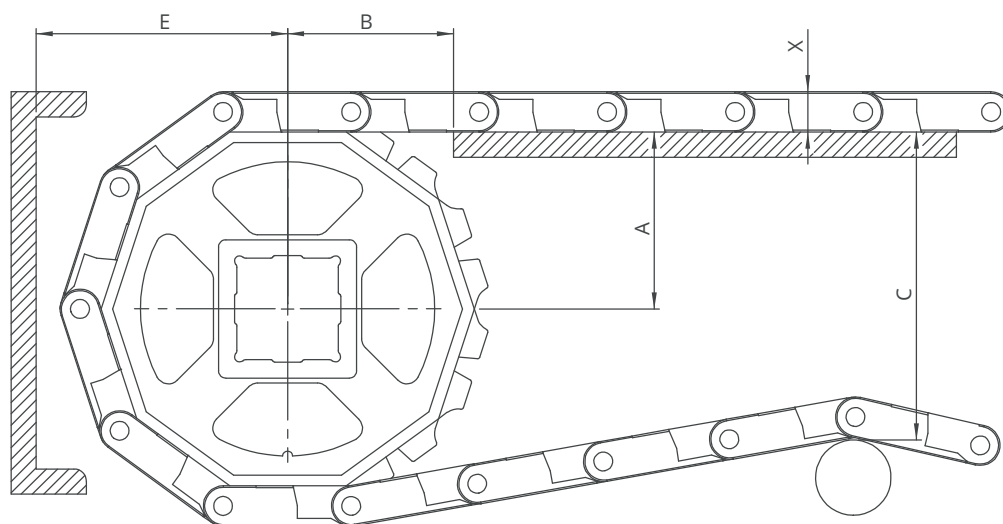

A -  $\pm 0,031"$  ( 1mm )      C -  $\pm$  ( Max. )  
 B -  $\pm 0,125"$  ( 3mm )      E -  $\pm$  ( Min. )

## MD508 Series / Conveyor Frame Dimensions

Sprockets Description			A		B		C		E		X	
Pitch Diameter		No.Teeth	Range (Bottom to Top)		inch	mm	inch	mm	inch	mm	inch	mm
inch	mm		inch	mm								
MD508 C, MD508 PR%25, MD508 FG												
4.65	118,0	8	2.29	58,1	2.94	74,8	3.79	96,2	3.11	79,1	0.63	16,0
5.94	151,0	10	2.92	74,3	3.57	90,7	5.06	128,5	3.75	95,3	0.63	16,0
7.32	186,0	12	3.56	90,5	4.20	106,7	6.33	160,9	4.39	111,4	0.63	16,0

## MD508 Series / Slider Support System For Straight Running Belts

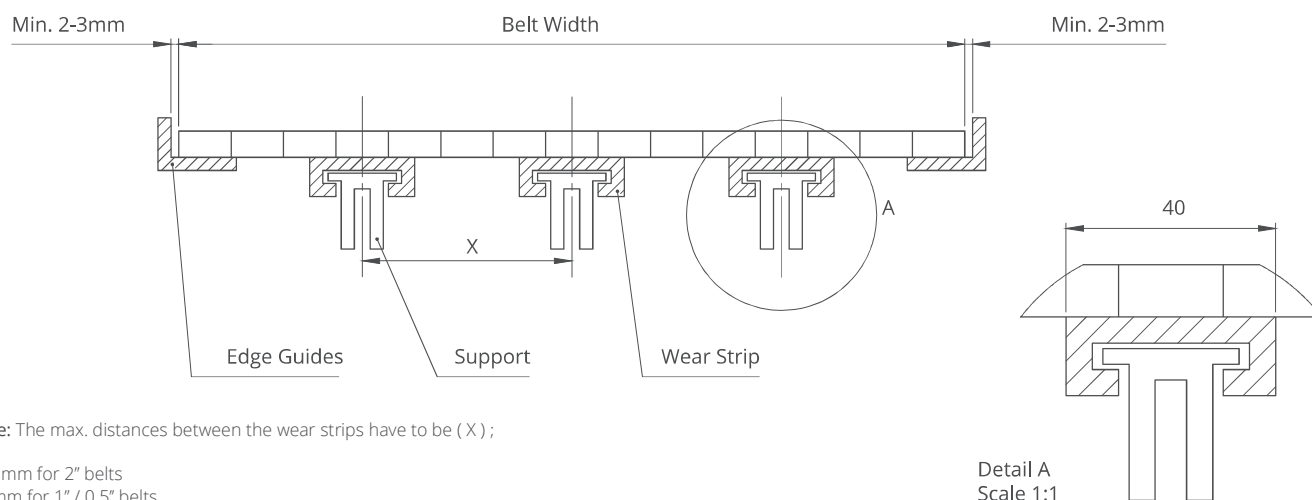

Note: The max. distances between the wear strips have to be ( X );

125 mm for 2" belts  
 80 mm for 1" / 0.5" belts

# MD508 Series *Engineering Information*

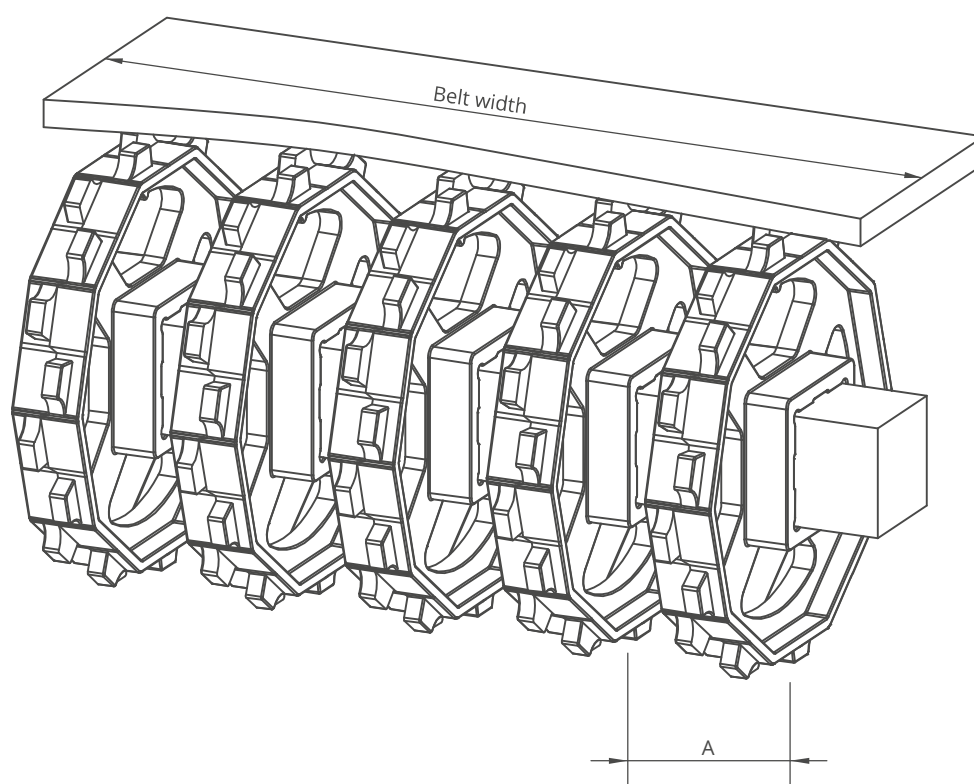

## MD508 Series / Sprockets Arrangement

Standard Belt Width		Number of sprockets per shaft		A (mm/inch)	
mm	inch	Drive Shaft	Return Shaft	Min.	Max.
150,0	<b>5.90</b>	2	2	60/ <b>2.36</b>	150/ <b>5.9</b>
225,0	<b>8.86</b>	3	2	60/ <b>2.36</b>	150/ <b>5.9</b>
300,0	<b>11.81</b>	3	3	60/ <b>2.36</b>	150/ <b>5.9</b>
375,0	<b>14.76</b>	4	3	60/ <b>2.36</b>	150/ <b>5.9</b>
450,0	<b>17.72</b>	4	3	60/ <b>2.36</b>	150/ <b>5.9</b>
525,0	<b>20.67</b>	5	4	60/ <b>2.36</b>	150/ <b>5.9</b>
600,0	<b>23.62</b>	5	4	60/ <b>2.36</b>	150/ <b>5.9</b>
675,0	<b>26.57</b>	6	5	60/ <b>2.36</b>	150/ <b>5.9</b>
750,0	<b>29.53</b>	6	5	60/ <b>2.36</b>	150/ <b>5.9</b>
825,0	<b>32.48</b>	6	5	60/ <b>2.36</b>	150/ <b>5.9</b>
900,0	<b>35.43</b>	7	6	60/ <b>2.36</b>	150/ <b>5.9</b>
975,0	<b>38.39</b>	8	7	60/ <b>2.36</b>	150/ <b>5.9</b>
1050,0	<b>41.34</b>	9	7	60/ <b>2.36</b>	150/ <b>5.9</b>
1125,0	<b>44.29</b>	10	8	60/ <b>2.36</b>	150/ <b>5.9</b>
1200,0	<b>47.24</b>	11	8	60/ <b>2.36</b>	150/ <b>5.9</b>
1275,0	<b>50.20</b>	12	9	60/ <b>2.36</b>	150/ <b>5.9</b>
1350,0	<b>53.15</b>	13	10	60/ <b>2.36</b>	150/ <b>5.9</b>
1425,0	<b>56.10</b>	14	10	60/ <b>2.36</b>	150/ <b>5.9</b>
1500,0	<b>59.06</b>	15	11	60/ <b>2.36</b>	150/ <b>5.9</b>
1575,0	<b>62.00</b>	16	12	60/ <b>2.36</b>	150/ <b>5.9</b>

Note: Number of sprockets depends on the belt load.



# HP508

## Modular Belt Series

**HP508 RR**

**HP508 FG**

**HP508 C**

**Sprockets & Accessories**  
**Engineering Information**









# HP508 RR

## Modular Belt Series

- **Snack Foods Applications**

Cooling Line

- **Fruits and Vegetables Applications**

Palletizing - Epalletizing, Sterilization Conveyance

- **Automotive Applications**

Battery Filling

- **Tire Manufacturing Applications**

Dip Tank

- **Packaging Applications**

Accumulation, Palletizing - Depalletizing

- **Textile Applications**

Dyeing

- **Beverages and Bottling Applications**

Glass Palletizing - Depalletizing, Pasteurizers - Warmers, Accumulation Tables

- **Can Manufacturing Applications**

Accumulation Tables, Palletizing / Depalletizing



# HP508 RR

Pitch:	50,8 mm / <b>2 inch</b>
Belt Surface:	Open, Raised Rib Surface
Minimum Width:	152,4 mm / <b>6 inch</b>
Open Area (%):	36%. ( Biggest opening 3,5 x 18,5 mm )
Flight:	No
Sidewall:	No
Rod:	Ø7 mm / <b>0.275 inch</b> - Self Lock
Approved:	FDA and EU
Curve:	No
Color:	Additional colors available
Cleanability:	Good
Belt Thickness:	24 mm / <b>0.945 inch</b>
Comb:	Yes



## Product Features and Functional Benefits

- Less friction and product contact for easy cooking, cooling and freezing of products.
- Reduces back line pressure with up to 70%.
- Reduced dirt and oxide build up due to self cleaning surface.
- Finger plate for trouble free transfer.
- Unique sprocket engagement reduces pulsation and increases load capacity.

## Available Moulded Module Sizes

- 152,4 mm / **6 inch** module
- 76,2 mm / **3 inch** module

## HP508 RR / Technical Information

BELT MATERIAL	BELT STRENGTH				TEMPERATURE		BELT WEIGHT
	Straight		Curve		°C (min.) - °F (min.)	°C (max.) - °F (max.)	Kg/m² - lb/ft²
	N/m	lb/ft	N/m	lb/ft			
Polypropylene	34200	<b>2343</b>	-	-	+5 / <b>+42.8</b>	+90 / <b>+194</b>	8,9 - <b>1.82</b>
PPHomopolymer	34200	<b>2343</b>	-	-	+5 / <b>+42.8</b>	+118 / <b>+244</b>	8,9 - <b>1.82</b>
Acetal	45500	<b>3117</b>	-	-	-43 / <b>-45.4</b>	+110 / <b>+230</b>	13,5 - <b>2.76</b>

- Belt strength and temperature values are maximum on the table.

## HP508 RR / Standard Belt Widths

BELT SERIES	WIDTH (W)				Belt With Tolerance (max.)
	PP-PPH		POM		
	mm	inch	mm	inch	
HP508 RR	152,4	<b>6.0</b>	152,4	<b>6.0</b>	± 0,5 mm
HP508 RR	228,6	<b>9.0</b>	228,6	<b>9.0</b>	± 2 mm
HP508 RR	304,8	<b>12.0</b>	304,8	<b>12.0</b>	± 2 mm
HP508 RR	381,0	<b>15.0</b>	381,0	<b>15.0</b>	± 2 mm
HP508 RR	457,2	<b>18.0</b>	457,2	<b>18.0</b>	± 3 mm
HP508 RR	533,4	<b>21.0</b>	533,4	<b>21.0</b>	± 3 mm
HP508 RR	609,6	<b>24.0</b>	609,6	<b>24.0</b>	± 3 mm
HP508 RR	685,8	<b>27.0</b>	685,8	<b>27.0</b>	± 3 mm
HP508 RR	762,0	<b>30.0</b>	762,0	<b>30.0</b>	± 4 mm
HP508 RR	838,2	<b>33.0</b>	838,2	<b>33.0</b>	± 4 mm
HP508 RR	914,4	<b>36.0</b>	914,4	<b>36.0</b>	± 4 mm
HP508 RR	990,6	<b>39.0</b>	990,6	<b>39.0</b>	± 5 mm
HP508 RR	1066,8	<b>42.0</b>	1066,8	<b>42.0</b>	± 5 mm
HP508 RR	1143,0	<b>45.0</b>	1143,0	<b>45.0</b>	± 5 mm

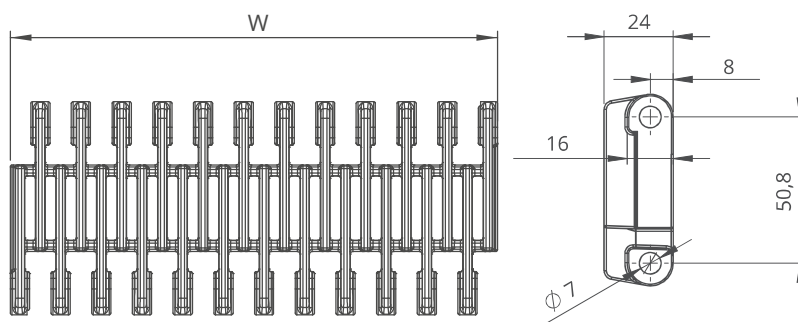

- Standard belt increments 76,2 mm.
- Non-standart belt increments 38,1 mm.
- Please contact with customer service for precise belt measurements.



# HP508 FG

## Modular Belt Series

- **Snack Foods Applications**

Cooling Line

- **Fruits and Vegetables Applications**

Palletizing - Epalletizing, Sterilization Conveyance

- **Automotive Applications**

Battery Filling

- **Tire Manufacturing Applications**

Dip Tank

- **Packaging Applications**

Accumulation, Palletizing - Depalletizing

- **Textile Applications**

Dyeing

- **Beverages and Bottling Applications**

Glass Palletizing - Depalletizing, Pasteurizers - Warmers, Accumulation Tables

- **Can Manufacturing Applications**

Accumulation Tables, Palletizing / Depalletizing



# HP508 FG ( Battery Belt )

Pitch:	50,8 mm / <b>2 inch</b>
Belt Surface:	Open, Smooth Surface
Minimum Width:	152,4 mm / <b>6 inch</b>
Open Area (%):	36%. ( Biggest opening 3,5 x 18,5 mm )
Flight:	No
Sidewall:	No
Rod:	Ø7 mm / <b>0.276 inch</b> - Self Lock
Approved:	FDA and EU
Curve:	No
Color:	Additional colors available
Cleanability:	Good
Belt Thickness:	16 mm / <b>0.630 inch</b>



## Product Features and Functional Benefits

- Belt provides optimal open area for drainage and airflow.
- Unique sprocket engagement reduces pulsation and increases load capacity.
- High power, bi-directional belt for long conveyors.
- Unique sprocket engagement - higher product load and longer conveyors.
- Strong and thick product supports allow more load without breaking.
- Impact resistance to with stand heavy objects falling on the belt.

## Available Moulded Module Sizes

- 152,4 mm / **6 inch** module
- 76,2 mm / **3 inch** module

## HP508 FG / Technical Information

BELT MATERIAL	BELT STRENGTH				TEMPERATURE		BELT WEIGHT
	Straight		Curve		°C (min.) - °F (min.)	°C (max.) - °F (max.)	Kg/m² - lb/ft²
	N/m	lb/ft	N/m	lb/ft			
Polypropylene	34200	<b>2343</b>	-	-	+5 / <b>+42.8</b>	+90 / <b>+194</b>	8,9 - <b>1.82</b>
Polyethylene	-	-	-	-	-	-	-
Acetal	-	-	-	-	-	-	-

- Belt strength and temperature values are maximum on the table.

## HP508 FG / Standard Belt Widths

BELT SERIES	WIDTH (W)				Belt With Tolerance (max.)
	PP		POM		
	mm	inch	mm	inch	
HP508 FG	152,4	6.0	-	-	± 0,5 mm
HP508 FG	228,6	9.0	-	-	± 2 mm
HP508 FG	304,8	12.0	-	-	± 2 mm
HP508 FG	381,0	15.0	-	-	± 2 mm
HP508 FG	457,2	18.0	-	-	± 3 mm
HP508 FG	533,4	21.0	-	-	± 3 mm
HP508 FG	609,6	24.0	-	-	± 3 mm
HP508 FG	685,8	27.0	-	-	± 3 mm
HP508 FG	762,0	30.0	-	-	± 4 mm
HP508 FG	838,2	33.0	-	-	± 4 mm
HP508 FG	914,4	36.0	-	-	± 4 mm
HP508 FG	990,6	39.0	-	-	± 5 mm
HP508 FG	1066,8	42.0	-	-	± 5 mm
HP508 FG	1143,0	45.0	-	-	± 5 mm

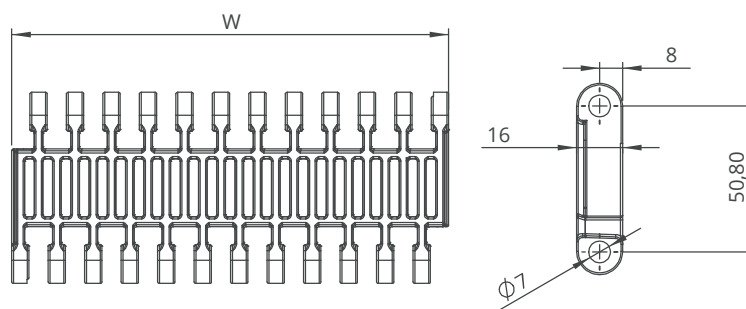

- Standard belt increments 76,2 mm.
- Non-standart belt increments 38,1 mm.
- Please contact with customer service for precise belt measurements.



# ***HP508 C***

## ***Modular Belt Series***

- **Snack Food Applications**

*Potato Processing*

- **Fruits and Vegetables Applications**

*Bulk Feeding, Elevator, Control Sorting Table, Filling*

- **Automotive Applications**

*Chair Lift - Feeder*

- **Packaging Applications**

*Bluk Inclines, Box Transport Horizontal*

# HP508 C

Pitch:	50,8 mm / <b>2 inch</b>
Belt Surface:	Close, Smooth Surface
Minimum Width:	152,4 mm / <b>6 inch</b>
Open Area (%):	0%
Flight:	No
Sidewall:	No
Rod:	Ø7 mm / <b>0.275 inch</b> - Self Lock
Approved:	FDA and EU
Curve:	No
Color:	Additional colors available
Cleanability:	Good
Belt Thickness:	16 mm / <b>0.629 inch</b>



## Product Features and Functional Benefits

- Unique sprocket engagement reduces pulsation and increases load capacity.
- High power, bi-directional belt for long conveyors.
- Unique sprocket engagement - higher product load and longer conveyors.
- Strong and thick product supports allow more load without breaking.
- Impact resistance to withstand heavy objects falling into the belt.
- Close transfer applications.

## Available Moulded Module Sizes

- 152,4 mm / **6 inch** module
- 76,2 mm / **3 inch** module

## HP508 C / Technical Information

BELT MATERIAL	BELT STRENGTH				TEMPERATURE		BELT WEIGHT
	Straight		Curve		°C (min.) - °F (min.)	°C (max.) - °F (max.)	Kg/m² - lb/ft²
	N/m	lb/ft	N/m	lb/ft			
Polypropylene	34200	<b>2343</b>	-	-	+5 / <b>+42.8</b>	+90 / <b>+194</b>	7,8 - <b>1.60</b>
Polyethylene	-	-	-	-	-	-	-
Acetal	45500	<b>3117</b>	-	-	-43 / <b>-45.4</b>	+110 / <b>+230</b>	12,2 - <b>2.50</b>

- Belt strength and temperature values are maximum on the table.

## HP508 C / Standard Belt Widths

BELT SERIES	WIDTH (W)				Belt With Tolerance (max.)
	PP		POM		
	mm	inch	mm	inch	
HP508 C	152,4	6.0	152,4	6.0	± 0,5 mm
HP508 C	228,6	9.0	228,6	9.0	± 2 mm
HP508 C	304,8	12.0	304,8	12.0	± 2 mm
HP508 C	381,0	15.0	381,0	15.0	± 2 mm
HP508 C	457,2	18.0	457,2	18.0	± 3 mm
HP508 C	533,4	21.0	533,4	21.0	± 3 mm
HP508 C	609,6	24.0	609,6	24.0	± 3 mm
HP508 C	685,8	27.0	685,8	27.0	± 3 mm
HP508 C	762,0	30.0	762,0	30.0	± 4 mm
HP508 C	838,2	33.0	838,2	33.0	± 4 mm
HP508 C	914,4	36.0	914,4	36.0	± 4 mm
HP508 C	990,6	39.0	990,6	39.0	± 5 mm
HP508 C	1066,8	42.0	1066,8	42.0	± 5 mm
HP508 C	1143,0	45.0	1143,0	45.0	± 5 mm

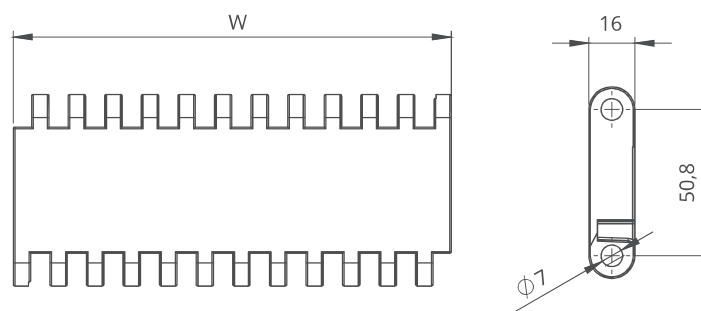

- Standard belt increments 76,2 mm.
- Non-standart belt increments 38,1 mm.
- Please contact with customer service for precise belt measurements.



# HP508 Series Sprockets and Technical Specifications



Z8



Z10

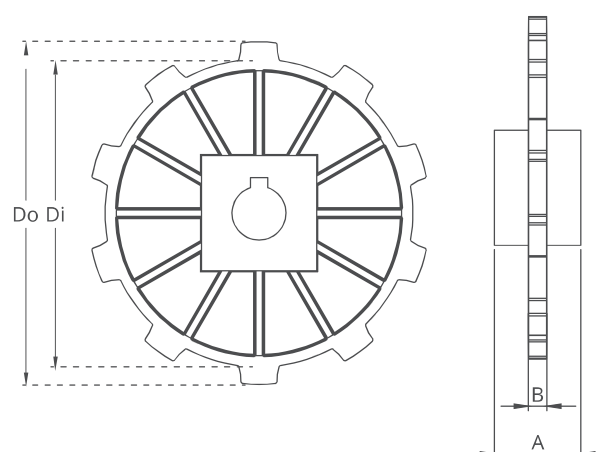
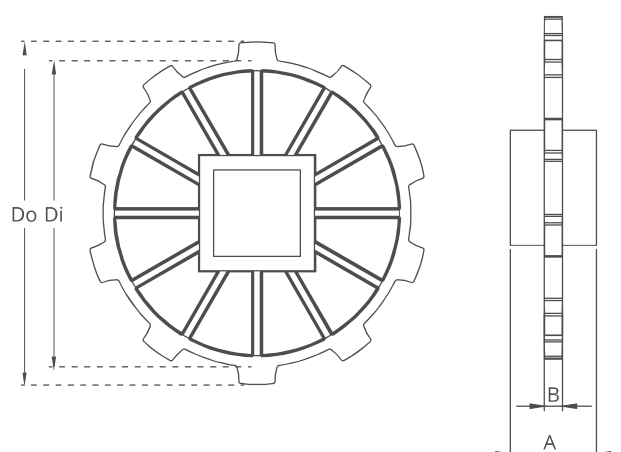

## HP508 Series / Standard Sprockets Dimensions

NO. TEETH	Di mm/inch	Do mm/inch	B mm/inch	A mm/inch	Square Bore (Q) mm/inch	Round Bore (R) mm/inch	PRODUCT CODE	
							Square Type (Q)	Round Type (R)
Z8	109,0 / <b>4.29</b>	125,0 / <b>4.92</b>	9,0 / <b>0.35</b>	40 / <b>1.57</b>	40 / <b>1.5</b>	25-30 / <b>1-1.25</b>	HP508SQZ8*PA	HP508SRZ8*PA
Z10	142,0 / <b>5.59</b>	159,0 / <b>6.22</b>	9,0 / <b>0.35</b>	40 / <b>1.57</b>	40 / <b>1.5</b>	25-30 / <b>1-1.25</b>	HP508SQZ10*PA	HP508SRZ10*PA

\*Other sprockets and hub sizes are manufactured up to request.

\*POM (Acetal) and PP (Polypropylene) sprockets raw material is available on request.

**\*Machined Split Sprockets are available for each size.**



Clamp



Machined Split Sprocket

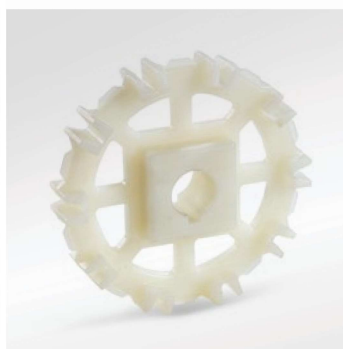

Moulded Sprocket

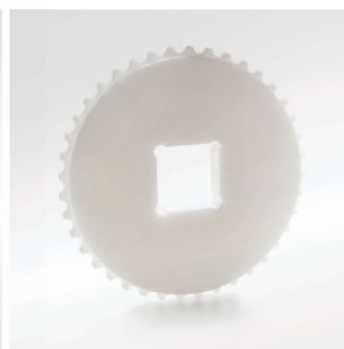

Machined Sprocket

# HP508 Series *Accessories and Technical Specifications*

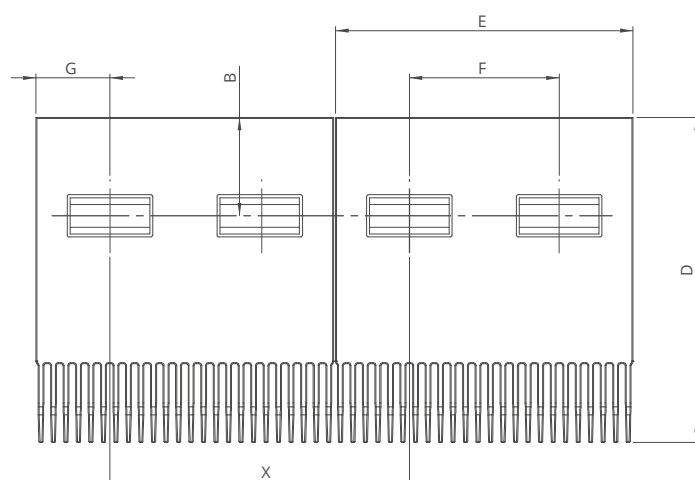
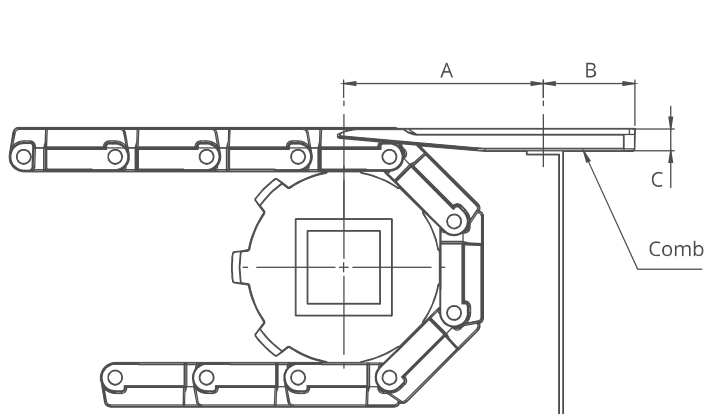

## HP508 Series / Comb Technical Specifications

	inch	mm
A	3.94	100,0
B	1.97	50,0
C	0.47	12,0
D	6.50	165,0
E	5.94	151,0
F	2.99	76,0
G	1.48	37,5
X	5.98	152,0



# HP508 Series *Engineering Information*

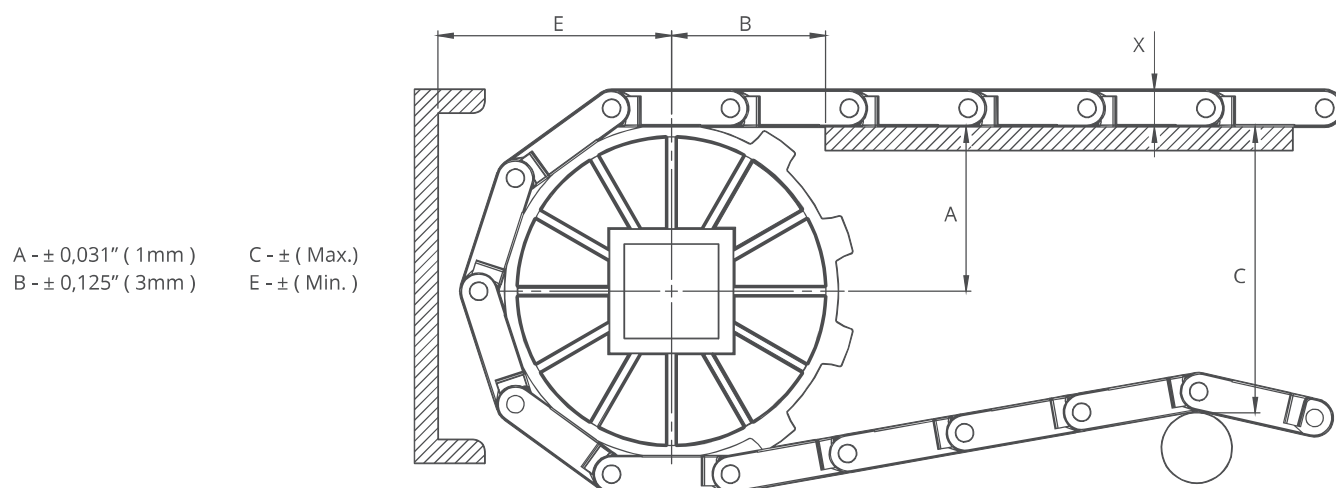

## HP508 Series / Conveyor Frame Dimensions

Sprockets Description			A		B		C		E		X	
Pitch Diameter		No.Teeth	Range (Bottom to Top)		inch	mm	inch	mm	inch	mm	inch	mm
inch	mm		inch	mm								
HP508 C, HP508 FG												
4.57	116,0	8	2.29	58,25	2.28	58,0	3.46	88,0	3.32	84,25	0.63	16,0
5.98	152,0	10	2.93	74,5	2.60	66,0	4.80	122,0	3.96	100,5	0.63	16,0
HP508 RR												
4.57	116,0	8	2.29	58,25	2.28	58,0	3.78	96,0	3.63	92,25	0.94	24,0
5.98	152,0	10	2.93	74,5	2.60	66,0	5.12	130,0	4.27	108,5	0.94	24,0

## HP508 Series / Slider Support System For Straight Running Belts

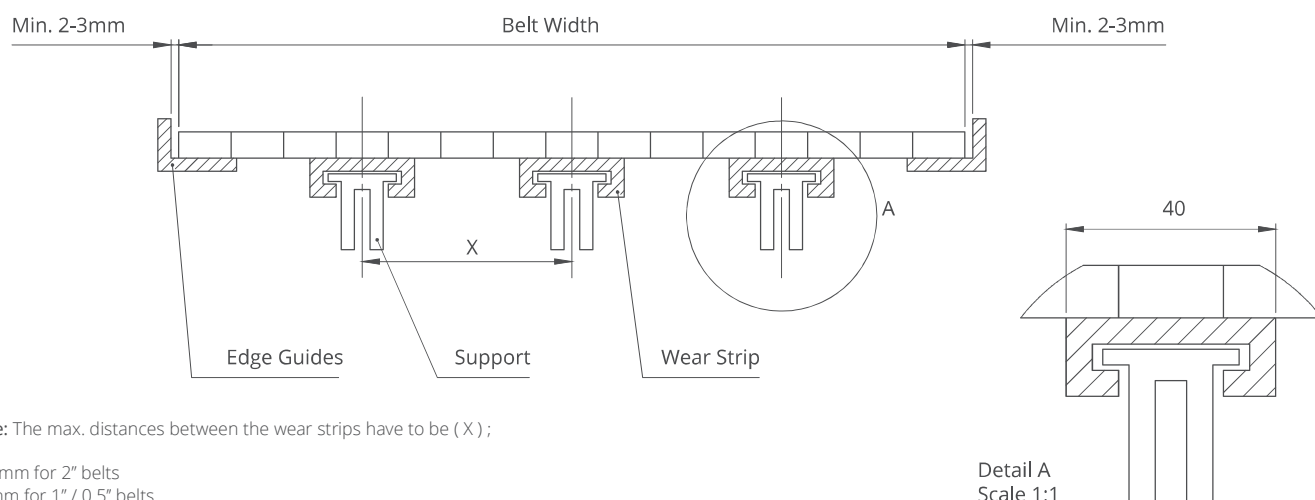

**Note:** The max. distances between the wear strips have to be ( X ) ;

125 mm for 2" belts  
 80 mm for 1" / 0.5" belts

# HP508 Series *Engineering Information*

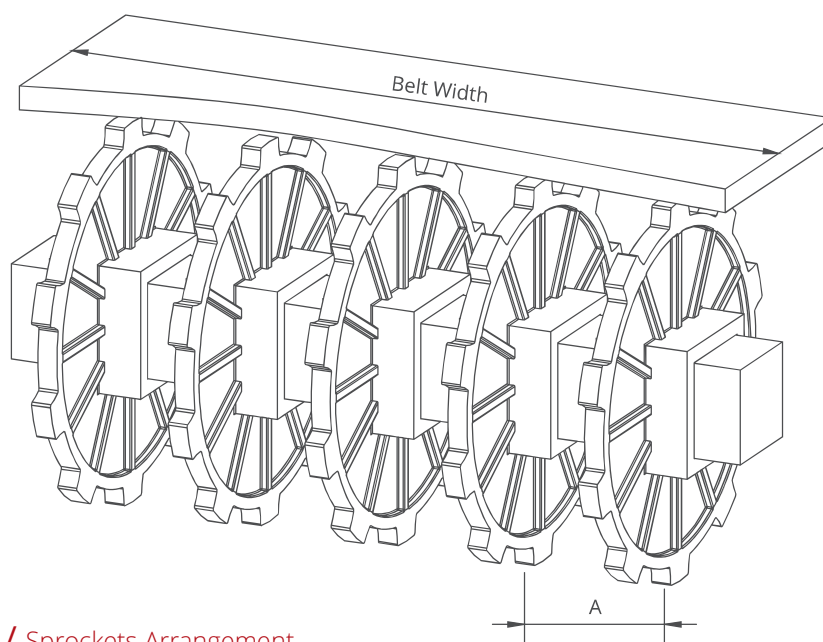

## HP508 Series / Sprockets Arrangement

Standard Belt Width		Number of sprockets per shaft		A (mm/inch)	
mm	inch	Drive Shaft	Return Shaft	Min.	Max.
152,4	<b>6.0</b>	2	2	60/ <b>2.36</b>	150/ <b>5.9</b>
228,6	<b>9.0</b>	2	2	60/ <b>2.36</b>	150/ <b>5.9</b>
304,8	<b>12.0</b>	3	2	60/ <b>2.36</b>	150/ <b>5.9</b>
381,0	<b>15.0</b>	3	3	60/ <b>2.36</b>	150/ <b>5.9</b>
457,2	<b>18.0</b>	3	3	60/ <b>2.36</b>	150/ <b>5.9</b>
533,4	<b>21.0</b>	4	3	60/ <b>2.36</b>	150/ <b>5.9</b>
609,6	<b>24.0</b>	4	3	60/ <b>2.36</b>	150/ <b>5.9</b>
685,8	<b>27.0</b>	5	3	60/ <b>2.36</b>	150/ <b>5.9</b>
762,0	<b>30.0</b>	5	4	60/ <b>2.36</b>	150/ <b>5.9</b>
838,2	<b>33.0</b>	6	4	60/ <b>2.36</b>	150/ <b>5.9</b>
914,4	<b>36.0</b>	6	4	60/ <b>2.36</b>	150/ <b>5.9</b>
990,6	<b>39.0</b>	6	4	60/ <b>2.36</b>	150/ <b>5.9</b>
1066,8	<b>42.0</b>	7	5	60/ <b>2.36</b>	150/ <b>5.9</b>
1143,0	<b>45.0</b>	7	5	60/ <b>2.36</b>	150/ <b>5.9</b>
1219,2	<b>48.0</b>	8	6	60/ <b>2.36</b>	150/ <b>5.9</b>
1295,4	<b>51.0</b>	8	6	60/ <b>2.36</b>	150/ <b>5.9</b>
1371,6	<b>54.0</b>	9	6	60/ <b>2.36</b>	150/ <b>5.9</b>
1447,8	<b>57.0</b>	9	7	60/ <b>2.36</b>	150/ <b>5.9</b>
1524,0	<b>60.0</b>	9	7	60/ <b>2.36</b>	150/ <b>5.9</b>
1600,2	<b>63.0</b>	10	7	60/ <b>2.36</b>	150/ <b>5.9</b>
1676,4	<b>66.0</b>	10	8	60/ <b>2.36</b>	150/ <b>5.9</b>
1752,6	<b>69.0</b>	11	8	60/ <b>2.36</b>	150/ <b>5.9</b>
1828,8	<b>72.0</b>	12	9	60/ <b>2.36</b>	150/ <b>5.9</b>
1905,0	<b>75.0</b>	12	9	60/ <b>2.36</b>	150/ <b>5.9</b>
1981,2	<b>78.0</b>	12	9	60/ <b>2.36</b>	150/ <b>5.9</b>
2057,4	<b>81.0</b>	13	10	60/ <b>2.36</b>	150/ <b>5.9</b>
2133,6	<b>84.0</b>	14	10	60/ <b>2.36</b>	150/ <b>5.9</b>
2209,8	<b>87.0</b>	14	10	60/ <b>2.36</b>	150/ <b>5.9</b>
2286,0	<b>90.0</b>	15	11	60/ <b>2.36</b>	150/ <b>5.9</b>
2514,6	<b>99.0</b>	15	11	60/ <b>2.36</b>	150/ <b>5.9</b>
2743,2	<b>108.0</b>	16	12	60/ <b>2.36</b>	150/ <b>5.9</b>
2971,8	<b>117.0</b>	17	13	60/ <b>2.36</b>	150/ <b>5.9</b>
3200,4	<b>126.0</b>	18	14	60/ <b>2.36</b>	150/ <b>5.9</b>
3429,0	<b>135.0</b>	19	15	60/ <b>2.36</b>	150/ <b>5.9</b>
3657,6	<b>144.0</b>	20	16	60/ <b>2.36</b>	150/ <b>5.9</b>
3810,0	<b>150.0</b>	21	17	60/ <b>2.36</b>	150/ <b>5.9</b>

Note: Number of sprockets depends on the belt load.