

# Thermoforming Sticker Chains



PERFORMANCE IN MOTION





# Thermoforming sticker chains

STICKER CHAINS ARE USED TO CONVEY PLASTIC FILM IN THERMOFORMING MACHINES

Regina Thermoforming sticker chains are based on ISO 08B-2, 08A-1 and 10A-1 roller chains. Upon customer request, Regina can custom design sticker chains based on the combination of the guide and attachment shape options reported below.

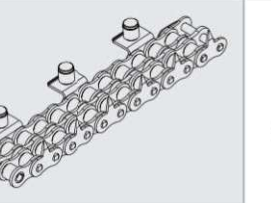
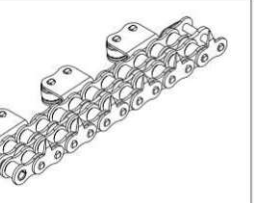
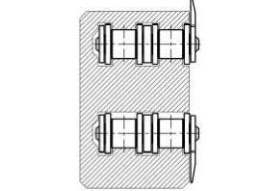
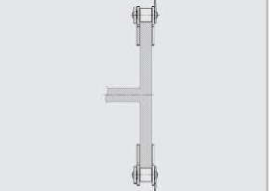
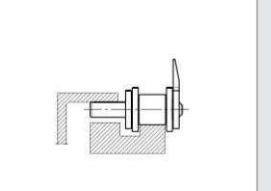
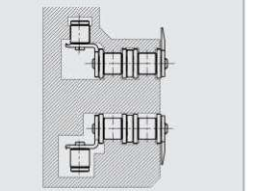
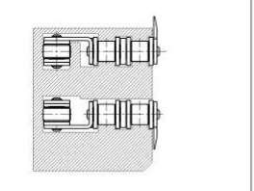

## GUIDE OPTIONS

| GUIDED ON CHAIN ROLLERS                                                           | GUIDED ON SADDLE                                                                   | GUIDED ON EXTENDED PIN                                                             | GUIDED ON SINGLE OUTBOARD ROLLER                                                    | GUIDED ON DOUBLE OUTBOARD ROLLER                                                     |
|-----------------------------------------------------------------------------------|------------------------------------------------------------------------------------|------------------------------------------------------------------------------------|-------------------------------------------------------------------------------------|--------------------------------------------------------------------------------------|
|   |   |   |   |   |
|  |  |  |  |  |

## ATTACHMENT SHAPE OPTIONS

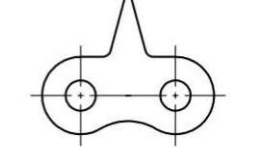
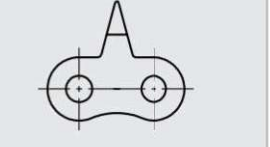
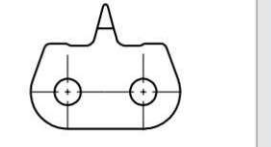
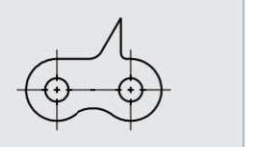
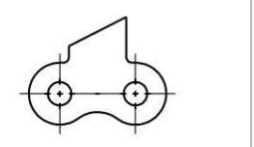
| STANDARD                                                                           | COINED                                                                              | DEEP LINK                                                                           | ASYMMETRIC                                                                           | CHISEL                                                                                |
|------------------------------------------------------------------------------------|-------------------------------------------------------------------------------------|-------------------------------------------------------------------------------------|--------------------------------------------------------------------------------------|---------------------------------------------------------------------------------------|
|  |  |  |  |  |

## PRODUCT FEATURES

- Chains are pre-stretched and matched in pairs.
- Precise length tolerance for exact film positioning.
- High performance lubrication suitable for high temperature. On request with USDA H1 food approved prelubrication.
- Optimized plate hardness for improved wear resistance.



SMOOTH TIP FINISHING FOR CLEANER PIERCING AND REDUCED POWDERING





# 08B-2 BASE CHAIN

## GUIDED ON CHAIN ROLLER - COINED AND DEEP LINK

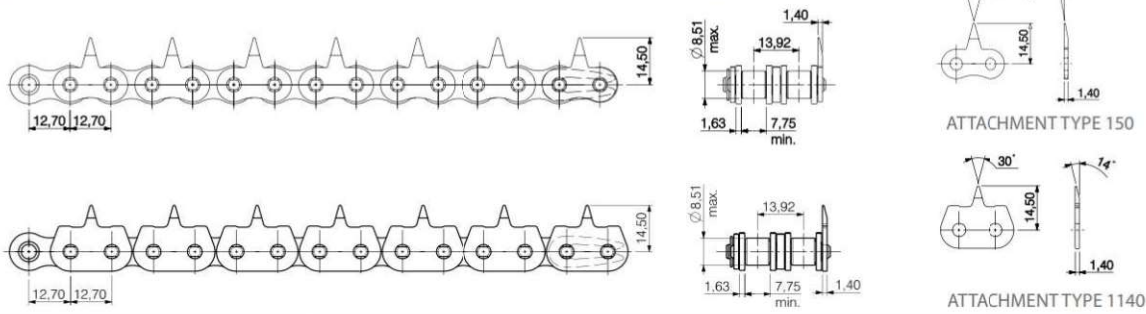

**ILLIG /TFT/WM style**

| REGINA REF. | ISO REF. | CHAIN PITCH P |        | ROLLER DIAMETER DR |        | INSIDE WIDTH W |        | SPIKE ATTACHMENT TYPE | SPIKE ATTACHMENT FREQUENCY |
|-------------|----------|---------------|--------|--------------------|--------|----------------|--------|-----------------------|----------------------------|
|             |          | mm            | inches | mm                 | inches | mm             | inches |                       |                            |
| 226/903     | 08B-2    | 12,70         | 1/2    | 8,51               | 0,335  | 7,75           | 0,305  | 150                   | every 2nd pitch            |
| 226SR/P001  | 08B-2    | 12,70         | 1/2    | 8,51               | 0,335  | 7,75           | 0,305  | 1140                  | every 2nd pitch            |

## GUIDED ON SADDLE - COINED

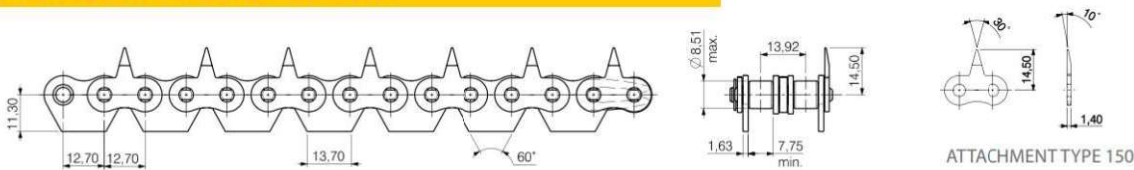

**BELLAPLAST style**

| REGINA REF. | ISO REF. | CHAIN PITCH P |        | ROLLER DIAMETER DR |        | INSIDE WIDTH W |        | SPIKE ATTACHMENT TYPE | SPIKE ATTACHMENT FREQUENCY |
|-------------|----------|---------------|--------|--------------------|--------|----------------|--------|-----------------------|----------------------------|
|             |          | mm            | inches | mm                 | inches | mm             | inches |                       |                            |
| 226/146     | 08B-2    | 12,70         | 1/2    | 8,51               | 0,335  | 7,75           | 0,305  | 150                   | every 2nd pitch            |

## GUIDED ON CHAIN ROLLER - COINED

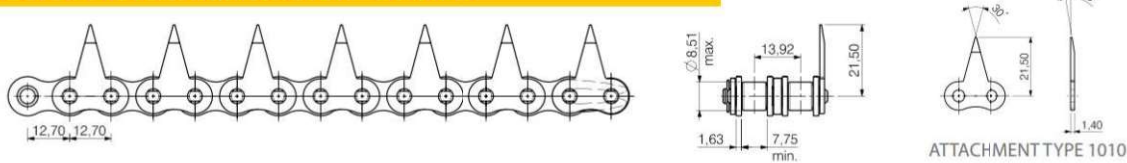

**OMV style**

| REGINA REF. | ISO REF. | CHAIN PITCH P |        | ROLLER DIAMETER DR |        | INSIDE WIDTH W |        | SPIKE ATTACHMENT TYPE | SPIKE ATTACHMENT FREQUENCY |
|-------------|----------|---------------|--------|--------------------|--------|----------------|--------|-----------------------|----------------------------|
|             |          | mm            | inches | mm                 | inches | mm             | inches |                       |                            |
| 226/090     | 08B-2    | 12,70         | 1/2    | 8,51               | 0,335  | 7,75           | 0,305  | 1010                  | every 2nd pitch            |

## GUIDED ON SINGLE OUTBOARD ROLLER - COINED

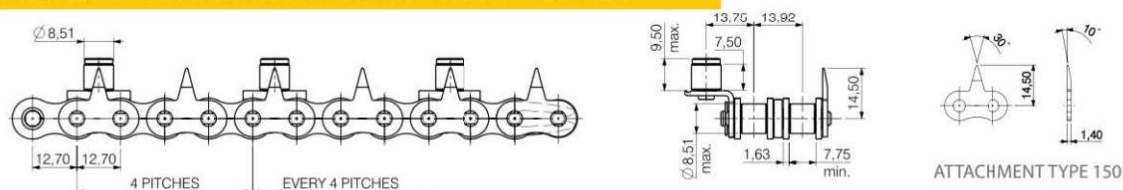

**KIEFEL/ GABLER style**

| REGINA REF. | ISO REF. | CHAIN PITCH P |        | ROLLER DIAMETER DR |        | INSIDE WIDTH W |        | SPIKE ATTACHMENT TYPE | SPIKE ATTACHMENT FREQUENCY |
|-------------|----------|---------------|--------|--------------------|--------|----------------|--------|-----------------------|----------------------------|
|             |          | mm            | inches | mm                 | inches | mm             | inches |                       |                            |
| 226/09F     | 08B-2    | 12,70         | 1/2    | 8,51               | 0,335  | 7,75           | 0,305  | 150                   | every 2nd pitch            |

## GUIDED ON DOUBLE OUTBOARD ROLLER - COINED

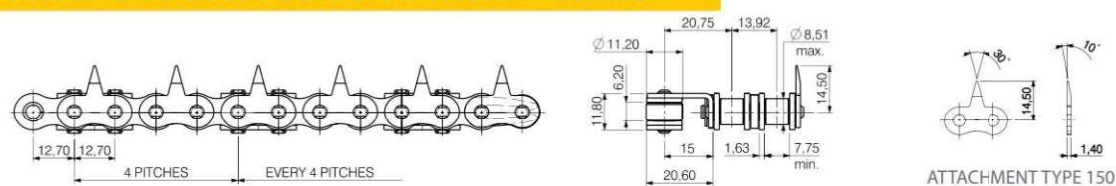

| REGINA REF. | ISO REF. | CHAIN PITCH P |        | ROLLER DIAMETER DR |        | INSIDE WIDTH W |        | SPIKE ATTACHMENT TYPE | SPIKE ATTACHMENT FREQUENCY |
|-------------|----------|---------------|--------|--------------------|--------|----------------|--------|-----------------------|----------------------------|
|             |          | mm            | inches | mm                 | inches | mm             | inches |                       |                            |
| 226SR/009   | 08B-2    | 12,70         | 1/2    | 8,51               | 0,335  | 7,75           | 0,305  | 150                   | every 2nd pitch            |

# 08A-1 / A40 BASE CHAIN

## GUIDED ON EXTENDED PIN - ASYMMETRIC

STICKER ATTACHMENT EVERY 2ND PITCH

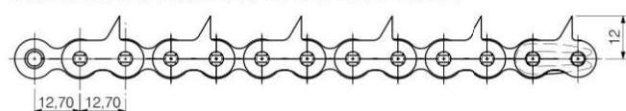

STICKER ATTACHMENT EVERY 4TH PITCH

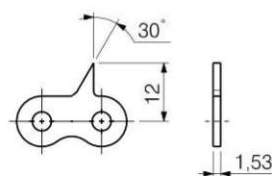
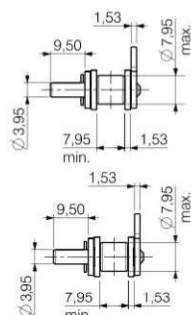
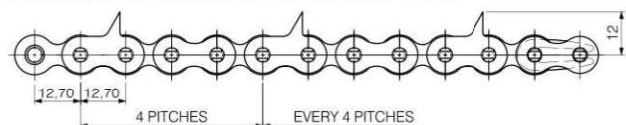

ATTACHMENT TYPE 167

IRWIN  
style

| REGINA REF. | ISO REF. | CHAIN PITCH P |        | ROLLER DIAMETER DR |        | INSIDE WIDTH W |        | SPIKE ATTACHMENT TYPE | SPIKE ATTACHMENT FREQUENCY | ASSEMBLY SIDE |
|-------------|----------|---------------|--------|--------------------|--------|----------------|--------|-----------------------|----------------------------|---------------|
|             |          | mm            | inches | mm                 | inches | mm             | inches |                       |                            |               |
| A40/0BB     | 08A      | 12,70         | 1/2    | 7,92               | 0,312  | 7,85           | 0,309  | 167                   | every 2nd pitch            | right         |
| A40/0BD     | 08A      | 12,70         | 1/2    | 7,92               | 0,312  | 7,85           | 0,309  | 167                   | every 2nd pitch            | left          |
| A40/11C     | 08A      | 12,70         | 1/2    | 7,92               | 0,312  | 7,85           | 0,309  | 167                   | every 4th pitch            | right         |
| A40/11D     | 08A      | 12,70         | 1/2    | 7,92               | 0,312  | 7,85           | 0,309  | 167                   | every 4th pitch            | left          |

## GUIDED ON EXTENDED PIN - ASYMMETRIC

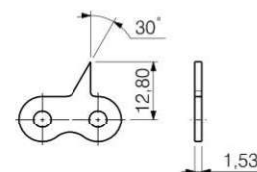
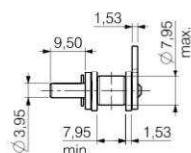
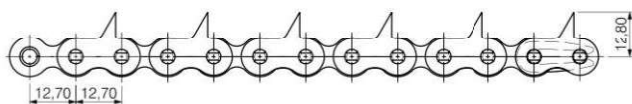

ATTACHMENT TYPE 177

IRWIN  
style

| REGINA REF. | ISO REF. | CHAIN PITCH P |        | ROLLER DIAMETER DR |        | INSIDE WIDTH W |        | SPIKE ATTACHMENT TYPE | SPIKE ATTACHMENT FREQUENCY | ASSEMBLY SIDE |
|-------------|----------|---------------|--------|--------------------|--------|----------------|--------|-----------------------|----------------------------|---------------|
|             |          | mm            | inches | mm                 | inches | mm             | inches |                       |                            |               |
| A40/P004    | 08A      | 12,70         | 1/2    | 7,92               | 0,312  | 7,85           | 0,309  | 177                   | every 2nd pitch            | left          |
| A40/P003    | 08A      | 12,70         | 1/2    | 7,92               | 0,312  | 7,85           | 0,309  | 177                   | every 2nd pitch            | right         |

## GUIDED ON EXTENDED PIN - CHISEL

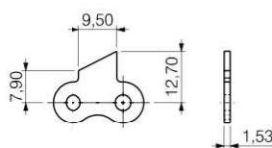
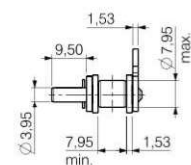
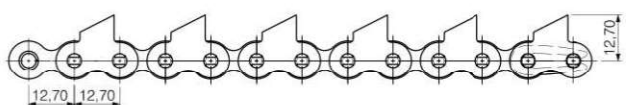

ATTACHMENT TYPE 163

IRWIN  
style

| REGINA REF. | ISO REF. | CHAIN PITCH P |        | ROLLER DIAMETER DR |        | INSIDE WIDTH W |        | SPIKE ATTACHMENT TYPE | SPIKE ATTACHMENT FREQUENCY | ASSEMBLY SIDE |
|-------------|----------|---------------|--------|--------------------|--------|----------------|--------|-----------------------|----------------------------|---------------|
|             |          | mm            | inches | mm                 | inches | mm             | inches |                       |                            |               |
| A40/0B5     | 08A      | 12,70         | 1/2    | 7,92               | 0,312  | 7,85           | 0,309  | 163                   | every 2nd pitch            | left          |
| A40/0B7     | 08A      | 12,70         | 1/2    | 7,92               | 0,312  | 7,85           | 0,309  | 163                   | every 2nd pitch            | right         |

## GUIDED ON CHAIN ROLLER - COINED

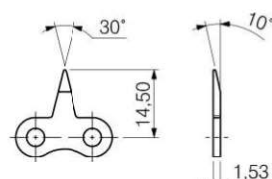
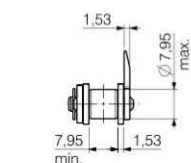
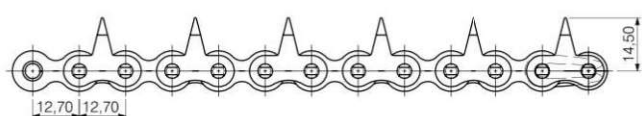

ATTACHMENT TYPE 141

DINIEPER  
style

| REGINA REF. | ISO REF. | CHAIN PITCH P |        | ROLLER DIAMETER DR |        | INSIDE WIDTH W |        | SPIKE ATTACHMENT TYPE | SPIKE ATTACHMENT FREQUENCY |
|-------------|----------|---------------|--------|--------------------|--------|----------------|--------|-----------------------|----------------------------|
|             |          | mm            | inches | mm                 | inches | mm             | inches |                       |                            |
| A40/0B9     | 08A      | 12,70         | 1/2    | 7,92               | 0,312  | 7,85           | 0,309  | 141                   | every 2nd pitch            |



# 10A-1 / A50 BASE CHAIN

## GUIDED ON SADDLE - STANDARD

### STICKER ATTACHMENT EVERY 2ND PITCH

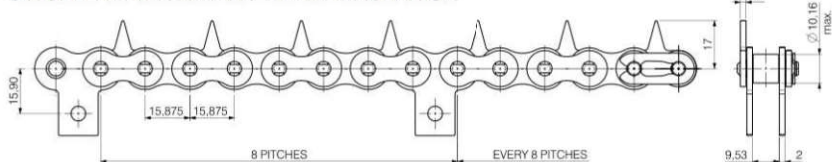

### STICKER ATTACHMENT EVERY 4TH PITCH

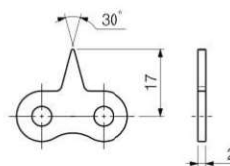
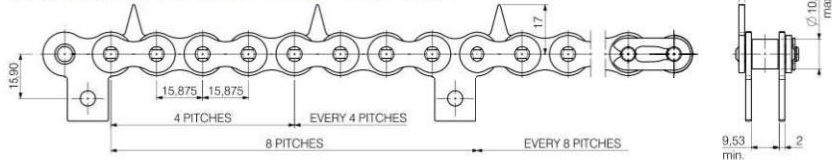

ATTACHMENT TYPE 177

**BROWN**  
style

| REGINA REF. | ISO REF. | CHAIN PITCH P |        | ROLLER DIAMETER DR |        | INSIDE WIDTH W |        | SPIKE ATTACHMENT TYPE | SPIKE ATTACHMENT FREQUENCY | ASSEMBLY SIDE |
|-------------|----------|---------------|--------|--------------------|--------|----------------|--------|-----------------------|----------------------------|---------------|
|             |          | mm            | inches | mm                 | inches | mm             | inches |                       |                            |               |
| A50SR/P001  | 10A-1    | 15,875        | 5/8    | 10,16              | 0,400  | 9,65           | 0,380  | 177                   | every 2nd pitch            | right         |
| A50SR/P002  | 10A-1    | 15,875        | 5/8    | 10,16              | 0,400  | 9,65           | 0,380  | 177                   | every 2nd pitch            | left          |
| A50/P008    | 10A-1    | 15,875        | 5/8    | 10,16              | 0,400  | 9,65           | 0,380  | 177                   | every 4th pitch            | right         |
| A50/P009    | 10A-1    | 15,875        | 5/8    | 10,16              | 0,400  | 9,65           | 0,380  | 177                   | every 4th pitch            | left          |

## GUIDED ON SADDLE - COINED

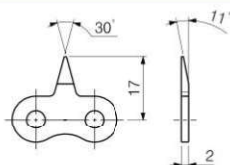
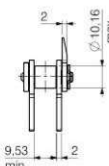
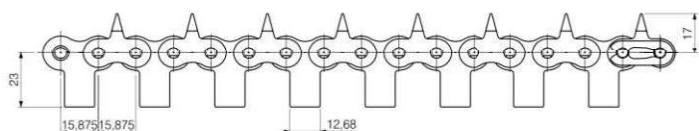

ATTACHMENT TYPE 190

| REGINA REF. | ISO REF. | CHAIN PITCH P |        | ROLLER DIAMETER DR |        | INSIDE WIDTH W |        | SPIKE ATTACHMENT TYPE | SPIKE ATTACHMENT FREQUENCY |
|-------------|----------|---------------|--------|--------------------|--------|----------------|--------|-----------------------|----------------------------|
|             |          | mm            | inches | mm                 | inches | mm             | inches |                       |                            |
| A50/1FF     | 10A-1    | 15,875        | 5/8    | 10,16              | 0,400  | 9,65           | 0,380  | 190                   | every 2nd link             |

## GUIDED ON EXTENDED PIN - COINED

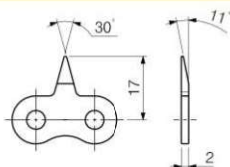
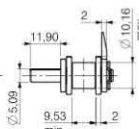
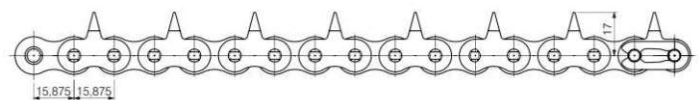

ATTACHMENT TYPE 190

| REGINA REF. | ISO REF. | CHAIN PITCH P |        | ROLLER DIAMETER DR |        | INSIDE WIDTH W |        | SPIKE ATTACHMENT TYPE | SPIKE ATTACHMENT FREQUENCY |
|-------------|----------|---------------|--------|--------------------|--------|----------------|--------|-----------------------|----------------------------|
|             |          | mm            | inches | mm                 | inches | mm             | inches |                       |                            |
| A50/P005    | 10A-1    | 15,875        | 5/8    | 10,16              | 0,400  | 9,65           | 0,380  | 190                   | every 2nd link             |



- ILLIG® is a registered trademark of ILLIG Maschinenbaum GmbH
- TFT® is a registered trademark of WM Wrapping Machinery SA
- OMV® is a registered trademark of OMV Machinery Srl
- Kiefel® is a registered trademark of Kiefel GmbH

- Gabler® is a registered trademark of Gabler Thermoform GmbH
- Irwin® is a registered trademark of Irwin Research and Development Inc
- Dinieper® is a registered trademark of Dinieper Ind. Metalurgica
- Brown® is a registered trademark of Brown Machine LLC



## PERFORMANCE IN MOTION

### ITALY

REGINA CATENE CALIBRATE S.p.A.  
HEAD OFFICE:  
Via Monza, 90  
23870 Cernusco Lombardone (LC) - Italy  
Tel. +39 039 99801  
Fax +39 039 9905229  
sales@reginachain.net

### USA

REGINA USA, INC.  
305 E. Mahn Court  
Oak Creek, WI 53154 - USA  
Tel. 001 414 5710032  
Fax 001 414 5710225  
sales.us@reginachain.net

### FRANCE

REGINA INDUSTRIE s.a.r.l.  
Z.A.C. des Chatelliers  
34 Rue des Frères Lumière  
45800 Saint Jean De Braye - France  
Tel. +33 238 836363  
Fax +33 238 836413  
sales.fr@reginachain.net

### MEXICO

REGINA de MEXICO S.A. de C.V.  
Av. Aviación 5051-28  
Col. San Juan de Ocotan  
45019 Zapopan, Jalisco - Mexico  
Tel. +52 33 3627 4043  
Fax +52 33 3627 3930  
sales.mx@reginachain.net

### CHINA

REGINA TIANJIN CHAIN & BELT CO., LTD.  
Xi Qing Economic Development Area,  
Xiang Rui Road n. 17  
Tian Xiang Industrial Zone  
300385 Tian Jin - China  
Tel. +86 22 83961223  
Fax +86 22 83961202  
sales.cn@reginachain.net

### UNITED KINGDOM

REGINA INTERNATIONAL LIMITED  
Unit 1, Dyneley Road,  
Greenbank Business Park  
Whitebirk, Blackburn,  
Lancs BB1 3AB - United Kingdom  
Tel. +44 1254 661116  
Fax +44 1254 59456  
sales.uk@reginachain.net

### ARGENTINA

REGINA INTERNATIONAL S.A.  
Diagonal 190,  
1788-1655 José Leon Suarez  
Prov. Buenos Aires - Argentina  
Tel. +54 11 47296667  
Fax +54 11 47203210  
sales.ar@reginachain.net

### GERMANY

SALES OFFICE  
Tel. +49 1705251348  
Fax +49 7181489535  
sales.de@reginachain.net

### THE NETHERLANDS

SALES OFFICE  
Tel. +31 610681114  
sales.nl@reginachain.net

### SPAIN

CADENAS REGINA ESPAÑA, S.L.  
Calle Industria, 37  
08120 La Llagosta - Barcelona - España  
Tel. +34 93 5742838  
Fax +34 93 5740735  
sales.es@reginachain.net

### INDIA

SALES OFFICE  
Tel. +91 9881399026  
sales.in@reginachain.net

