

TO-05 - TO - TA-05 - TA - NT - NTA - ET - ET - ETR ETH - ETHG - ETHR - +PU

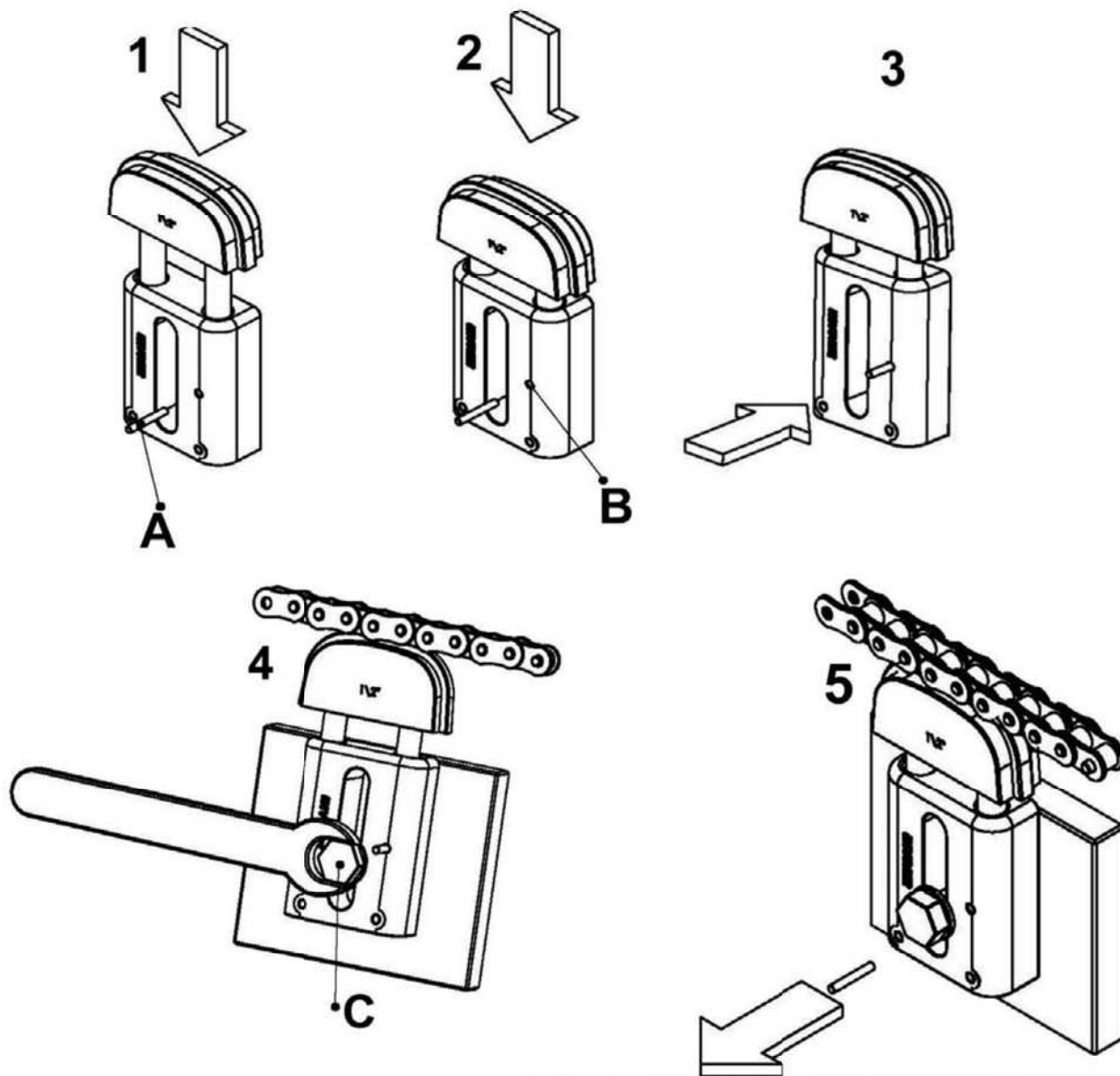

Para todos los tensores TO-ET-NT tambien aquellos con poleas o piñones.

(Figura 1) Prepara el perno A (Ø 3m/m) y el tensor.

(Figura 2) Impulsa la cabeza del tensor hasta la fin de carrera con una prensa o de manera manual.

(Figura 3) Introducir el perno A (Ø3m/m) en el agujero B., sin desembragar la cabeza del tensor, después puede desembragar la cabeza.

(Figura 4) Pone el tensor contra la cadena o la correa y fija el perno C.

(Figura 5) Extrae el perno A (Ø 3m/m) del agujero B.



TO 1 INOX

CABEZA OVAL

NEWTON 110-240

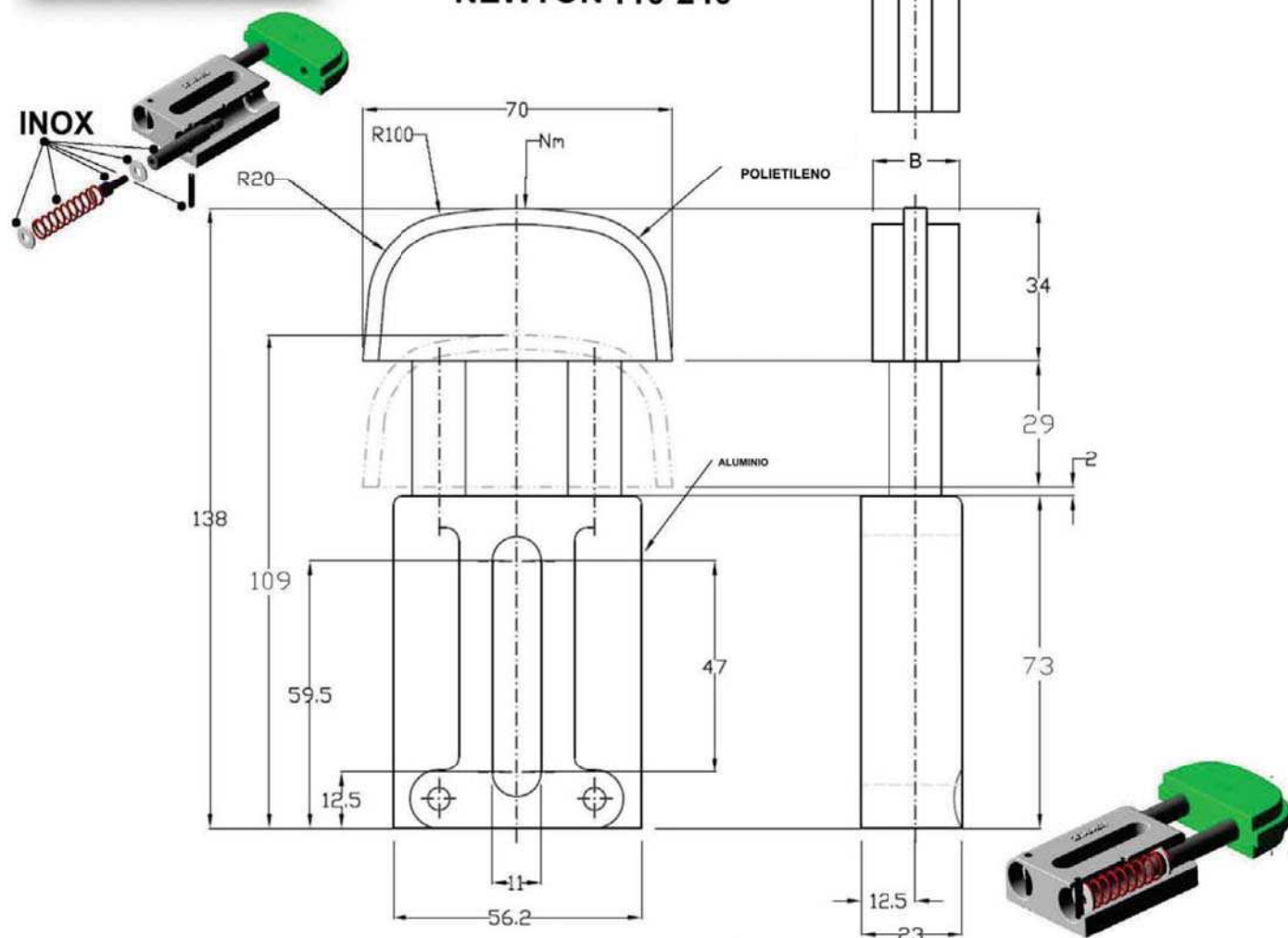

COD	B	NEWTON		PASO CATENA		KG
		MIN	MAX	CHAIN PITCH		
				PASO DE LA CADENA		
				PAS DE LA CHAÎNE		
TO1O38SINOX	20	110	240	3/8" x 7/32"	06B1	0,349
TO1O38DINOX	20	110	240	3/8" x 7/32"	06B2	0,349
TO1O12SINOX	20	110	240	1/2" x 5/16"	08B1	0,349
TO1O12DINOX	20	110	240	1/2" x 5/16"	08B2	0,349
TO1O58SINOX	20	110	240	5/8" x 3/8"	10B1	0,349
TO1O58DINOX	25	110	240	5/8" x 3/8"	10B2	0,358
TO1OASA35SINOX	20	110	240	ASA35	06C.1	0,349
TO1OASA35DINOX	20	110	240	ASA35.2	06C.2	0,349
TO1OASA40SINOX	20	110	240	ASA40	08A.1	0,349
TO1OASA40DINOX	25	110	240	ASA40.2	08A.2	0,358

CABEZA OVAL

NEWTON 210-350

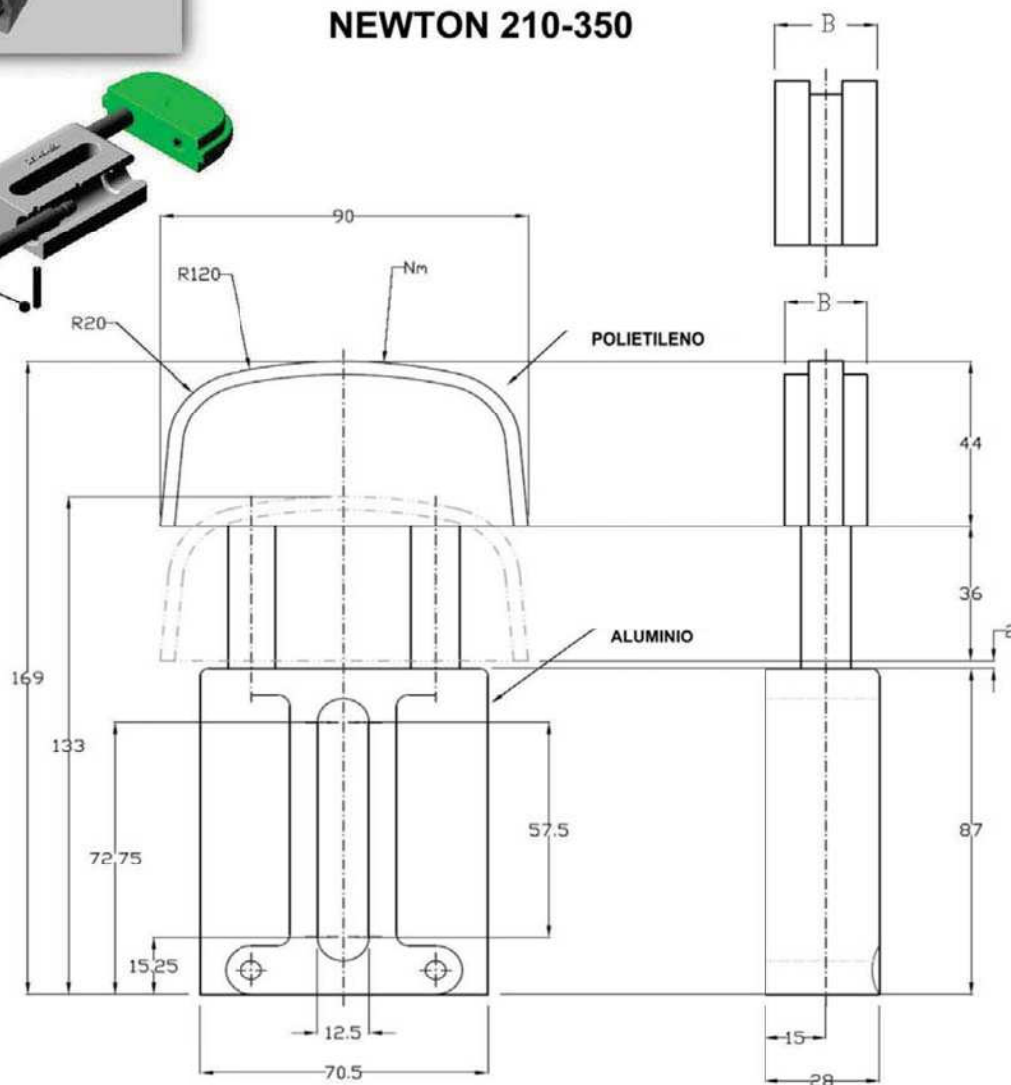
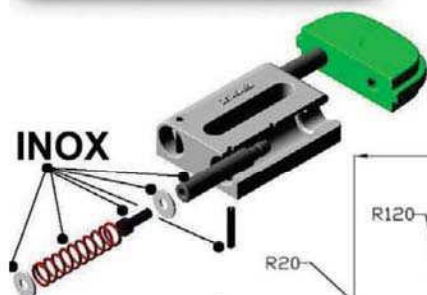

COD	B	NEWTON		PASO CATENA		KG
		MIN	MAX	CHAIN PITCH		
				PASO DE LA CADENA		
				PAS DE LA CHAÎNE		
TO2O58SINOX	22	210	350	5/8" x 3/8"	10B1	0,647
TO2O58DINOX	25	210	350	5/8" x 3/8"	10B2	0,657
TO2O34SINOX	22	210	350	3/4" x 7/16"	12B1	0,647
TO2O34DINOX	30	210	350	3/4" x 7/16"	12B2	0,672
TO2O1SINOX	25	210	350	1" x 17 m\m	16B1	0,656
TO2OASA50SINOX	22	210	350	ASA50	10A.1	0,647
TO2OASA50DINOX	30	210	350	ASA50.2	10A.2	0,652
TO2OASA60SINOX	22	210	350	ASA60	12A.1	0,657

TO 3 INOX

CABEZA OVAL

NEWTON 250-450

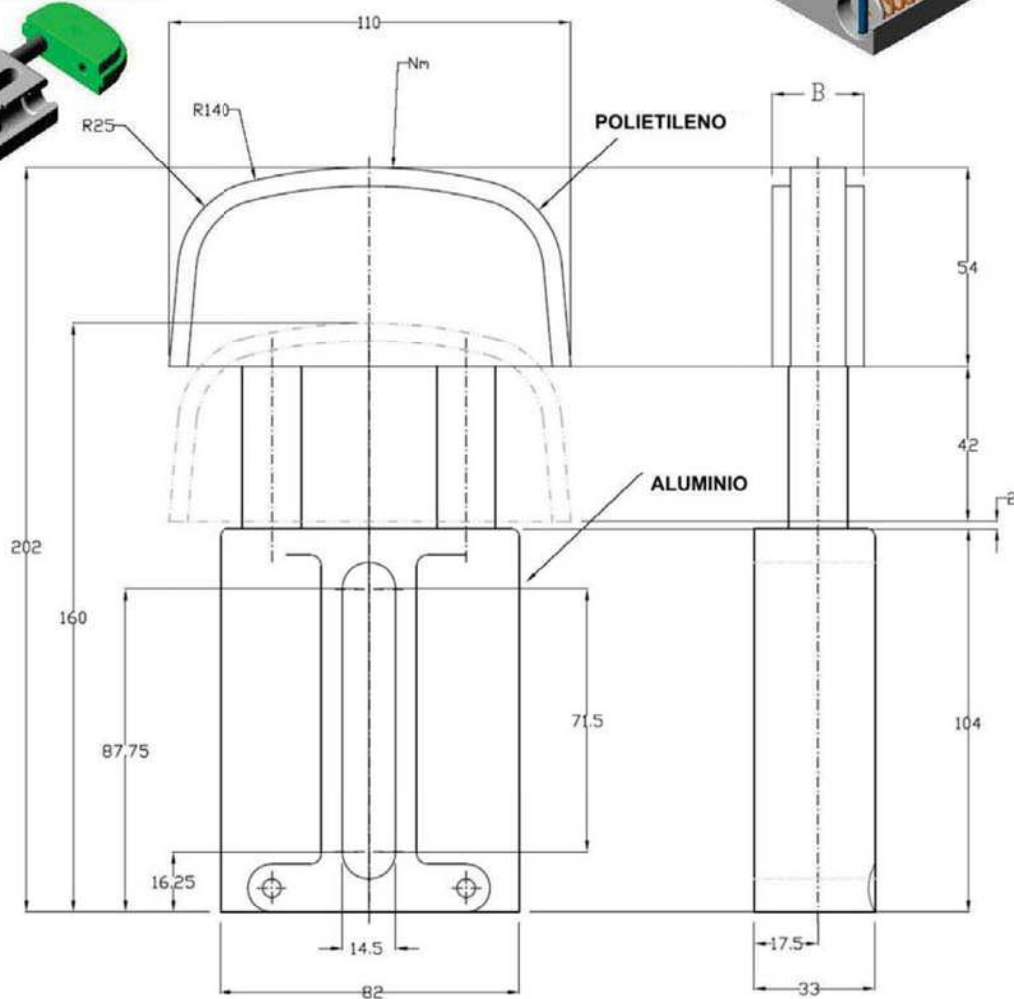
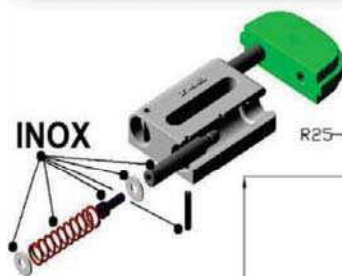
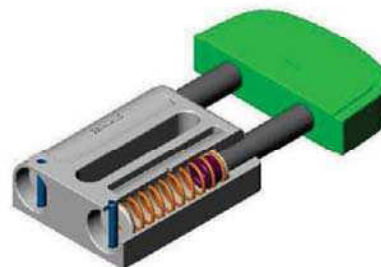

COD	B	NEWTON		PASO CATENA		KG
		MIN	MAX	CHAIN PITCH		
				PASO DE LA CADENA		
				PAS DE LA CHAÎNE		
TO3O1SINOX	25	250	450	1" x 17 m\m	16B1	1,005
TO3O114SINOX	25	250	450	1"1/4 x 3/4"	20B1	1,005
TO3O112SINOX	25	250	450	1"1/2 x 1"	24B1	1,005
TO3OASA80SINOX	25	250	450	ASA80	16A.1	1,005
TO3OASA100SINOX	25	250	450	ASA100	20A.1	1,005
TO3OASA120SINOX	25	250	450	ASAS120	24A.1	1,005



TA-05

TA-05 INOX

CABEZA REDONDA

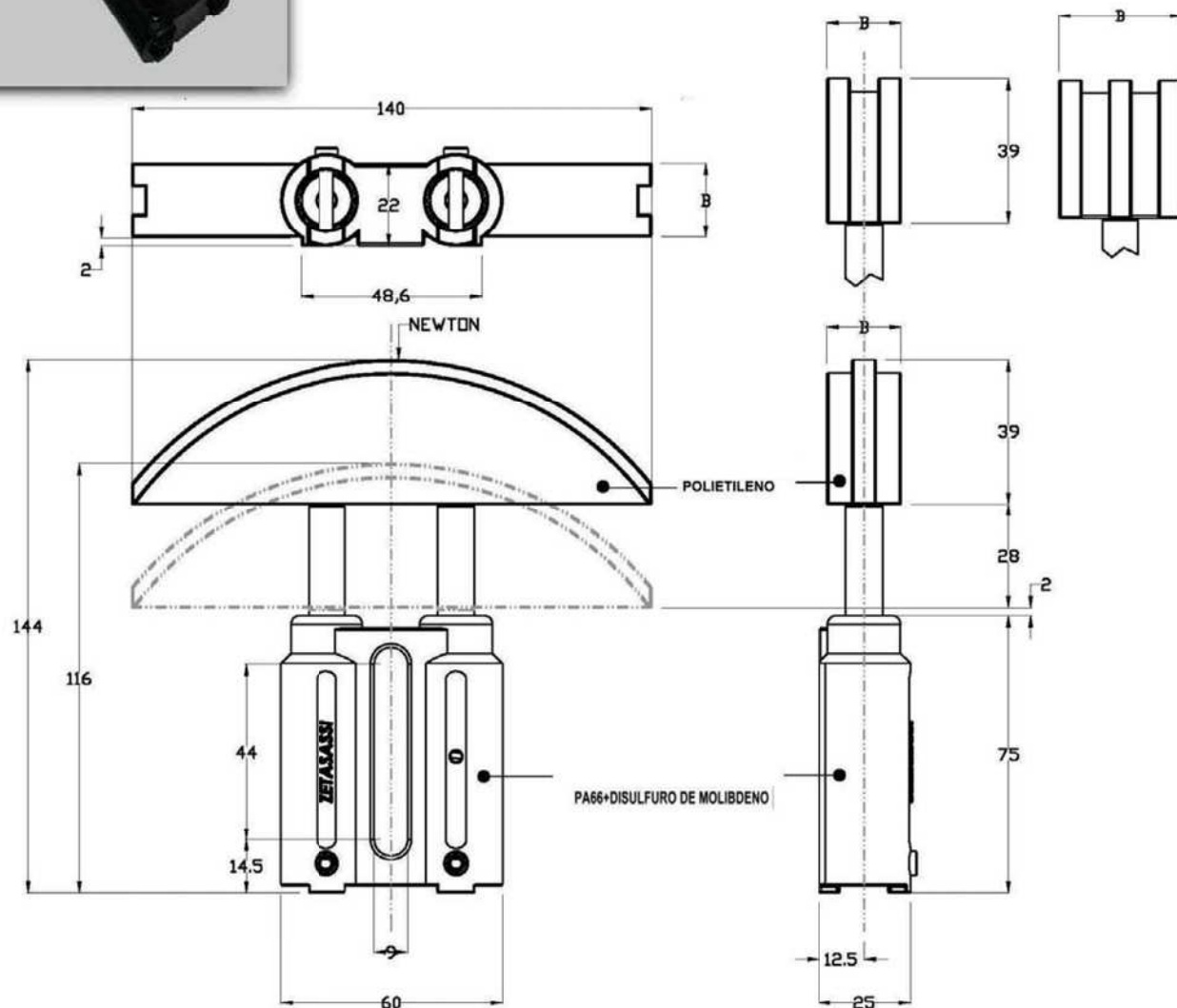

COD	PASO CATENA		NEWTON		COD	PASO CATENA		NEWTON		B	KG
	CHAIN PITCH		MIN	MAX		CHAIN PITCH		MIN	MAX		
	PASO DE LA CADENA					PASO DE LA CADENA					
	PAS DE LA CHAÎNE					PAS DE LA CHAÎNE					
TA05T38S	3/8" x 7/32"	06B1	130	250	TA05T38SINOX	3/8" x 7/32"	06B1	110	240	20	0,22
TA05T38D	3/8" x 7/32"	06B2	130	250	TA05T38DINOX	3/8" x 7/32"	06B2	110	240	20	0,22
TA05T38T	3/8" x 7/32"	06B3	130	250	TA05T38TINOX	3/8" x 7/32"	06B3	110	240	26	0,245
TA05T12S	1/2" x 5/16"	08B1	130	250	TA05T12SINOX	1/2" x 5/16"	08B1	110	240	20	0,22
TA05T12D	1/2" x 5/16"	08B2	130	250	TA05T12DINOX	1/2" x 5/16"	08B2	110	240	20	0,22
TA05T12T	1/2" x 5/16"	08B3	130	250	TA05T12TINOX	1/2" x 5/16"	08B3	110	240	34,5	0,281
TA05TASA35S	ASA35	06C.1	130	250	TA05TASA35SINOX	ASA35	06C.1	110	240	20	0,22
TA05TASA35D	ASA35.2	06C.2	130	250	TA05TASA35DINOX	ASA35.2	06C.2	110	240	20	0,22
TA05TASA35T	ASA35.3	06C.3	130	250	TA05TASA35TINOX	ASA35.3	06C.3	110	240	24,4	0,237
TA05TASA40S	ASA40	08A.1	130	250	TA05TASA40SINOX	ASA40	08A.1	110	240	20	0,22
TA05TASA40D	ASA40.2	08A.2	130	250	TA05TASA40DINOX	ASA40.2	08A.2	110	240	25	0,239
TA05TASA40T	ASA40.3	08A.3	130	250	TA05TASA40TINOX	ASA40.3	08A.3	110	240	36	0,286



TA 1 - 2 - 3 INOX

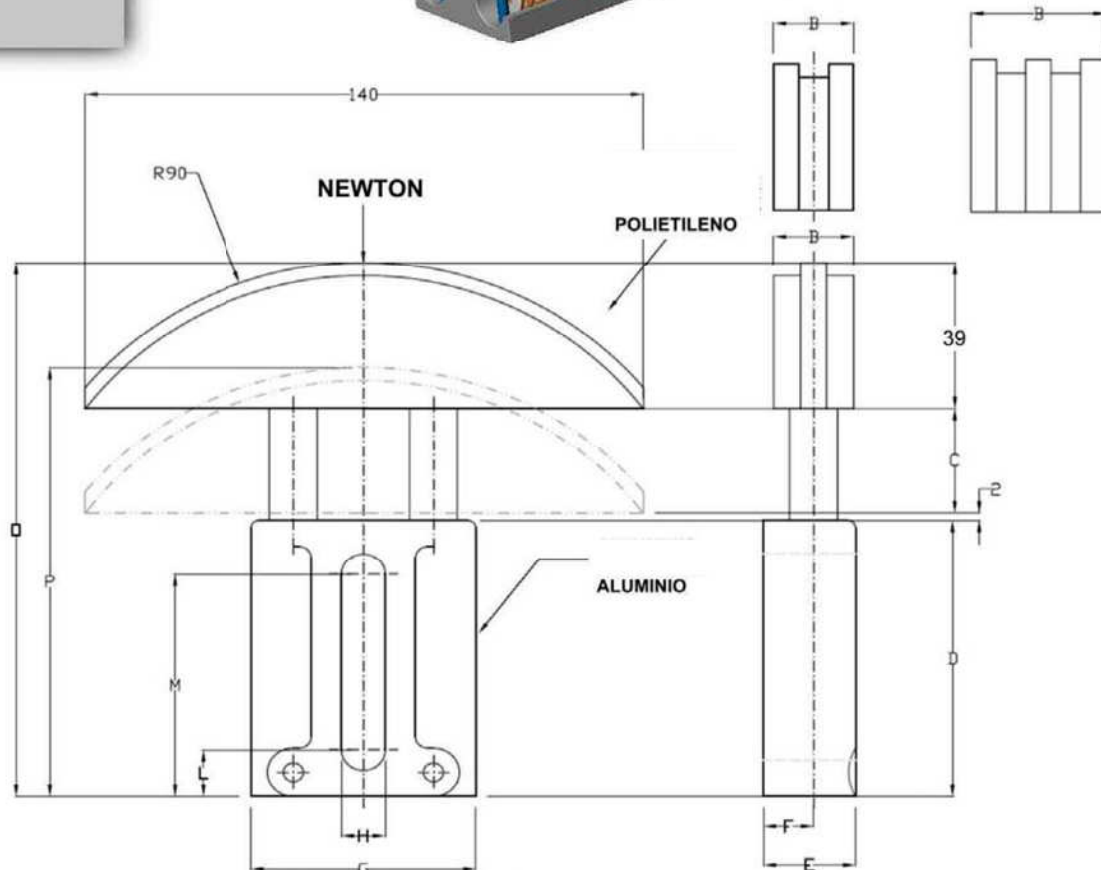
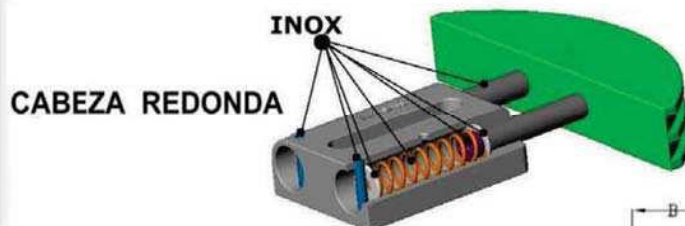

COD	PASO CATENA		B	KG	COD	PASO CATENA		B	KG	NEWTON		C	D	E	F	G	H	L	M	O	P
	CHAIN PITCH					MIN	MAX														
	PASO DE LA CADENA																				
	PAS DE LA CHAÎNE																				
TA1T38SINOX	3/8" x 7/32"	06B1	20	0,399	TA1TASA35SINOX	ASA35	06C.1	20	0,397	110	240	29	73	23	12,5	56,2	11	12,5	59,5	143	114
TA1T38DINOX	3/8" x 7/32"	06B2	20	0,399	TA1TASA35DINOX	ASA35.2	06C.2	20	0,397	110	240	29	73	23	12,5	56,2	11	12,5	59,5	143	114
TA1T38TINOX	3/8" x 7/32"	06B3	26	0,424	TA1TASA35TINOX	ASA35.3	06C.3	24,4	0,416	110	240	29	73	23	12,5	56,2	11	12,5	59,5	143	114
TA1T12SINOX	1/2" x 5/16"	08B1	20	0,399	TA1TASA40SINOX	ASA40	08A.1	20	0,397	110	240	29	73	23	12,5	56,2	11	12,5	59,5	143	114
TA1T12DINOX	1/2" x 5/16"	08B2	20	0,399	TA1TASA40DINOX	ASA40.2	08A.2	25	0,418	110	240	29	73	23	12,5	56,2	11	12,5	59,5	143	114
TA1T12TINOX	1/2" x 5/16"	08B3	34,5	0,46	TA1TASA40TINOX	ASA40.3	08A.3	36	0,465	110	240	29	73	23	12,5	56,2	11	12,5	59,5	143	114
TA2T58SINOX	5/8" x 3/8"	10B1	22	0,673	TA2TASA50SINOX	ASA50	10A.1	22	0,673	210	350	36	87	28	15	70,5	12,5	15,25	72,75	164	128
TA2T58DINOX	5/8" x 3/8"	10B2	25	0,686	TA2TASA50DINOX	ASA50.2	10A.2	30	0,707	210	350	36	87	28	15	70,5	12,5	15,25	72,75	164	128
TA2T58TINOX	5/8" x 3/8"	10B3	41,5	0,756	TA2TASA50TINOX	ASA50.3	10A.3	44,8	0,77	210	350	36	87	28	15	70,5	12,5	15,25	72,75	164	128
TA2T34SINOX	3/4" x 7/16"	12B1	22	0,673	TA2TASA60SINOX	ASA60	12A.1	22	0,673	210	350	36	87	28	15	70,5	12,5	15,25	72,75	164	128
TA2T34DINOX	3/4" x 7/16"	12B2	30	0,707	TA2TASA60DINOX	ASA60.2	12A.2	34,8	0,728	210	350	36	87	28	15	70,5	12,5	15,25	72,75	164	128
TA2T34TINOX	3/4" x 7/16"	12B3	49	0,788	TA2TASA60TINOX	ASA60.3	12A.3	57,6	0,825	210	350	36	87	28	15	70,5	12,5	15,25	72,75	164	128
TA3T1SINOX	1" x 17mm	16B1	25	0,996	TA3TASA80SINOX	ASA80	16A.1	25	0,996	250	450	42	104	33	17,5	82	14,5	16,25	87,75	187	145
TA3T1DINOX	1" x 17mm	16B2	46	1,081	TA3TASA80DINOX	ASA80.2	16A.2	44,3	1,078	250	450	42	104	33	17,5	82	14,5	16,25	87,75	187	145
TA3T1TINOX	1" x 17mm	16B3	78	1,221	TA3TASA80TINOX	ASA80.3	16A.3	73,6	1,202	250	450	42	104	33	17,5	82	14,5	16,25	87,75	187	145
TA3T114SINOX	1"1/4 x 3/4"	20B1	25	0,996	TA3TASA100SINOX	ASA100	20A.1	25	0,996	250	450	42	104	33	17,5	82	14,5	16,25	87,75	187	145
TA3T114DINOX	1"1/4 x 3/4"	20B2	54	1,119	TA3TASA100DINOX	ASA100.2	20A.2	54	1,119	250	450	42	104	33	17,5	82	14,5	16,25	87,75	187	145
TA3T114TINOX	1"1/4 x 3/4"	20B3	90	1,272	TA3TASA100TINOX	ASA100.3	20A.3	90	1,272	250	450	42	104	33	17,5	82	14,5	16,25	87,75	187	145
TA3T112SINOX	1"1/2 x 1"	24B1	25	0,996	TA3TASA120SINOX	ASA120	24A.1	25	0,996	250	450	42	104	33	17,5	82	14,5	16,25	87,75	187	145
TA3T112DINOX	1"1/2 x 1"	24B2	71	1,191	TA3TASA120DINOX	ASA120.2	24A.2	70	1,187	250	450	42	104	33	17,5	82	14,5	16,25	87,75	187	145
TA3T112TINOX	1"1/2 x 1"	24B3	119	1,395						250	450	42	104	33	17,5	82	14,5	16,25	87,75	187	145
TA3T134SINOX	1"3/4 x 1"1/4	28B1	29,5	1,015						250	450	42	104	33	17,5	82	14,5	16,25	87,75	187	145
TA3T2SINOX	2" x 1"1/4	32B1	29,5	1,015						250	450	42	104	33	17,5	82	14,5	16,25	87,75	187	145

NT 1 - 2 INOX

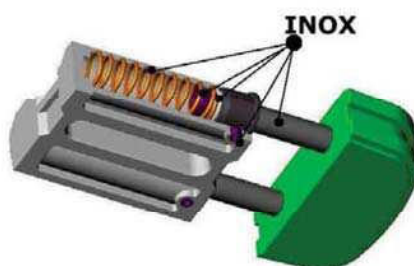

CABEZA OVAL

BOCCOLE DI SCORRIMENTO
SLIDING BUSH
BAGUES DE GLISSEMENT
CASQUILLOS DE DESLIZAMIENTO
NYLON

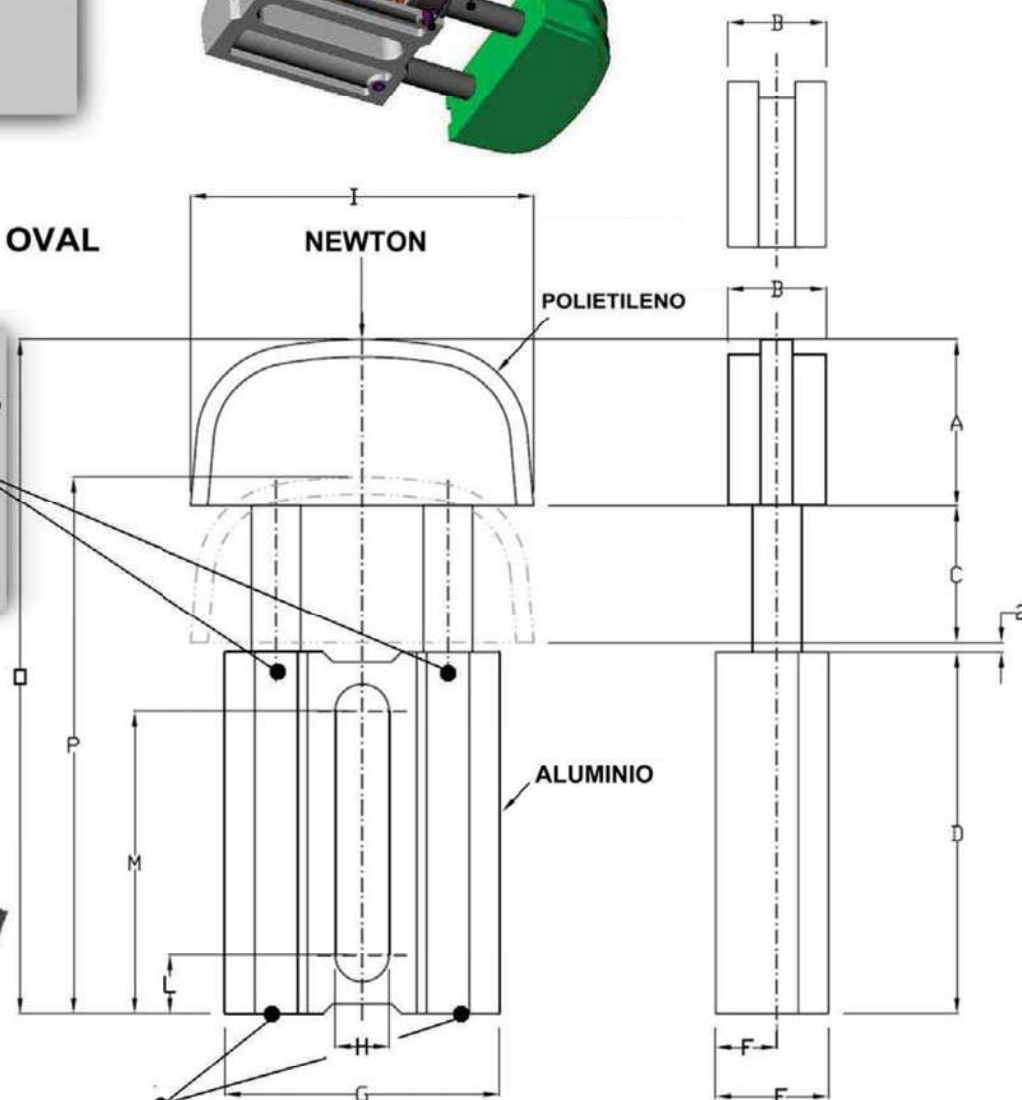

BASE CERRADA CONTRA INFILTRACIONES

COD	PASO CATENA		B	KG	COD	PASO CATENA		B	KG	NEWTON		A	C	D	E	F	G	H	I	L	M	O	P
	CHAIN PITCH					CHAIN PITCH				MIN	MAX												
	PASO DE LA CADENA					PASO DE LA CADENA																	
	PAS DE LA CHAÎNE					PAS DE LA CHAÎNE																	
NT1038SINOX	3/8" x 7/32"	06B1	20	0,244	NT10ASA35SINOX	ASA35	06C.1	20	0,244	110	240	34	28	74	23	12,5	56	11	70	12	62	138	110
NT1038DINOX	3/8" x 7/32"	06B2	20	0,244	NT10ASA35DINOX	ASA35.2	06C.2	20	0,244	110	240	34	28	74	23	12,5	56	11	70	12	62	138	110
NT1012SINOX	1/2" x 5/16"	08B1	20	0,244	NT10ASA40SINOX	ASA40	08A.1	20	0,244	110	240	34	28	74	23	12,5	56	11	70	12	62	138	110
NT1012DINOX	1/2" x 5/16"	08B2	20	0,244	NT10ASA40DINOX	ASA40.2	08A.2	25	0,253	110	240	34	28	74	23	12,5	56	11	70	12	62	138	110
NT1058SINOX	5/8" x 3/8"	10B1	20	0,244						110	240	34	28	74	23	12,5	56	11	70	12	62	138	110
NT1058DINOX	5/8" x 3/8"	10B2	25	0,253						110	240	34	28	74	23	12,5	56	11	70	12	62	138	110
NT2058SINOX	5/8" x 3/8"	10B1	22	0,431	NT20ASA50SINOX	ASA50	10A.1	22	0,431	210	350	44	36	87	28	15	72	12,5	90	15	72	169	133
NT2058DINOX	5/8" x 3/8"	10B2	25	0,441	NT20ASA50DINOX	ASA50.2	10A.2	30	0,436	210	350	44	36	87	28	15	72	12,5	90	15	72	169	133
NT2034SINOX	3/4" x 7/16"	12B1	22	0,431	NT20ASA60SINOX	ASA60	12A.1	22	0,441	210	350	44	36	87	28	15	72	12,5	90	15	72	169	133
NT2034DINOX	3/4" x 7/16"	12B2	30	0,456						210	350	44	36	87	28	15	72	12,5	90	15	72	169	133
NT201SINOX	1" x 17mm	16B1	25	0,44						210	350	44	36	87	28	15	72	12,5	90	15	72	169	133

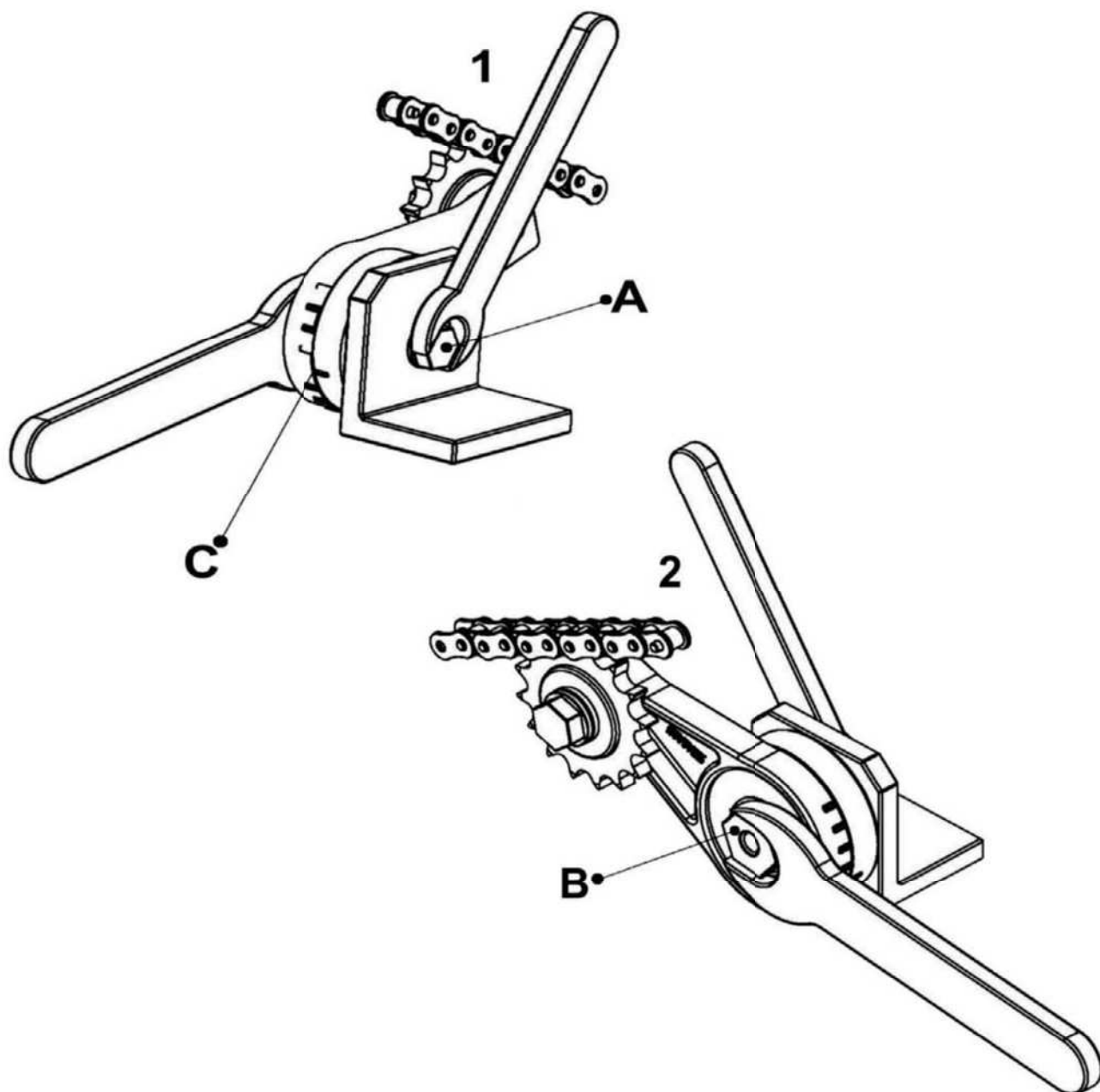

Para todos los tensores TC también aquellos con poleas o cabezas en polietileno....

Aflojar el perno A.

Hacer girar el hexágono B hasta obtener la tensión que se desea (por lo medio de marcas C)

Fijar el perno A sin desembragar el hexágono B.

Desembragar el hexágono B.

100% Alimentary
100% Alimentare
100% Alimentaire
100% Alimentar

**+
AISI 316**

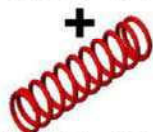

AISI 302

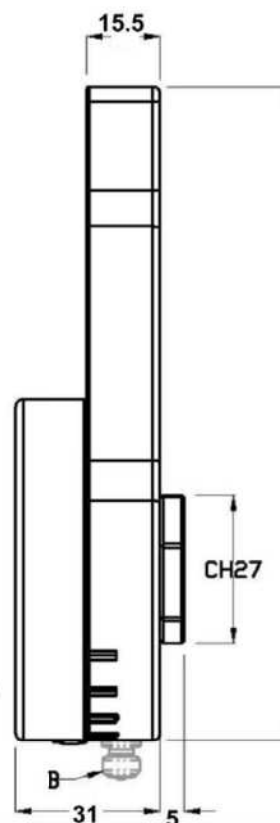
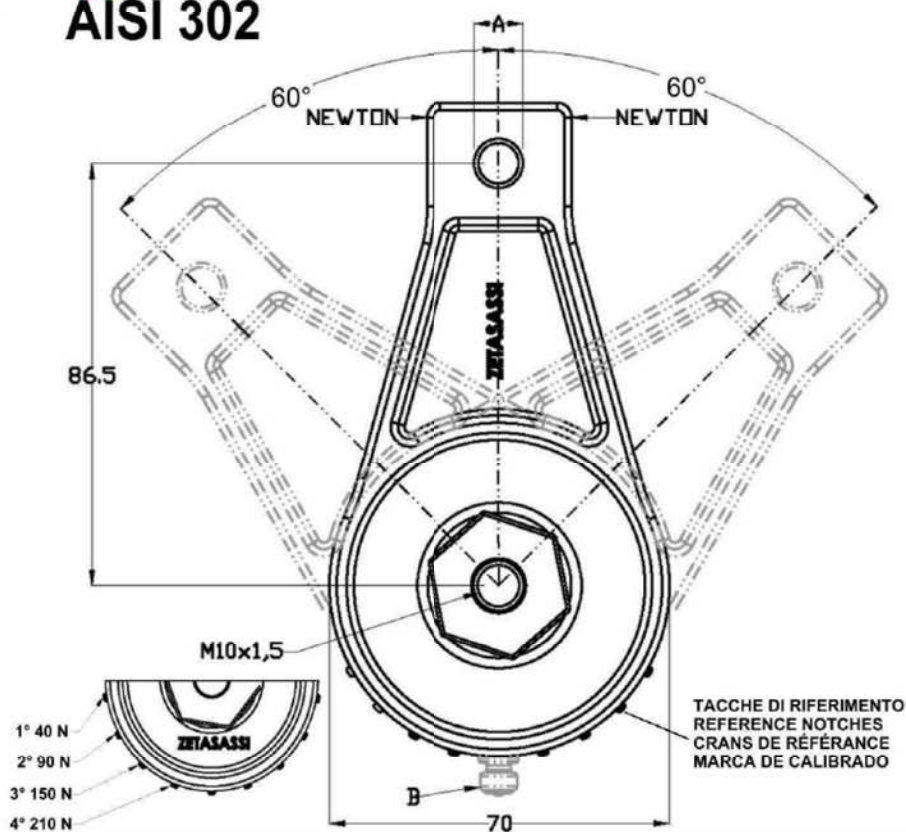
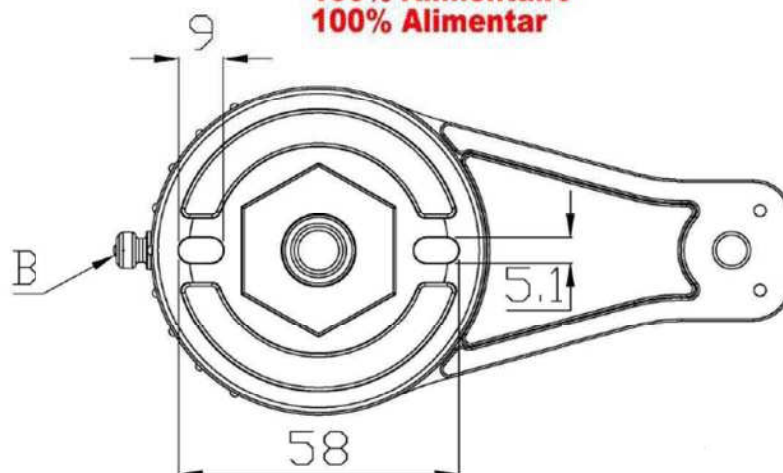

COD	NEWTON		A	Kg	B
	MIN	MAX			
TC08INOX	40	210	Ø 6,3 m/m	0,250	ENGRASADOR (B)
TC08INOX85	40	210	Ø 8,5 m/m	0,250	
TC08INOX105	40	210	Ø 10,5 m/m	0,250	
TC08INOX125	40	210	Ø 12,5 m/m	0,250	
TC08INOXM8	40	210	M8 x 1,25	0,250	
TC08INOXM10	40	210	M10 x 1,6	0,250	
TC08INOXM12	40	210	M12 x 1,76	0,250	

A

Sur la demande on peut faire des filetages différents par rapport à ceux q'on peut trouver dans notre catalogue